

INTEGRAL TEST SWITCH

INSTALLATION INSTRUCTIONS



WARNING:

- This product must be installed in accordance with the applicable installation code by a person familiar with the construction and operation of the product and the hazards involved.
- Make sure all electrical power is turned off while installing the fixture.
- This luminaire must be adequately grounded for protection against shock hazards and to assure proper operation.
- Disconnect power before servicing.
- LEDs are ESD (Electro Static Discharge) sensitive devices that can be easily damaged if the proper ESD mitigating steps are not taken.
- LEDs are very sensitive to mechanical damage. Caution must be taken to avoid damage to the LEDs.
- ESD or mechanical damage voids all warranties.
- Suitable for dry and damp locations. Top access required.

FOR USE WITH:

- 4DR
- 6DR

CONTENTS

STEP 1 MOUNTING HARDWARE	1	STEP 3 ELECTRICAL CONNECTIONS	4
STEP 2 DOWNLIGHT ASSEMBLY.....	3	STEP 4 TRIM INSTALLATION.....	5

TOOLS REQUIRED

- Ceiling cutout tool
- 3/32" allen wrench, provided

CEILING CUTOUTS

- 4 inch fixtures:
 - 5" standard flange
- 6 inch fixtures:
 - 6-1/2" standard flange

STEP 1 MOUNTING HARDWARE

A. Attach mounting hardware to fixture assembly. Note: factory installed junction box and downlight insert not shown for clarity.

Integral 2-position fixed pan bracket option

F1 (2) Universal bar hangers
mount to t-bar or nailer bar
PN 92039666

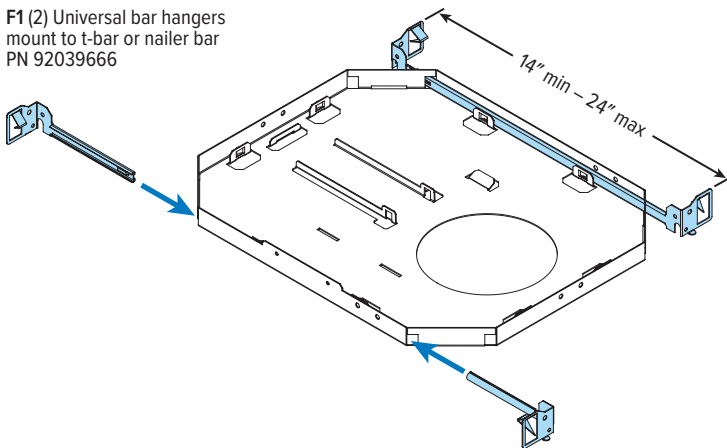

SEE NEXT PAGE FOR ADDITIONAL MOUNTING HARDWARE DETAILS

INTEGRAL TEST SWITCH

INSTALLATION INSTRUCTIONS

Adjustable caterpillar pan bracket options

CA1 Universal bar hangers mount to t-bar or nailer bar

(2) Brackets/bar hangers: PN 92036417 | (2) Bar hangers only: PN 92039666

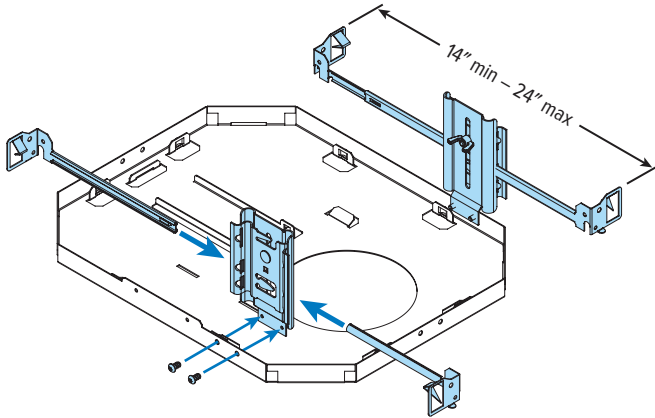

CA2 (2) T-bar clip hangers/brackets

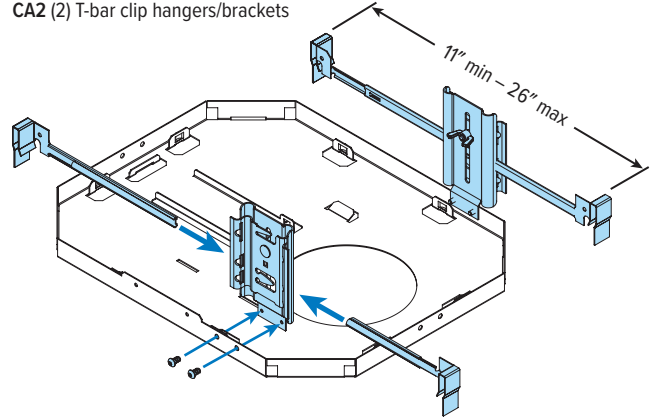

Adjustable butterfly pan bracket option

BA1 (2) Butterfly brackets only

PN 92036415

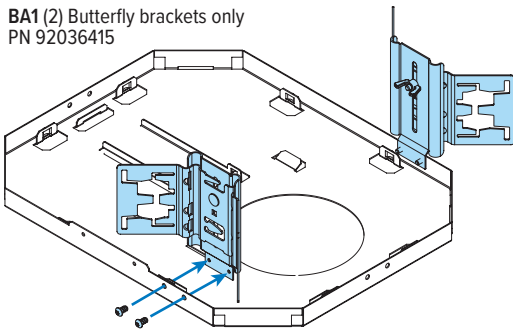

BA2 (2) Heavy-duty universal bar hangers/brackets
mount to t-bar or nailer bar | PN 92036416

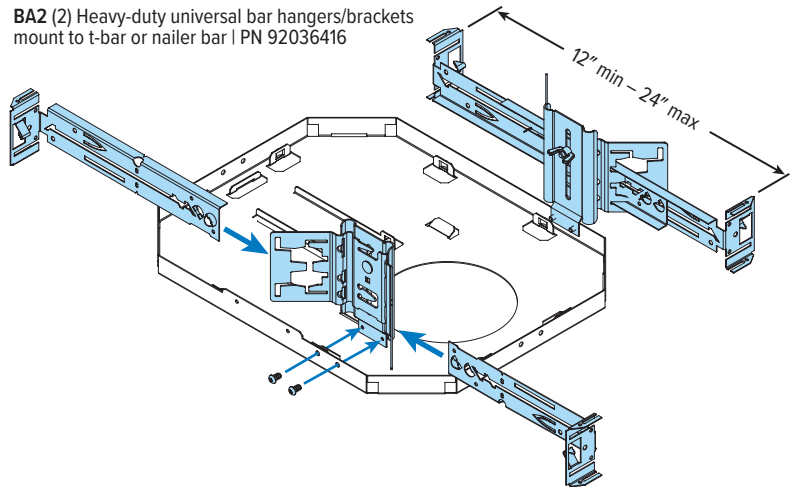

INTEGRAL TEST SWITCH

INSTALLATION INSTRUCTIONS

STEP 2 DOWNLIGHT ASSEMBLY

A. Install downlight assembly (mounting hardware not shown)

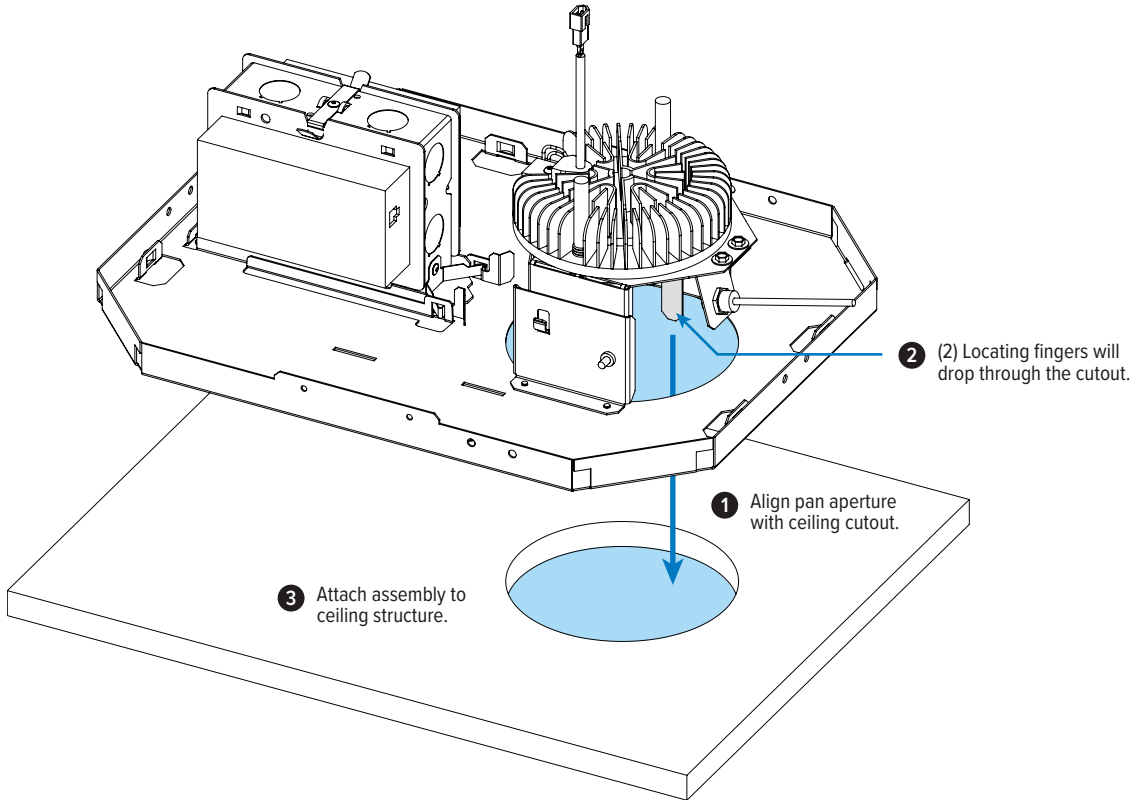

B. Adjust locating fingers

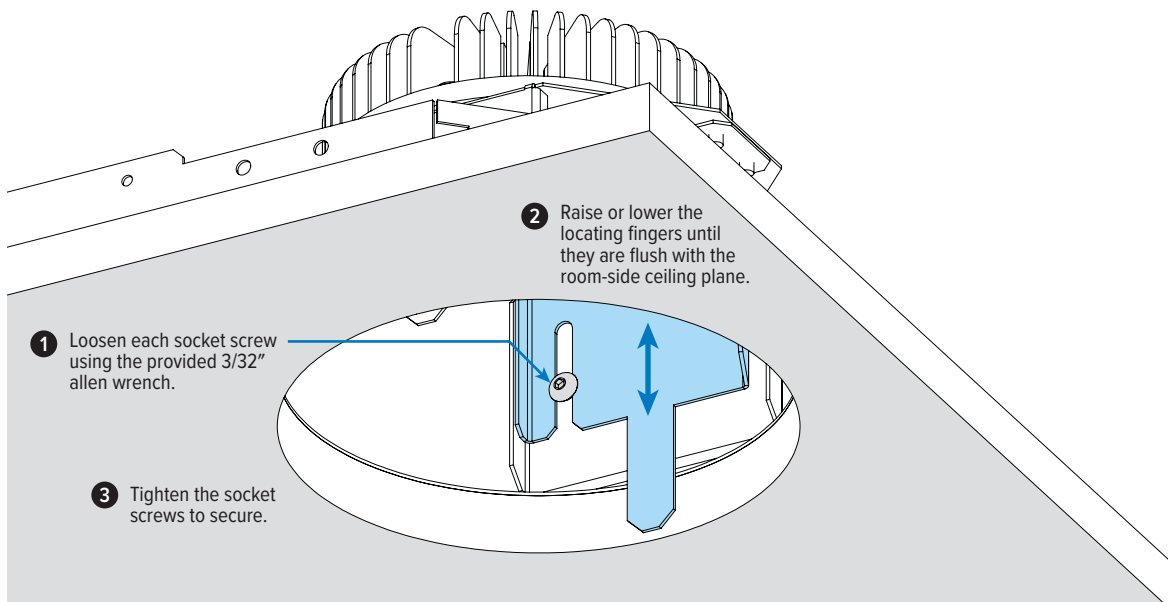

INTEGRAL TEST SWITCH

INSTALLATION INSTRUCTIONS

STEP 3 ELECTRICAL CONNECTIONS

A. Connect junction box to conduit.

1 Connect flexible conduit to j-box using side knockout as shown.

2 Open access cover.
Make all necessary lead terminations inside the j-box.
Attach power supply and ground wires using UL listed wire connectors.

3 Re-attach access cover.

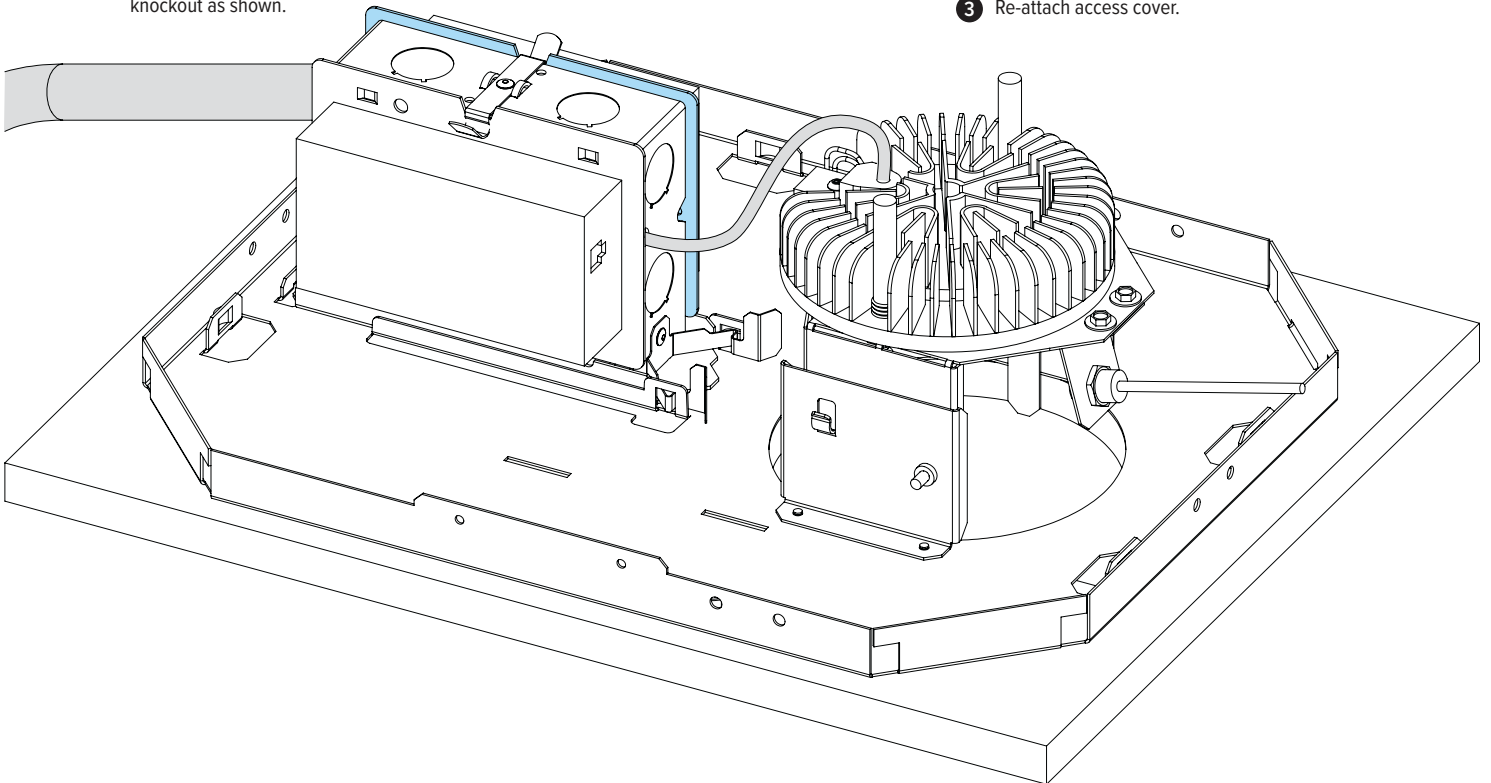

WIRING DIAGRAM

Make electrical connections in accordance with NEC and local codes.

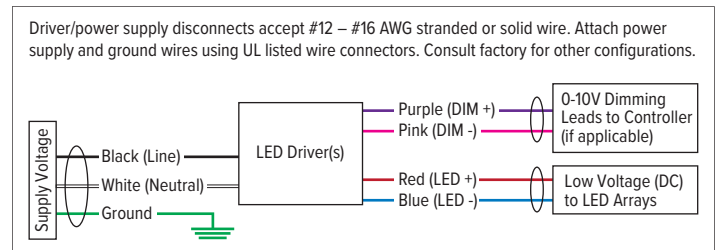
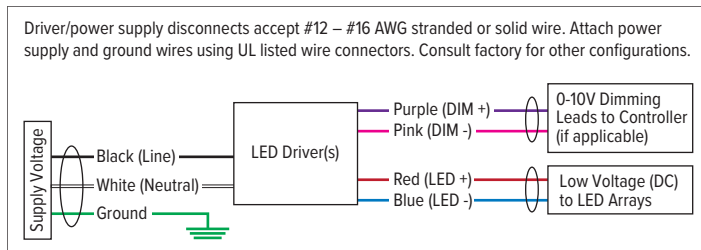

INTEGRAL TEST SWITCH

INSTALLATION INSTRUCTIONS

STEP 4 TRIM INSTALLATION

A. Align reflector

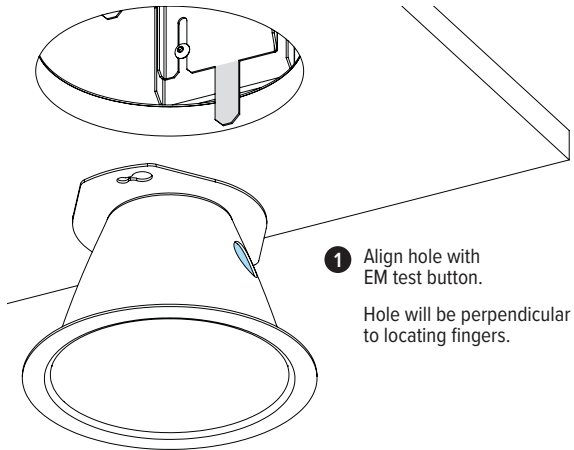

B. Install reflector

