

# OUTDOOR CYLINDERS – SURFACE

## INSTALLATION INSTRUCTIONS



### WARNING:

- This product must be installed in accordance with the applicable installation code by a person familiar with the construction and operation of the product and the hazards involved.
- Make sure all electrical power is turned off while installing the fixture.
- This luminaire must be adequately grounded for protection against shock hazards and to assure proper operation.
- Disconnect power before servicing.
- LEDs are ESD (Electro Static Discharge) sensitive devices that can be easily damaged if the proper ESD mitigating steps are not taken.
- LEDs are very sensitive to mechanical damage. Caution must be taken to avoid damage to the LEDs.
- ESD or mechanical damage voids all warranties.
- Suitable for dry and damp locations.

---

### FOR USE WITH

- W4CR
- W6CR

---

### CONTENTS

STEP 1 PREPARATION.....	2	STEP 3 MOUNTING .....	3
STEP 2 WIRING.....	3	STEP 4 W4CR FINISHING RING .....	4

---

### TOOLS REQUIRED

#### RECESSED JUNCTION BOX OPTION

- Pre-installed 4" octagonal galvanized recessed J-box, by others
- (2) 8-32 x 1-1/4" flat head screws, by others
- Silicone caulk, by others
- 5/64" hex bit, by others

#### SURFACE JUNCTION BOX OPTION

- Pre-installed 4" round surface cast alum. weatherproof J-box, by others
- (4) 10-24 x 1/2" flat head screws, by others
- Pre-installed 1/2" or 3/4" rigid metal conduit, by others
- 5/64" hex bit, by others

# OUTDOOR CYLINDERS – SURFACE

## INSTALLATION INSTRUCTIONS

### STEP 1 PREPARATION

A. Install TwistLock™ Trim Skirt

#### RECESSED J-BOX OPTION

**IMPORTANT:** Silicone caulk **MUST** be applied around the **ENTIRE** perimeter of the trim skirt, where it meets the mounting surface.

- 1 W4CR only: remove finishing ring.

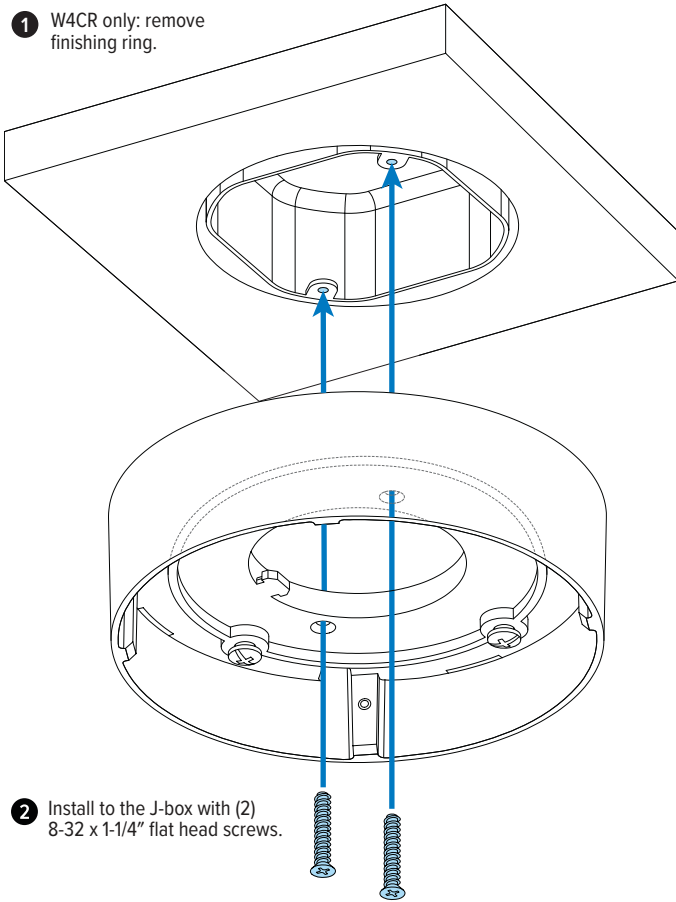

- 2 Install to the J-box with (2) 8-32 x 1-1/4" flat head screws.

- 3 Apply caulk to ALL sides

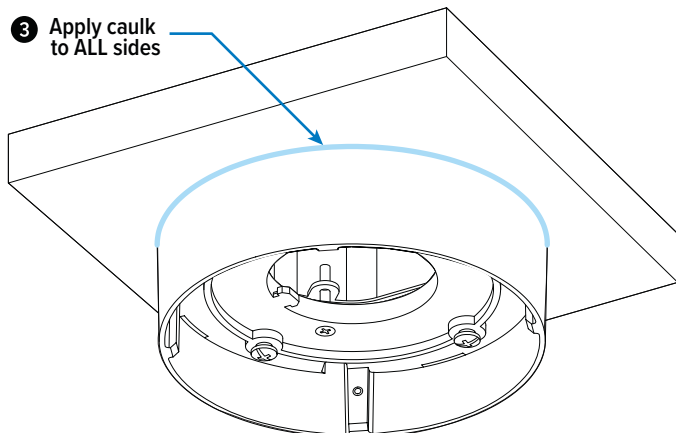

#### SURFACE J-BOX OPTION

- 1 W4CR only: remove finishing ring.

- 2 Remove appropriate conduit gate for conduit entry.

- 3 Install to the J-box with (4) 10x24 x 1/2" flat head screws.

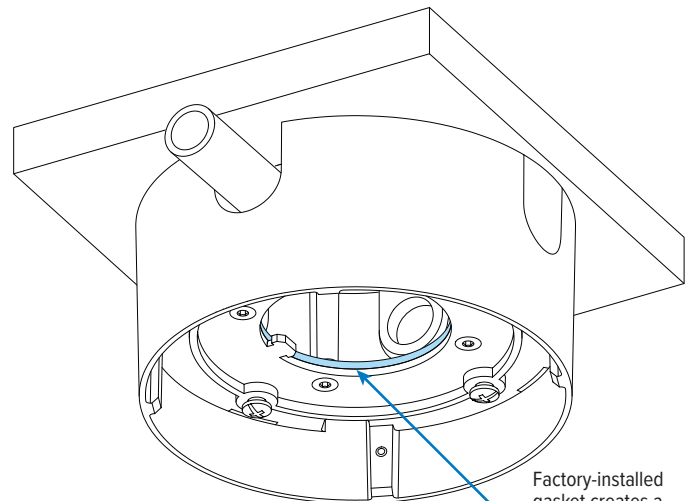
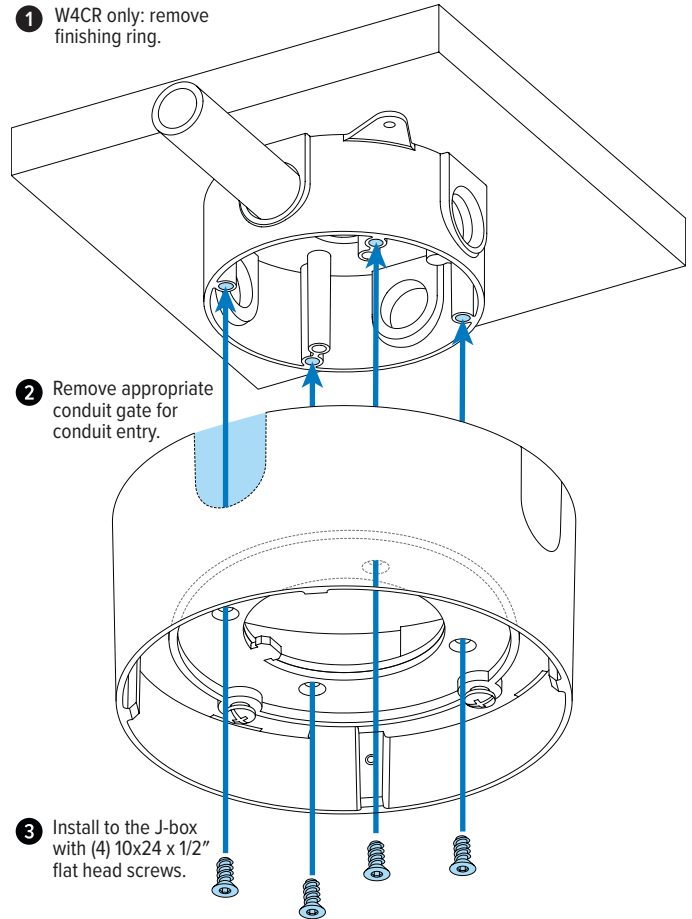

# OUTDOOR CYLINDERS – SURFACE

## INSTALLATION INSTRUCTIONS

### STEP 2 WIRING

A. Provide temporary fixture support

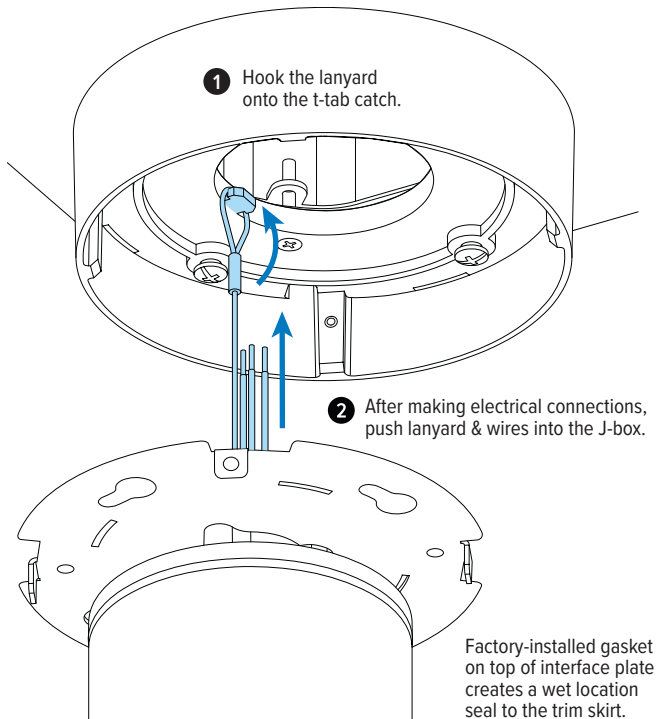

B. Make power input and dimming control electrical connections in accordance with NEC and local codes. Low-voltage lead terminations for cylinders with remote driver box.

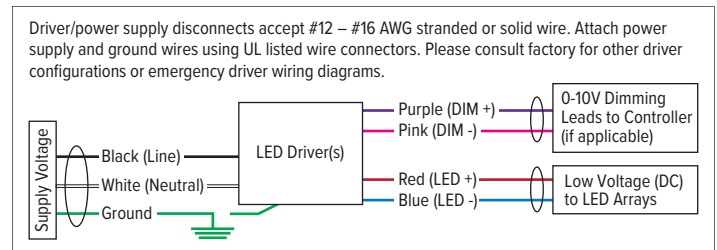

### STEP 3 MOUNTING

A. Attach cylinder to trim skirt and secure

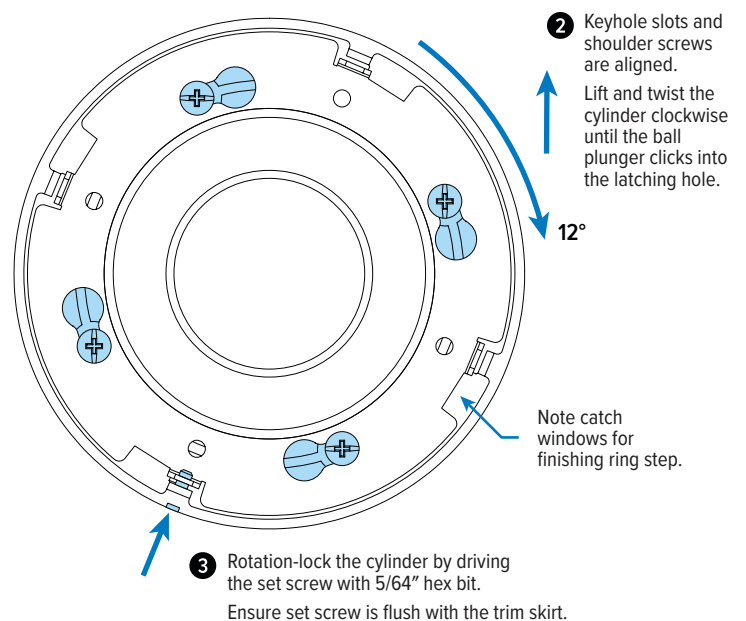
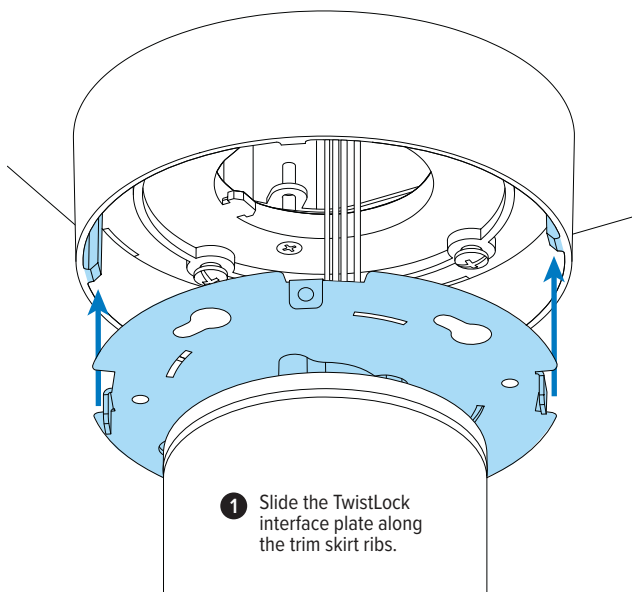

# OUTDOOR CYLINDERS – SURFACE

## INSTALLATION INSTRUCTIONS

### STEP 4 W4CR FINISHING RING

A. W4CR only: install finishing ring

