

V2DR SERIES

INSTALLATION INSTRUCTIONS



WARNING:

- This product must be installed in accordance with the applicable installation code by a person familiar with the construction and operation of the product and the hazards involved.
- Make sure all electrical power is turned off while installing the fixture.
- This luminaire must be adequately grounded for protection against shock hazards and to assure proper operation.
- Disconnect power before servicing.
- LEDs are ESD (Electro Static Discharge) sensitive devices that can be easily damaged if the proper ESD mitigating steps are not taken.
- LEDs are very sensitive to mechanical damage. Caution must be taken to avoid damage to the LEDs.
- ESD or mechanical damage voids all warranties.
- Suitable for dry and damp locations. Suitable for wet location under covered ceiling when specified with WET/CC option.

TABLE OF CONTENTS

MOUNTING HARDWARE INSTALLATION.....	1	JUNCTION BOX INSTALLATION.....	2
MOUNTING PAN INSTALLATION.....	1	DOWNLIGHT INSERT INSTALLATION.....	3
WIRING DIAGRAM.....	2	TRIM INSTALLATION.....	4

MOUNTING HARDWARE INSTALLATION

NOTE: Top access required when specified with EM battery or controls other than DIM, DIM1, DIM LINE.

STEP 1: Pre-attach the specified mounting hardware to the fixture pan. See FIG 1.1 – FIG 1.2

FIG 1.1 F1 Integral 2-position fixed pan bracket.

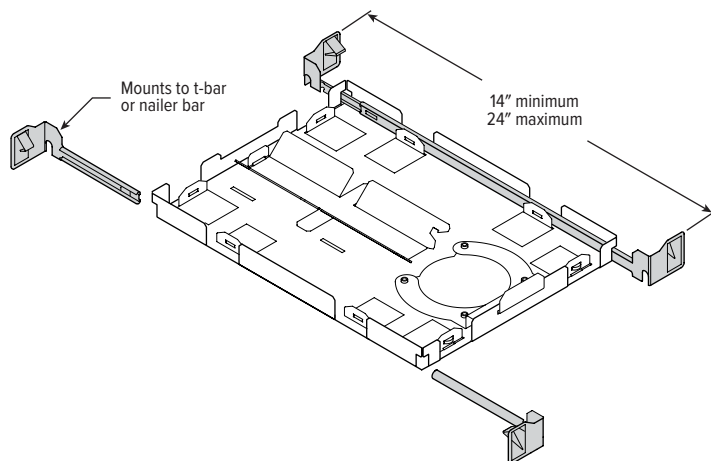
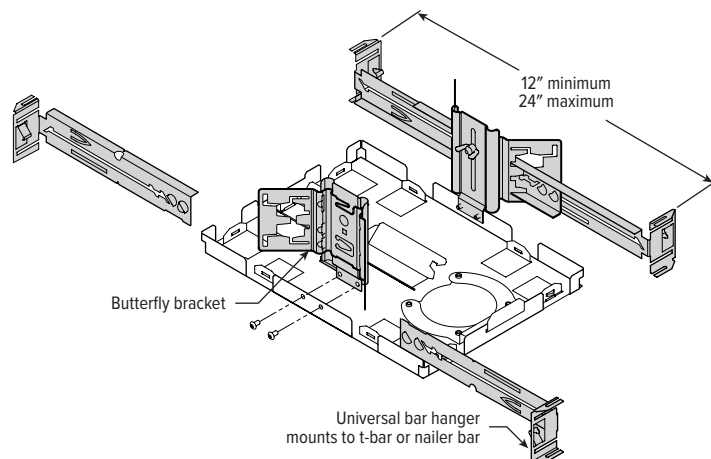

FIG 1.2 BA1 Butterfly bracket only | BA2 Heavy-duty universal bar hanger, shown



MOUNTING PAN INSTALLATION

STEP 2: Install pan assembly as required for ceiling structure while aligning the pan aperture with the ceiling cutout.

- Remove the hinge ring support (taped over the hinge ring), then lift the hinge ring to the up position.
- Wedge the cardboard hinge ring support (provided) under the hinge ring to lock it into position.

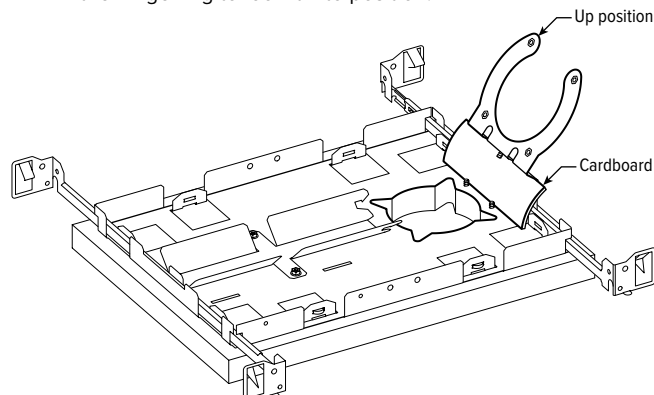

- Using the pan aperture as a guide, zip cut the ceiling substrate. Visible trim fasteners will coincide with notch locations.

FIG 2.1

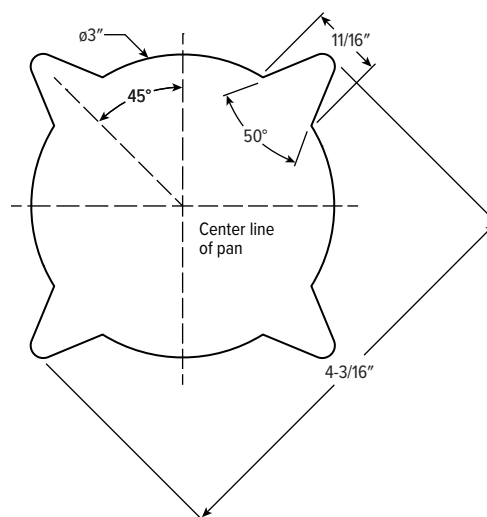

V2DR SERIES

INSTALLATION INSTRUCTIONS

WIRING DIAGRAM

FIG 2.2 Make electrical connections in accordance with NEC and local codes.

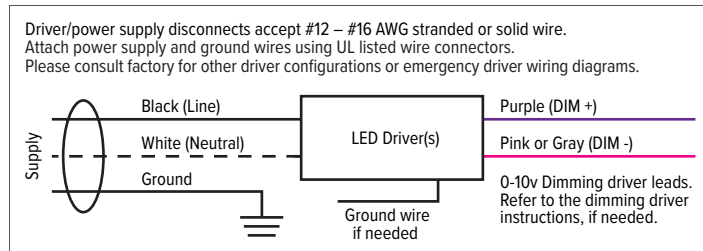

JUNCTION BOX INSTALLATION

STEP 3: Connect junction box to conduit.

- Route the flexible metal conduit containing all of the required power input and control leads to the pan location. Leave enough length for pulling at least one foot below the ceiling plane through the ceiling cutout.
- Pull the flexible conduit down through the ceiling cutout and connect the junction box.

FIG 3.1

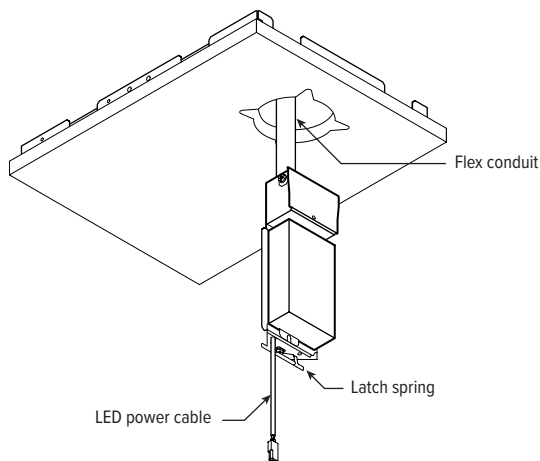

- Make all necessary lead terminations within the junction box. Attach power supply and ground wires using UL listed wire connectors. Re-attach the access cover. See **WIRING DIAGRAM**.

STEP 5: Install junction box to mounting pan.

- Maneuver the junction box up through the ceiling cutout, rotate down 90°, then slide back into the receiver bracket until the latch spring engages to lock it into the pan.
- Pull the LED power cable (not shown for clarity) down through the ceiling cutout so it is accessible for the downlight insert installation.
- Reach through the ceiling cutout and remove the hinge ring support, then lower the hinge ring to the down position.

FIG 5.1

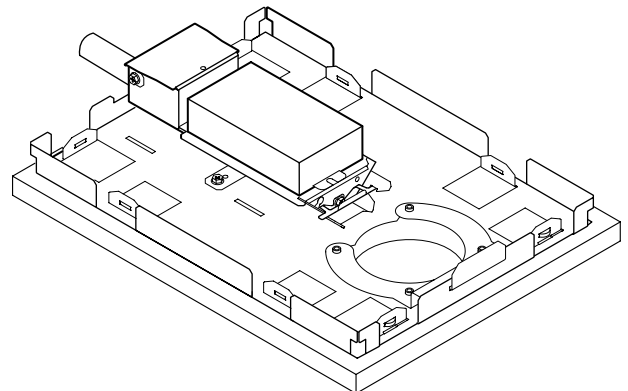

V2DR SERIES

INSTALLATION INSTRUCTIONS

DOWNLIGHT INSERT INSTALLATION

STEP 6: Connect downlight insert to power by connecting the LED power cable to the LED input cable

FIG 6.1

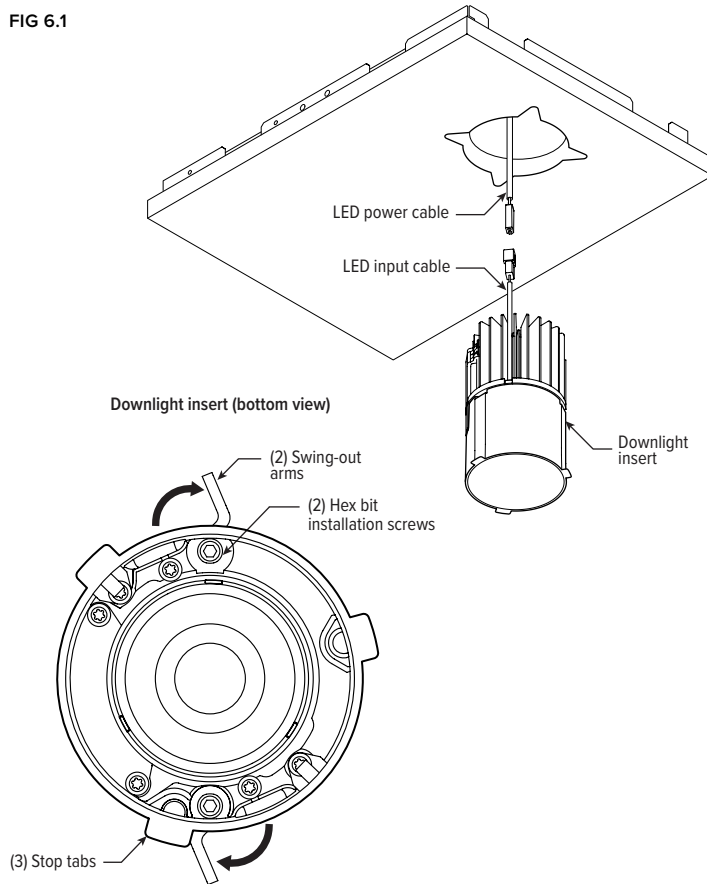

STEP 7: Install downlight insert to ceiling.

NOTE: Be sure to orient the swing-out arms perpendicular to the driver mounting tray so they land on the hinge ring.

- A.** Orient downlight insert such that ceiling stop brackets align with notches in ceiling cutout. Maneuver the downlight insert up through the ceiling cutout until the stop tabs are flush against the ceiling plane.
- B.** While continuing to support the insert, use a hex wrench to drive the installation screws - this will cause the swing-out arms to deploy, draw down, and clamp the insert in place.

FIG 7.1 Driver not shown for clarity.

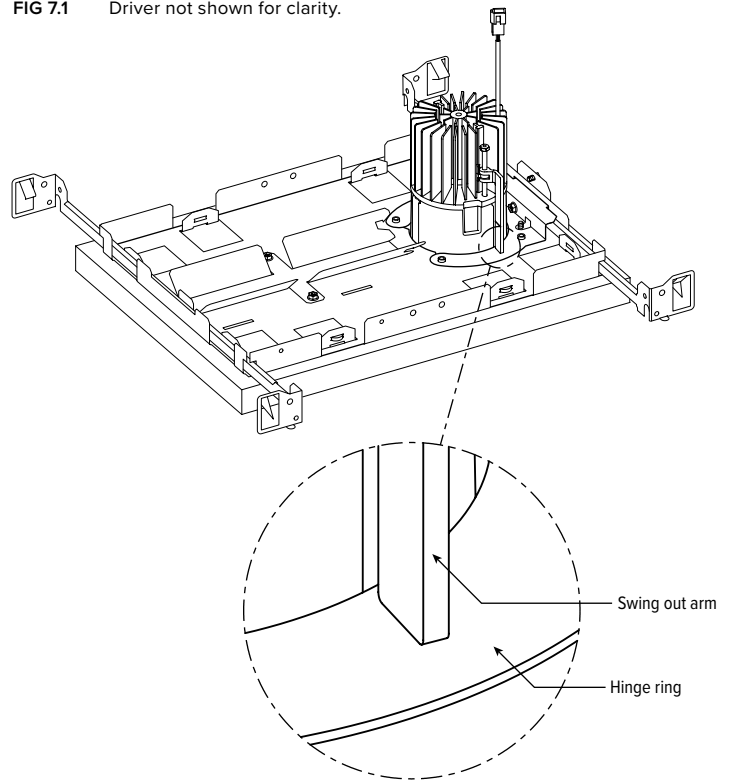

V2DR SERIES

INSTALLATION INSTRUCTIONS

TRIM INSTALLATION

STEP 8: Install trim

- A. Push trim up into downlight insert until trim flange is pressed up against the ceiling.
- B. Attach the faceplate over the bottom of the lens trim.
- C. Using a torx T15 tamper resistant bit, drive the (4) 1-1/2" long screws up into the threaded inserts in the hing ring above.

FIG 8.1

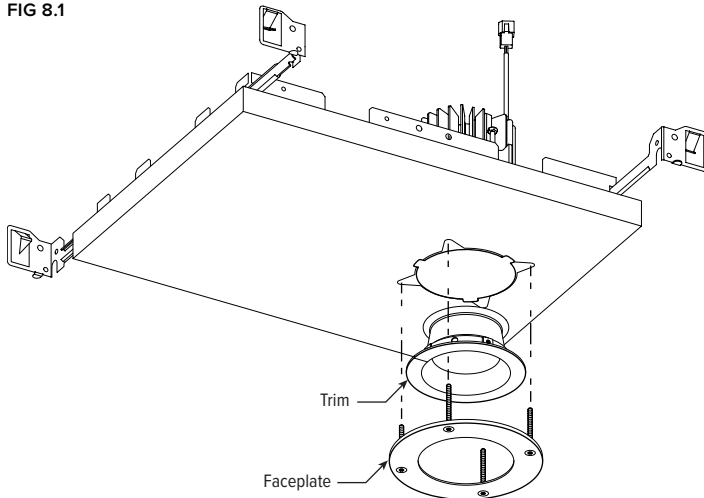

FIG 8.2

