

GASKETING OPTIONS

Fixtures must be equipped with flat aluminum door frame for gasketing options.

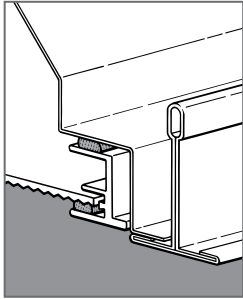

DG
Double Gasketing – Open-cell foam gasketing is factory-installed continuously between door frame and luminaire housing and between door frame and lens.

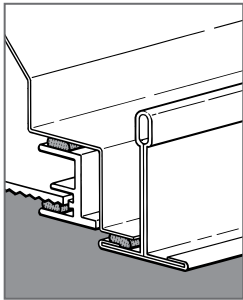

TG
Triple Gasketing – Open-cell foam gasketing is factory-installed continuously between door frame and luminaire housing, between door frame and lens, and on bottom perimeter of unit (adjacent to T-bar). NEMA Type "F" units feature gasketing attached to top surface of flange trim (adjacent to ceiling surface).

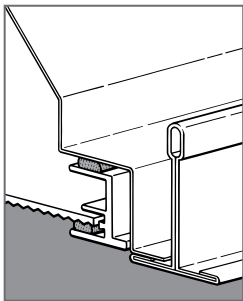

DG/CCF
Double Gasketing – Closed-cell PVC gasketing is factory-installed continuously between door frame and luminaire housing and between door frame and lens.

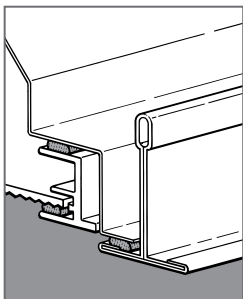

TG/CCF
Triple Gasketing – Closed-cell PVC gasketing is factory-installed continuously between door frame and luminaire housing, between door frame and lens, and on bottom perimeter of unit (adjacent to T-bar). NEMA Type "F" units feature gasketing attached to top surface of flange trim (adjacent to ceiling surface).

NEMA TYPE "G"

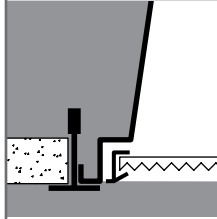

All Williams grid fixtures (NEMA Type "G") are designed to fit securely into a standard NEMA Type "G", 15/16" or 1" nominal T-bar system. Center the fixture in the opening and use earthquake clips or integral T-bar clips to secure the fixture to the ceiling structure.

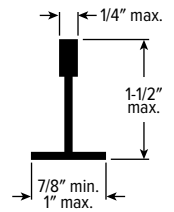

NEMA TYPE "F" (Flange installation)

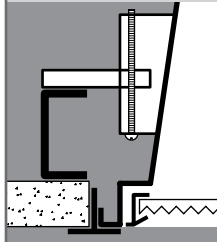

NEMA Type "F" fixtures ship with the side trims, end trims, and swing-out brackets assembled to the fixture. See specification sheets for exact dimensions of swing-out bracket vertical adjustment and ceiling cut-out.

NEMA STYLE "SS" SCREW SLOT GRID

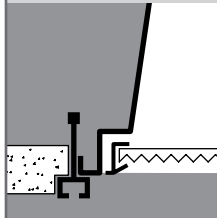

Williams screw slot grid fixtures are designed to fit NEMA Type "G" with earthquake clips for 9/16" ceilings. Center the fixture in the opening and use earthquake clips to secure the fixture to the ceiling structure. Available on specific styles of parabolic louvers and recessed architectural only.

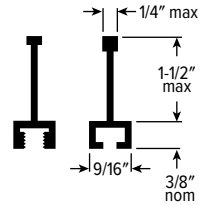

SPECIALTY CEILING TEE

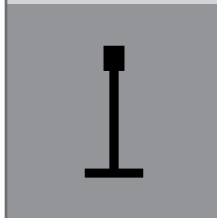

NEMA "NFG"
Narrow-Faced Grid

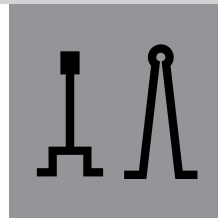

NEMA "NFGS"
Narrow-Faced Slotted Grid

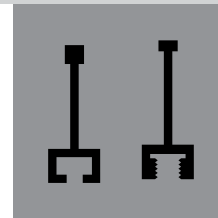

NEMA "SS"
Screw Slot Grid

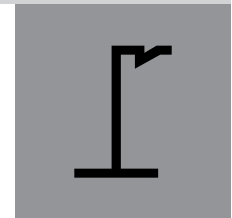

NEMA "Z"
Z Spline

Please contact the factory before ordering troffers to be fitted with specialty T-bar systems to assure proper compatibility. Dimensions and specifications are subject to change without notice.

EARTHQUAKE CLIPS

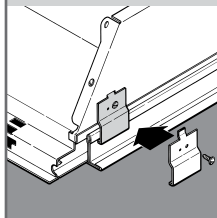

EQCLIPS Earthquake Clips – Combination earthquake and N.E.C. T-bar clip secures luminaire to T-bar and prevents T-system separation. Clips are factory-installed; four clips per fixture. Earthquake clips are provided standard when SG ceiling type is specified.