

4CSDI PoE | tunable WHITE

4" Compact Direct/Indirect Cylinder – Square

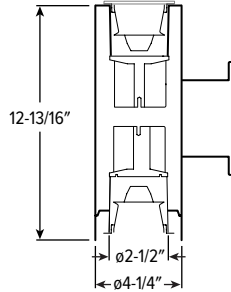

CATALOG #: _____

TYPE: _____

PROJECT: _____



FEATURES

- Deliver scalable, data-driven smart buildings with PoE-enabled fixtures and controls
- Engineered to deliver great performance in a sleek, space-saving design
- Smoothly accent walls and eliminate dark ceilings with direct and indirect lighting
- Support human-centric design with adaptive, individualized lighting using tunable white light
- Parallel the performance and style of the Williams downlight collection
- Low UGR meets LEED and WELL requirements

SPECIFICATIONS

- HOUSING** – Extruded aluminum with die-cast aluminum accent ring.
- FINISH** – Polyester powder coat bonded to phosphate-free, multi-stage pretreated metal. All parts painted after fabrication to facilitate installation, increase efficiency, and inhibit corrosion.
- OPEN REFLECTOR** – Low-iridescent anodized aluminum with top diffuser. Clear semi-specular finish standard.
- LENSED TRIM** – Die-cast aluminum frame with micro-prismatic lens (acrylic downlight, tempered glass uplight).
- ELECTRICAL** – High-performance Class 2 C.O.B. LED array. Modular quick-connect plug for easy field-connection of LED light assembly to node. Reported L70>55,000 hours. Reported L90>49,000 hours. Estimated L70 = 179,000 hours. Low-voltage DC fixture, to be fed by Class 2 power supply. Tunable White products use LEDs of multiple CCTs and may produce a perceptibly different shade of white from single-CCT products at the same CCT. All CCTs are within 3 MacAdam ellipses.
- MOUNTING** – Wall mount. Indoor applications only.
- LISTINGS** –
 - cCSAus conforms to UL STD 1598 and UL STD 8750. Certified to CAN/CSA STD C22.2 No. 250.0. Suitable for dry and damp locations.
 - Complies with the Buy American Act and other federal regulations. Request certification at hew.com/baa.
- WARRANTY** – 5-year limited warranty, see hew.com/warranty.

SYSTEM REQUIREMENTS

- PoE-ready luminaires are connected to building power systems through network integration and require other components for complete PoE lighting system
- For additional PoE info, see hew.com/poe

ORDERING EXAMPLE: 4CSDI - 13 - P12/835U/P12/835D - WHT - POE PR - LW/LM - WH - TRIM OPTIONS - WM MOUNT.

HOUSING

SERIES	HEIGHT	LUMEN PACKAGE (Example: P12/835U/P9/835D)	HOUSING FINISH ^[1]	CONTROL ^[2]
4CSDI	13 13"	Specify lumen packages: U for Uplight and D for Downlight	ALUM Silver sparkle aluminum	POE PR Power over Ethernet-ready
		LUMENS ^[3] CRI CCT U OR D	BLK Textured black	
		P5 500lm 8 80 ^[4] 27 2700K U Uplight	BRZ Textured bronze	
		P7 700lm 9 90 30 3000K D Downlight	NKL Textured nickel	
		P9 900lm 35 3500K	SLV Textured silver	
		P12 1,200lm 40 4000K	WHT Textured white	
		P15 1,500lm 50 5000K		
		P20 2,000lm TW Tunable white (90 CRI 2700K-5000K) ^[5]		

TRIM

TRIM TYPE AND DISTRIBUTION ^[6]
(Example Uplight/Downlight: LW/LM)

TRIM TYPE	DISTRIBUTION
Uplight	Uplight
L Flush lens ^[10]	W 50° Wide
	M 30° Medium
Downlight	Downlight
O Open reflector	W 50° Wide
L Flush lens	M 30° Medium
R Regressed lens	N 20° Narrow ^[11]
	S 14° Narrow spot ^[12]

REFLECTOR FINISH ^[7]

Downlight Open Trim Types

CS	Clear semi-specular anodize
SG	Satin-glow anodize
GD	Gold anodize
CG	Champagne gold anodize
PW	Pewter anodize
SPC	Clear specular anodize
RG	Rose gold anodize

TRIM OPTIONS

AD	Diffuse acrylic lens ^[8]
PD	Diffuse 1/8" polycarbonate lens ^[9]

Downlight Lens Trim Types

CS	Clear semi-specular powder coat
WH	White texture powder coat
BL	Black texture powder coat
BZ	Bronze texture powder coat
NK	Nickel texture powder coat
SV	Silver texture powder coat
AL	Silver sparkle aluminum

MOUNTING

MOUNTING TYPE ^[13]

WM Wall mount

NOTES

- See page 4 for HOUSING FINISH DETAILS.
- For additional PoE connection details, consult factory.
- Lumen output based on L Trim Type, W Distribution and WH Reflector Finish, 3500K/80 CRI for single CCT and 4000K/90 CRI for TW. Actual performance may vary +/-5%. See page 2 for FIXTURE PERFORMANCE DATA.
- Not available with Tunable White.
- Not available with S Distribution or P20 lumen package.
- Beam angle based on L Trim Type and WH Reflector Finish. Trim Type affects beam angle. See page 2 for FIXTURE PERFORMANCE DATA.
- Specified for Downlight Trim Type only. See page 4 for REFLECTOR FINISH DETAILS.
- Not available with O Trim Type. Downlight only. W Distribution only.
- Not available with O Trim Type. Downlight only. W Distribution only.
- Trim finish matches Housing Finish. Other colors available, consult factory.
- Not available with P15 lumen package when specified with Tunable White.
- Not available with P20 lumen package, Tunable White, or 950 CRI/CCT.
- See page 4 for FIXTURE DETAILS.



FIXTURE PERFORMANCE DATA

STATIC WHITE

DIST.	WATTAGE	DOWNLIGHT						UPLIGHT			
		OPEN REFLECTOR		FLUSH LENS		REGRESSED LENS		WATTAGE	FLUSH LENS		
		DELIVERED LUMENS	EFFICACY (lm/W)	DELIVERED LUMENS	EFFICACY (lm/W)	DELIVERED LUMENS	EFFICACY (lm/W)		DELIVERED LUMENS	EFFICACY (lm/W)	
P5	W	4.2	381	91	526	125	530	126	4.2	599	143
	M	4.2	361	86	528	126	520	124	4.2	601	143
	N	4.2	372	89	511	122	511	122	-	-	-
	S	5.4	435	81	607	112	609	113	-	-	-
P7	W	5.9	521	88	720	122	725	123	5.9	820	139
	M	5.9	494	84	722	122	711	121	5.9	822	139
	N	5.9	509	86	699	118	699	118	-	-	-
	S	7.6	565	74	789	104	792	104	-	-	-
P9	W	7.9	672	85	928	117	935	118	7.9	1056	134
	M	7.9	637	81	931	118	917	116	7.9	1060	134
	N	7.9	656	83	901	114	901	114	-	-	-
	S	11.1	777	70	1085	98	1089	98	-	-	-
P12	W	11.5	936	81	1292	112	1302	113	11.5	1471	128
	M	11.5	886	77	1296	113	1277	111	11.5	1475	128
	N	11.5	914	79	1254	109	1255	109	-	-	-
	S	15.3	936	61	1345	88	1349	88	-	-	-
P15	W	14.7	1160	79	1602	109	1614	110	14.7	1824	124
	M	14.7	1099	75	1607	109	1583	108	14.7	1829	124
	N	14.7	1133	77	1555	106	1556	106	-	-	-
	S	22.7	1276	56	1783	79	1789	79	-	-	-
P20	W	20.6	1523	74	2104	102	2119	103	20.6	2395	116
	M	20.6	1443	70	2110	102	2079	101	20.6	2404	117
	N	20.6	1488	72	2042	99	2043	99	-	-	-
	S	-	-	-	-	-	-	-	-	-	-

TUNABLE WHITE

DIST.	WATTAGE	DOWNLIGHT						UPLIGHT			
		OPEN REFLECTOR		FLUSH LENS		REGRESSED LENS		WATTAGE	FLUSH LENS		
		DELIVERED LUMENS	EFFICACY (lm/W)	DELIVERED LUMENS	EFFICACY (lm/W)	DELIVERED LUMENS	EFFICACY (lm/W)		DELIVERED LUMENS	EFFICACY (lm/W)	
P5	W	7.3	421	58	581	80	586	80	7.3	661	91
	M	7.3	416	57	609	83	600	82	7.3	693	95
	N	7.3	402	55	552	76	553	76	-	-	-
	S	-	-	-	-	-	-	-	-	-	-
P7	W	10.1	562	56	776	77	782	77	10.1	883	87
	M	10.1	556	55	813	80	801	79	10.1	925	92
	N	10.1	537	53	737	73	738	73	-	-	-
	S	-	-	-	-	-	-	-	-	-	-
P9	W	14.6	784	54	1083	74	1091	75	14.6	1233	84
	M	14.6	776	53	1134	78	1117	77	14.6	1291	88
	N	14.6	750	51	1029	70	1030	71	-	-	-
	S	-	-	-	-	-	-	-	-	-	-
P12	W	19.3	964	50	1332	69	1342	70	19.3	1516	79
	M	19.3	954	49	1395	72	1374	71	19.3	1588	82
	N	19.3	922	48	1265	66	1266	66	-	-	-
	S	-	-	-	-	-	-	-	-	-	-
P15	W	23.7	1080	46	1491	63	1502	63	23.7	1697	72
	M	23.7	1068	45	1562	66	1538	65	23.7	1778	75
	N	-	-	-	-	-	-	-	-	-	-
	S	-	-	-	-	-	-	-	-	-	-
P20	W	-	-	-	-	-	-	-	-	-	-
	M	-	-	-	-	-	-	-	-	-	-
	N	-	-	-	-	-	-	-	-	-	-
	S	-	-	-	-	-	-	-	-	-	-

MULTIPLIER TABLES

CCT	LUMENS	
	STANDARD	TUNABLE WHITE
	2700K	0.92
3000K	0.98	-
3500K	1.00	-
4000K	1.01	-
5000K	1.02	-

CCT	LUMENS		
	STANDARD	TUNABLE WHITE	
	2700K	0.76	0.87
	3000K	0.79	0.96
	3500K	0.82	1.02
4000K	0.84	1.00	
5000K	0.88	1.02	

CATALOG NUMBER	CONVERSION FACTOR	
	CS	1.00
SG ⁽¹⁾	0.92	
GD	0.93	
CG	0.96	
PW	0.86	
SPC	1.02	
RG	0.88	

CATALOG NUMBER	CONVERSION FACTOR		
	WH	1.00	
	CS ⁽¹⁾	0.98	
	BL ⁽¹⁾	0.79	
	BZ ⁽¹⁾	0.76	
	NK ⁽¹⁾	0.81	
	SV ⁽¹⁾	0.81	
AL ⁽¹⁾	0.86		

CATALOG NUMBER	CONVERSION FACTOR	
	AD	0.85
PD	0.85	

BEAM ANGLE

	TRIM TYPE		
	FLUSH	OPEN	REGRESSED
W	50°	50°	55°
M	30°	47°	30°
N	20°	47°	20°
S	14°	43°	14°

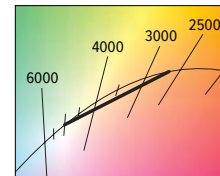

¹ Distribution will also be affected, consult factory.
 • Photometrics tested in accordance with IESNA LM-79. Results based on WH (L and R Trim Types) or CS (O Trim Type) Reflector Finish, W Distribution, static white 3500K/80 CRI or tunable white 4000K/90CRI, and 25°C ambient temperature. Actual performance may vary +/-5%.
 • Wattage is for downlight or uplight components. Add wattages together for selected lumen packages to find total fixture wattage. Wattage and efficacy data shown do not account for node losses.
 • Use multiplier tables to calculate additional options.

PHOTOMETRY CONTINUED ON NEXT PAGE.

4CSDI PoE | tunable WHITE

4" Compact Direct/Indirect Cylinder – Square

PHOTOMETRY

4CSDI-P12/835U/P12/835D-WHT-POE PR-OW/OW-CS-WM Total Luminaire Output: 2051 lumens; 23 Watts | Efficacy: 89 lm/W | 80 CRI; 3500K CCT

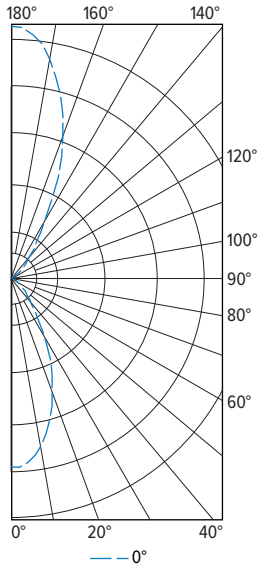

VERTICAL ANGLE	HORIZONTAL ANGLE	ZONAL LUMENS
	0°	
0	1179	
5	1152	106
15	918	254
25	572	261
35	260	170
45	120	95
55	43	44
65	1	6
75	0	0
85	0	0
90	0	
95	1	2
105	1	3
115	3	8
125	40	45
135	130	100
145	275	184
155	686	308
165	1178	322
175	1522	140
180	1563	

ZONE	LUMENS	% FIXTURE
0 - 30	621	30
0 - 40	792	39
0 - 60	931	45
0 - 90	938	46
90 - 120	13	1
90 - 150	342	17
90 - 180	1113	54
0 - 180	2051	100

OPEN

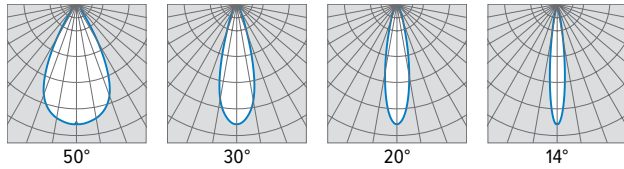

FLUSH

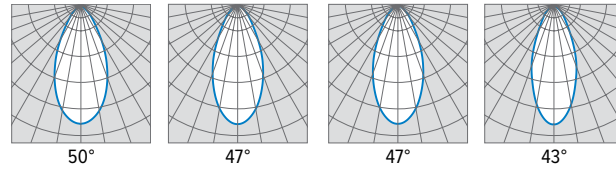

REGRESSED

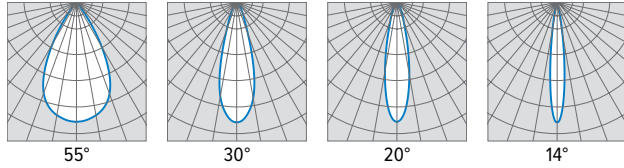

TRIM TYPE DETAILS

DOWNLIGHT

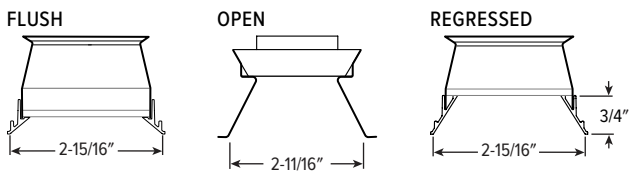

UPLIGHT

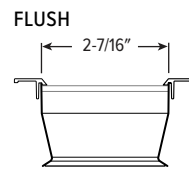

4CSDI PoE | tunable **WHITE** 4" Compact Direct/Indirect Cylinder – Square

FIXTURE DETAILS

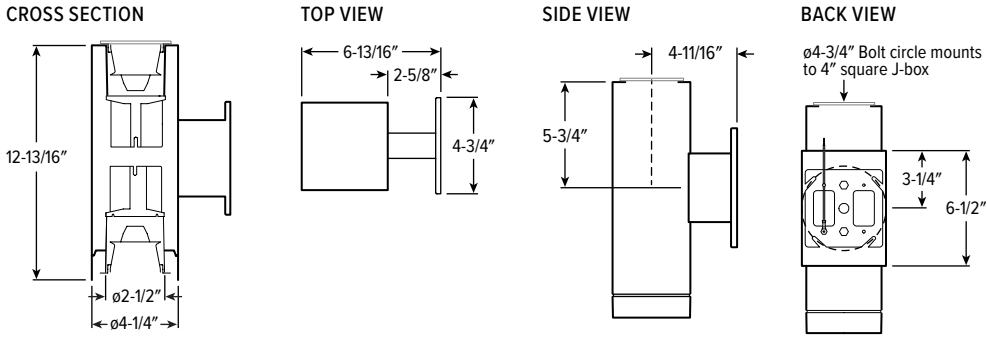

HOUSING FINISH DETAILS

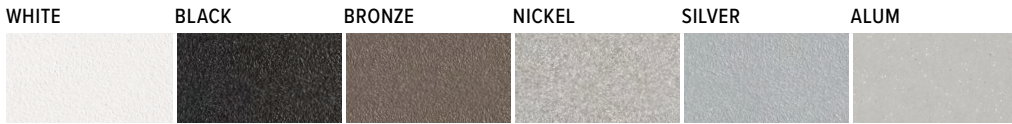

For custom color, please specify RAL code or a manufacturer code with description. All custom colors other than RAL require two sample swatches, minimum 1" square.

REFLECTOR FINISH DETAILS

