

4CSDI LED

4" Direct/Indirect Cylinder – Square

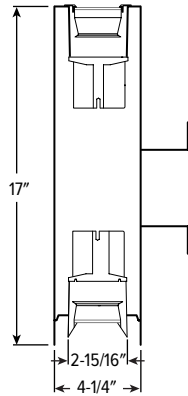

CATALOG #: _____

TYPE: _____

PROJECT: _____



ORDERING EXAMPLE: **4CSDI - 17 - L12/835U/L12/835D - OPTIONS - WHT - CONTROL/DIM - UNV - LW/LM - WH - TRIM OPTIONS - WM**
 HOUSING TRIM MOUNT.

HOUSING

SERIES	HEIGHT	LUMEN PACKAGE (Example: L12/835U/L9/835D)	OPTIONS	HOUSING FINISH ^[1]
4CSDI	17 17"	Specify lumen packages: U for Up and D for Down LUMENS ^[4] CRI CCT U OR D	EM/10WRM/RTS Remote mount 10-watt emergency battery with regressed test switch ^[2] RDB Remote mount control/driver box, galvanized steel ^[3]	ALUM Silver sparkle aluminum BLK Textured black BRZ Textured bronze NKL Textured nickel SLV Textured silver WHT Textured white
		L9 900lm 8 80 27 2700K U Uplight L12 1,200lm 9 90 30 3000K D Downlight L15 1,500lm 35 3500K L20 2,000lm 40 4000K 50 5000K		

CONTROL

See page 3 for **ADDITIONAL CONTROL/DRIVER OPTIONS**.

– None
AVI-LVFA Avi-on wireless fixture control ^[5]
AWNR Lutron Athena wireless node fixture control, RF only ^[6]

DRIVER

See page 3 for **ADDITIONAL CONTROL/DRIVER OPTIONS**.

DIM Entire fixture switches and dims together
DIM1 1% Dimming driver, 0-10V
DA Driver with 12V auxiliary power, without external dimming wires ^[7]

VOLTAGE

UNV 120-277V
347 347V ^[8]

TRIM

TRIM TYPE AND DISTRIBUTION ^[9]	REFLECTOR FINISH ^[10]	TRIM OPTIONS
(Example Uplight/Downlight: LW/LM)		
TRIM TYPE	DISTRIBUTION	
Uplight	Uplight	
L Flush lens ^[13]	W 50° Wide M 30° Medium	AD Diffuse acrylic lens ^[11] PD Diffuse 1/8" polycarbonate lens ^[12]
Downlight	Downlight	
O Open reflector L Flush lens R Regressed lens	W 50° Wide M 30° Medium N 20° Narrow S 14° Narrow spot ^[14]	

MOUNTING

MOUNTING TYPE ^[15]

WM Wall mount

NOTES

- See page 4 for HOUSING FINISH DETAILS.
- Max remote distance 50', including suspension length. Large remote box provided. EM light defaults to downlight output. Specify CEC in option code when California Energy Commission regulations are required. See page 3 for EMERGENCY BATTERY DETAILS.
- Painted driver box available, specify RDB/BLK or RDB/WHT.
- Lumen output based on L Trim Type, W Distribution and WH Reflector Finish, 80 CRI/3500K CCT. Actual performance may vary +/-5%. See page 2 for FIXTURE PERFORMANCE DATA.
- DA Driver only. Installed in remote box, must specify RDB Option. See page 5 for AVI-ON BLUETOOTH WIRELESS CONTROL DETAILS.
- DA Driver only. Installed in remote box, must specify RDB Option.
- Avi-on and Lutron Athena Controls only.
- Not available with EM batteries or DA drivers.
- Beam angle based on L Trim Type and WH Reflector Finish. Trim Type affects beam angle. See page 2 for FIXTURE PERFORMANCE DATA.
- Specified for Downlight Trim Type only. See page 4 for REFLECTOR FINISH DETAILS.
- Not available with O Trim Type. Downlight only. W Distribution only.
- Not available with O Trim Type. Downlight only. W Distribution only.
- Trim finish matches Housing Finish. Other colors available, consult factory.
- Not available with L20 lumen package or 950 CRI/CCT.
- See page 4 for FIXTURE DETAILS.



4CSDI^{LED} 4" Direct/Indirect Cylinder – Square

FEATURES

- Slim profile for unobtrusive illumination
- Smoothly accent walls and eliminate dark ceilings with direct and indirect lighting
- Parallel the performance and style of the Williams downlight collection
- Superior optical control with beams as narrow as 14° and field changeable optics as wide as 50°
- Complement the architectural elements of any space with a multitude of housing and trim finishes
- Precision-engineered extruded aluminum housing and die-cast aluminum trim face for clean aesthetic
- Low UGR meets LEED and WELL requirements
- Wireless in-fixture control solutions available
- Made Right Here® in the USA

SPECIFICATIONS

- HOUSING – Extruded aluminum with die-cast aluminum accent ring.
- FINISH – Polyester powder coat bonded to phosphate-free, multi-stage pretreated metal. All parts painted after fabrication to facilitate installation, increase efficiency, and inhibit corrosion.
- OPEN REFLECTOR – Low-iridescent aluminum with top diffuser. Clear semi-specular finish standard.
- LENSED TRIM – Die-cast aluminum frame with micro-prismatic lens (acrylic downlight, tempered glass uplight).
- ELECTRICAL – High-performance Class 2 C.O.B. LED array. Modular quick-connect plug for easy field-connection of LED light assembly to driver. Reported L70>55,000 hours. Reported L90 = 49,000 hours. Estimated L70 = 179,000 hours.
- MOUNTING – Wall mount. Indoor applications only. Max weight 6-1/4 lbs.
- LISTINGS –
 - cCSAus conforms to UL STD 1598 and UL STD 8750. Certified to CAN/CSA STD C22.2 No. 250.0. Suitable for dry and damp locations.
 - Complies with the Buy American Act and other federal regulations. Request certification at hew.com/baa.
- WARRANTY – 5-year limited warranty, see hew.com/warranty.

FIXTURE PERFORMANCE DATA

		DOWNLIGHT							UPLIGHT			
		WATTAGE	FLUSH LENS		OPEN REFLECTOR		REGRESSED LENS		WATTAGE	FLUSH LENS		
			DELIVERED LUMENS	EFFICACY (lm/W)	DELIVERED LUMENS	EFFICACY (lm/W)	DELIVERED LUMENS	EFFICACY (lm/W)		DELIVERED LUMENS	EFFICACY (lm/W)	
L9	DIST.	W	10.5	947	90	686	65	954	91	10.4	1078	104
		M	10.5	950	90	650	62	936	89	10.4	1081	104
		N	10.5	920	88	670	64	920	88	—	—	—
		S	14.1	1085	77	777	55	1089	77	—	—	—
L12		W	14.0	1292	92	936	67	1302	93	13.9	1471	106
		M	14.0	1296	93	886	63	1277	91	13.9	1475	106
		N	14.0	1254	90	914	65	1255	90	—	—	—
		S	20.4	1440	71	1031	51	1445	71	—	—	—
L15		W	17.3	1602	93	1160	67	1614	93	17.2	1824	106
		M	17.3	1607	93	1099	64	1583	92	17.2	1829	106
		N	17.3	1555	90	1133	65	1556	90	—	—	—
		S	26.7	1783	67	1276	48	1789	67	—	—	—
L20		W	23.6	2104	89	1757	74	2119	90	23.4	2395	102
		M	23.6	2110	89	1665	71	2079	88	23.4	2402	103
		N	23.6	2042	87	1717	73	2043	87	—	—	—
		S	—	—	—	—	—	—	—	—	—	—

MULTIPLIER TABLES

	COLOR TEMPERATURE	
	CCT	CONVERSION FACTOR
80 CRI	2700K	0.92
	3000K	0.98
	3500K	1.00
	4000K	1.01
	5000K	1.02

90 CRI	CCT	CONVERSION FACTOR
	2700K	0.76
	3000K	0.79
	3500K	0.82
	4000K	0.84
	5000K	0.88

TRIM OPTIONS	
CATALOG NUMBER	CONVERSION FACTOR
AD	0.85
PD	0.85

REFLECTOR FINISH	
CATALOG NUMBER	CONVERSION FACTOR
CS	1.00
SG ⁽¹⁾	0.92
GD	0.93
CG	0.96
PW	0.86
SPC	1.02
RG	0.88

R TRIM	
CATALOG NUMBER	CONVERSION FACTOR
WH	1.00
CS ⁽¹⁾	0.98
BL ⁽¹⁾	0.79
BZ ⁽¹⁾	0.76
NK ⁽¹⁾	0.81
SV ⁽¹⁾	0.81
AL ⁽¹⁾	0.86

¹ Distribution will also be affected, consult factory.

BEAM ANGLE

	TRIM TYPE		
	FLUSH	OPEN	REGRESSED
W	50°	50°	55°
M	30°	47°	30°
N	20°	47°	20°
S	14°	43°	14°

- Photometrics tested in accordance with IESNA LM-79. Results based on WH (L and R Trim Types) or CS (O Trim Type) Reflector Finish, W Distribution, 80 CRI/3500K CCT, average wattage for 120V input, and 25°C ambient temperature. Actual performance may vary +/-5%.
- Wattage is for downlight or uplight components. Add wattages together for selected lumen packages to find total fixture wattage.
- To calculate lumen output in emergency mode, multiply the battery wattage by the efficacy.
- Use multiplier tables to calculate additional options.

PHOTOMETRY

4CSDI-17-L12/835U/L12/835D-WHT-DIM1-UNV-OW/OW-CS-WM Total Luminaire Output: 2051 lumens; 28.2 Watts | Efficacy: 73 lm/W | 80 CRI; 3500K CCT

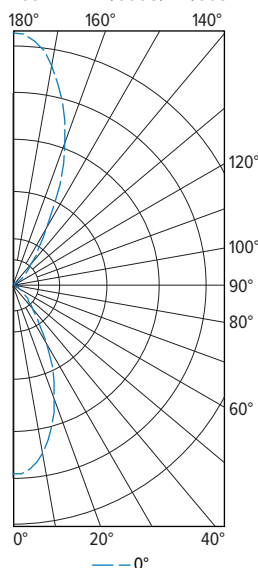

	VERTICAL ANGLE	HORIZONTAL ANGLE	ZONAL LUMENS
		0°	
CANDLEPOWER DISTRIBUTION	0	1179	
	5	1152	106
	15	918	254
	25	572	261
	35	260	170
	45	120	95
	55	43	44
	65	1	6
	75	0	0
	85	0	0
	90	0	
	95	1	2
	105	1	3
	115	3	8
	125	40	45
	135	130	100
	145	275	184
	155	686	308
	165	1178	322
	175	1522	140
	180	1563	

	ZONE	LUMENS	% FIXTURE
LUMEN SUMMARY	0 - 30	621	30
	0 - 40	792	39
	0 - 60	931	45
	0 - 90	938	46
	90 - 120	13	1
	90 - 150	342	17
	90 - 180	1113	54
	0 - 180	2051	100



4CSDI^{LED}

4" Direct/Indirect Cylinder – Square

OPEN

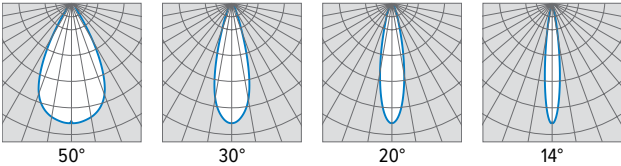

FLUSH

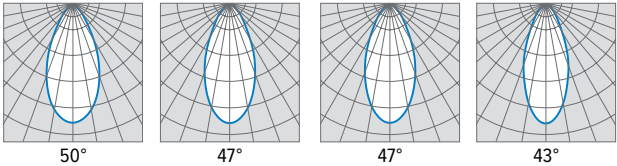

REGRESSED

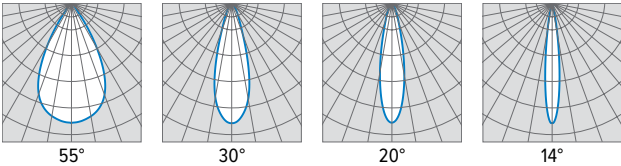

ADDITIONAL CONTROL/DRIVER OPTIONS

CONTROL/DRIVER	DESCRIPTION	RDB DETAILS BY LUMEN STOP ^[1]				
		L9	L12	L15	L20	w/EM
DIM	Dimming driver prewired for 0-10V low voltage applications; entire fixture switches and dims together	OIS	OIS	OIS	OIS	RIL
DIMU/DIMD	Dimming driver prewired for 0-10V low voltage applications; up and down portions switch and dim separately	OIS	OIS	OIS	OIS	RIL
DIM1	1% dimming driver prewired for 0-10V low voltage applications	OIS	OIS	OIS	OIS	RIL
DIM1U/DIM1D	1% dimming driver prewired for 0-10V low voltage applications; up and down portions switch separately	OIS	OIS	OIS	OIS	RIL
DIM LINE	Line voltage dimming driver (TRIAC and ELV compatible, 120V only)	OIS	OIS	OIS	OIS	RIL
DIM LINEU/DIM LINED	Line voltage switching and line voltage dimming; up and down portions switch separately	OIS	OIS	OIS	OIS	RIL
DMX	0.1% dimming driver for DMX controls	RIL	RIL	RIL	RIL	RIL
DMX/DMX	0.1% dimming driver for DMX controls; up and down portions switch separately	RIL	RIL	RIL	RIL	RIL
DALI	DALI dimming driver	RIL	RIL	RIL	RIL	RIL
DALI/DALI	DALI dimming driver; up and down portions switch separately	RIL	RIL	RIL	RIL	RIL
LDE1	Lutron Hi-lume 1% EcoSystem dimming LED driver	RIL	RIL	RIL	RIL	RIL
LDE1/LDE1	Lutron Hi-lume 1% EcoSystem dimming LED driver; up and down portions switch separately	RIL	RIL	RIL	RIL	RIL
AVI-LVFA/DA	Avi-on wireless fixture control for use with driver with 12V auxiliary power. Up and down switch together.	RIL	RIL	RIL	RIL	RIL
AVI-LVFA/DA-U/D	Avi-on wireless fixture control for use with driver with 12V auxiliary power. Up and down switch separately.	RIL	RIL	RIL	RIL	RIL
AWNDR/DA	Lutron Athena wireless node fixture control, RF only, for use with driver with 12V auxiliary power. Up and down switch together.	RIS	RIS	RIS	RIS	RIL
AWNDR/DA-U/D	Lutron Athena wireless node fixture control, RF only, for use with driver with 12V auxiliary power. Up and down switch separately.	RIS	RIS	RIS	RIS	RIL

¹ If using two different stops for U/D, see highest lumen stop for RDB.

REMOTE MOUNT DETAILS

Max remote distance is 50' including suspension. Must be room-side accessible for maintenance.

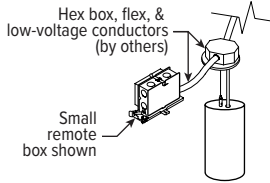

SMALL

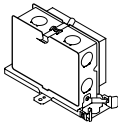

Snap-in Junction Box
6-1/2" x 3" x 4-1/2"

LARGE

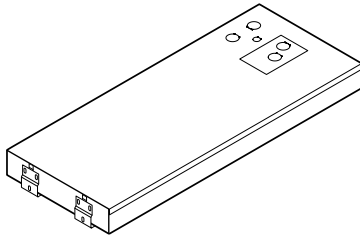

9" x 24" x 2"

REMOTE MOUNT KEY

RIS	RDB Required, Small Box
OIS	RDB Optional, Small Box
RIL	RDB Required, Large box

EMERGENCY BATTERY DETAILS

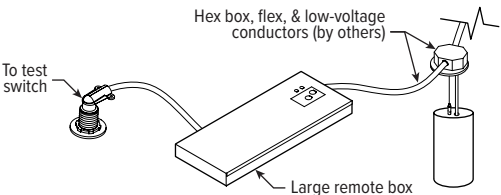

4CSDI^{LED} 4" Direct/Indirect Cylinder – Square

TRIM TYPE DETAILS

DOWNLIGHT

FLUSH

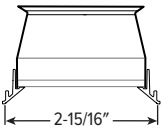

OPEN

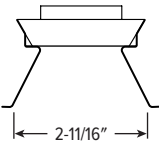

REGRESSED

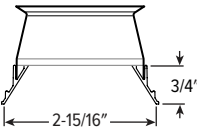

UPLIGHT

FLUSH

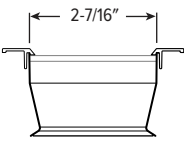

FIXTURE DETAILS

CROSS SECTION

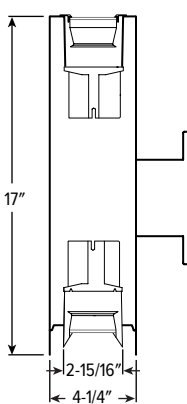

TOP VIEW

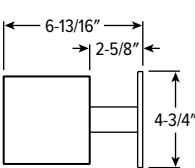

SIDE VIEW

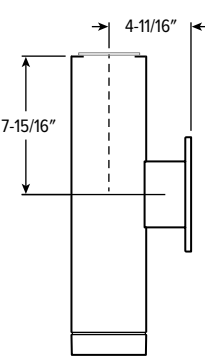

BACK VIEW

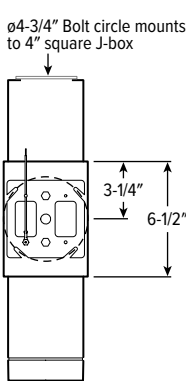

HOUSING FINISH DETAILS

WHITE

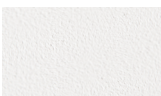

BLACK



BRONZE



NICKEL



SILVER



ALUM



For custom color, please specify RAL code or a manufacturer code with description. All custom colors other than RAL require two sample swatches, minimum 1" square.

REFLECTOR FINISH DETAILS

Smooth Finish

SPC



SG



PW



GD



CG



RG



CS



AL



Textured Finish

WH

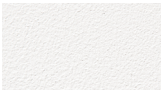

BL



BZ



NK



SV



SEE NEXT PAGE FOR CONTROL DETAILS



4CSDI

LED

4" Direct/Indirect Cylinder – Square

AVI-ON BLUETOOTH WIRELESS CONTROL DETAILS

FEATURES

Simple

- Gateway-free distributed control
- Factory pre-commissioning
- Contractor friendly installation
- Occupancy/vacancy/daylight sensing

Scalable

- Virtually unlimited network size
- Spans small offices to large warehouses
- Flexible control strategies

Secure

- Optional cloud connectivity
- UL IoT platinum security rating
- DLC 5.0 compliant

COMMISSIONING & INSTALLATION TOOLS

Avi-on mobile apps provide intuitive, quick installation and commissioning. Pro tools are available to qualified installers. Live commissioning training and on-site or remote support by Avi-on must be ordered separately through Avi-on.



Commissioning
Mobile App



Zone Scanner
Web App



Commissioning
Pro App

SYSTEM COMPONENTS

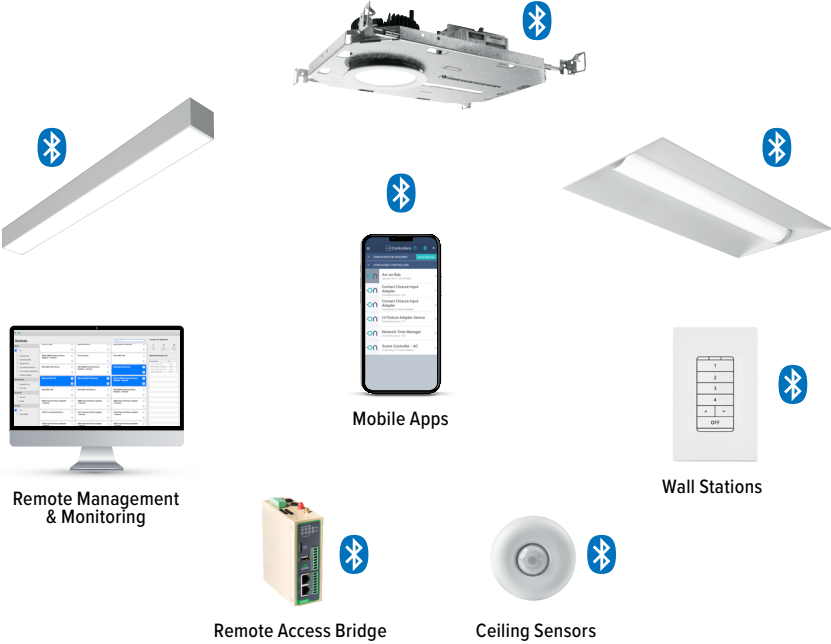

The Bluetooth® word mark and logos are registered trademarks owned by Bluetooth SIG, Inc. and any use of such marks by Avi-on is under license. Other trademarks and trade names are those of their respective owners.

ACCESSORIES

WALL STATIONS	
AVI-2401AC	Scene controller - numbered 1-4, 120-277VAC
AVI-2402BAT	Scene controller - numbered 1-4, battery powered
AVI-2401AC-2	Dimmer with presets - percentages, 120-277VAC
AVI-2402BAT-2	Dimmer with presets - percentages, battery powered
AVI-2401AC-3	On/off/dimming, 120-277VAC
AVI-2402BAT-3	On/off/dimming, battery powered

NETWORK	
AVI-RAB-LTE	Remote access bridge
AVI-KIT-NTM	Network time manager with battery backup
CEILING MOUNT SENSORS	
AVI-KIT-SEN-DUCM	PIR motion and ultrasonic sensor kit
AVI-KIT-SEN-ICM	PIR motion and photocell sensor kit

For load controllers and additional accessory info, see hew.com/avi-on

