

NEW CONSTRUCTION AND REMODEL

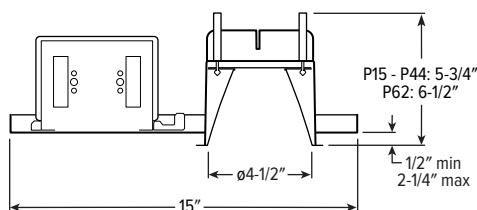

CATALOG #: _____

TYPE: _____

PROJECT: _____



TrimLock®

FEATURES

- Deliver scalable, data-driven smart buildings with PoE-enabled fixtures and controls
- Support human-centric design with adaptive, individualized lighting using tunable white light
- Made Right Here® in the USA

SPECIFICATIONS

- HOUSING** – Die-cast aluminum trim housing with forged aluminum heat sink. Galvanized steel splice compartment with driver mounting plate/enclosure. Swing-out mounting arms field adjust for ceiling thickness from 1/2" – 2-1/4".
- TRIMLOCK** – Innovative TrimLock reflector retention system ensures the trim remains flush with the ceiling plane.
- OPEN REFLECTOR** – Low-iridescent anodized aluminum. Clear semi-specular finish standard.
- LENSED TRIM** – Die-cast aluminum frame with micro-prismatic, acrylic lens.
- ELECTRICAL** – High-performance Class 2 LED array. Modular quick-connect plug for easy field-connection of LED light assembly to driver. Reported L70>50,000 hours. Low-voltage DC fixture, to be fed by Class 2 power supply. Tunable White products use LEDs of multiple CCTs and may produce a perceptibly different shade of white from single-CCT products at the same CCT. All CCTs are within 3 MacAdam ellipses.
- MOUNTING** – Recessed. 20 ga. galvanized steel mounting pan for new construction or IC-rated enclosure. Remodel kit option includes receiver bracket hardware. Minimum 24" O.C. marked spacing required for P44 and P62 lumen packages.
- LISTINGS** –
 - cCSAus conforms to UL STD 1598; Certified to CAN/CSA STD C22.2 No. 250.0 for dry and damp locations. LED light assembly conforms to UL 2108 for remote installation.
 - Suitable for wet location under covered ceiling when specified with WET/CC or TD options.
 - IC-rated for direct contact with insulation when specified with I Mounting Type.
 - City of Chicago Environmental Air approved when specified with CP option.
 - IP65 rated trim when specified with IP option.
 - Complies with ASTM-E283 when specified with ATH option.
 - RoHS compliant.
 - Complies with the Buy American Act and other federal regulations. Request certification at hew.com/baa.
- WARRANTY** – 5-year limited warranty, see hew.com/warranty.

SYSTEM REQUIREMENTS

- PoE-ready luminaires are connected to building power systems through network integration and require other components for complete PoE lighting system
- For additional PoE info, see hew.com/poe

ORDERING EXAMPLE: 4DR - TL - P28/835 - OPTIONS - POE PR - OW - OF - CS - TRIM OPTIONS - N - F1

HOUSING

SERIES	LUMENS ^[1]	CRI	CCT	OPTIONS	CONTROL ^[2]
4DR - TL	P15 1,500lm	8 80	27 2700K	SCA Sloped ceiling adaptor ^[6]	POE PR Power over Ethernet-ready
TrimLock	P28 2,800lm	9 90 ^[4]	30 3000K	ATH Airtight construction	
	P44 4,400lm		35 3500K	CP Chicago plenum (CCEA) ^[7]	
	P62 6,200lm ^[3]		40 4000K		
			50 5000K		
			TW Tunable white (80 CRI, 2700K–5000K) ^[5]		

TRIM ^[8]

TRIM TYPE	DISTRIBUTION ^[9]	FLANGE TYPE	REFLECTOR FINISH	TRIM OPTIONS
O Open reflector	W Wide	OF 1/2" standard flange	Open trim types	MWT Smooth matte white trim flange ^[17]
L Flush lens	65° Open		CS Clear semi-specular anodize	IP IP65 rated trim ^[18]
R Regressed lens	50° Flush	SF 1/4" mud-in flange ^[15]	SG Satin-glow anodize	AD Diffuse acrylic lens ^[19]
A Angled lens ^[10]	50° Regressed		GD Gold anodize	PD Diffuse 1/8" polycarbonate lens ^[20]
S Non-conductive flush lens for shower applications ^[11]	M Medium ^[12]		CG Champagne gold anodize	TD Diffuse polycarbonate lens media at top of open reflector ^[21]
	45° Open		PW Pewter anodize	
	35° Flush		SPC Clear specular anodize	
	30° Regressed		RG Rose gold anodize	
	N Narrow ^[13]		WH White texture powder coat	
	10° Open		BL Black texture powder coat	
	25° Flush			WET/CC Wet location, covered ceiling listed
	25° Regressed		Lens trim types	AM Anti-microbial ^[22]
	WW Wall wash ^[14]		CS Clear semi-specular powder coat	
			WH White texture powder coat	
			BL Black texture powder coat	
			MB Black texture splay with white flange ^[16]	

MOUNTING

MOUNTING TYPE ^[23]

- N Open pan for new construction
- I IC-rated enclosure for new construction ^[25]
- R Remodel kit ^[26]

NOTES

- Lumen output based on O Trim Type, W Distribution and CS Reflector Finish, 80 CRI, 3500K for single CCT and 4000K for TW. Actual performance may vary +/-5%, see page 2 for FIXTURE PERFORMANCE DATA
- For additional PoE connection details, consult factory.
- N Mounting Type only.
- Extended lead times may apply. Consult factory for availability. Not available with Tunable White.
- P15 and P28 lumen packages only.
- 9" aperture, specify degrees of slope in 5° increments, 05°-30°. Not available with I Mounting Type, S Trim Type, ATH, IP, or WET/CC Options. Painted white. Other colors available, consult factory. See page 3 for SLOPED CEILING ADAPTOR DETAILS.
- I Mounting Type required.
- Trim ships separately.
- Beam angle based on CS or WH Reflector Finish.

MOUNTING HARDWARE ^[24]

- F1 Integral 2-position fixed pan bracket, universal bar hanger included ^[27]
- BA1 Adjustable butterfly pan bracket, bar hanger not included ^[28]
- CA1 Adjustable caterpillar pan bracket, universal bar hanger included ^[29]

- Available with WW Distribution only.
- W Distribution, OF Flange Type and WH Reflector Finish only. Standard with AD diffuse acrylic lens. IP and WET/CC Options standard.
- Not available with lumen stops P44 and higher when specified with Flush or Regressed Trim Types.
- Not available with lumen stops P44 and higher when specified with Flush or Regressed Trim Types.
- O and A Trim Types only.
- For use with mud-in plaster construction only, supplied with mud flange installation kit. See page 3 for FLANGE TYPE DETAILS. Not available with ATH or IP Options.
- R Trim Type only. Not available with MWT.
- Not available with WH Reflector Finish, L or S Trim Types.
- L and R Trim Types only.
- Not available with O Trim Type. W and WW Distributions only.
- Not available with O Trim Type. W and WW Distributions only.
- O Trim Type only. WET/CC standard unless ordered with EM/RTS.
- WH and BL Reflector Finishes only. Not available with S Trim Type.
- Mounting hardware required (N and I only), ordered separately, see MOUNTING HARDWARE ordering info. See page 4 for MOUNTING TYPE DETAILS.
- Additional mounting hardware options available. See page 4 for MOUNTING HARDWARE DETAILS.
- P15 lumen package only. P28 available, wide distribution only for lensed trims.
- Also used in new construction sheetrock ceilings. Pan-less installation. P28 lumen package max.
- N and I Mounting Types only. I Mounting requires external brackets.
- N Mounting Type only.
- N Mounting Type only.



4DR PoE | tunable WHITE 4.5" Downlight – Round

FIXTURE PERFORMANCE DATA

STATIC WHITE

	DIST.	WATTAGE	OPEN REFLECTOR		FLUSH LENS		REGRESSED LENS	
			DELIVERED LUMENS	EFFICACY (lm/W)	DELIVERED LUMENS	EFFICACY (lm/W)	DELIVERED LUMENS	EFFICACY (lm/W)
P15	W	12.3	1537	125	1196	97	1208	98
	M	12.3	1480	120	1356	110	1361	111
	N	12.3	1426	116	1365	111	1372	112
P28	W	25.0	2835	113	2196	88	2219	89
	M	25.0	2719	109	2491	100	2499	100
	N	25.0	2619	105	2507	100	2520	101
P44	W	37.5	4408	118	3430	92	3466	92
	M	37.5	4234	113	–	–	–	–
	N	37.5	4039	108	–	–	–	–
P62	W	50.0	6151	123	4786	96	4836	97
	M	50.0	5822	116	–	–	–	–
	N	50.0	5612	112	–	–	–	–

TUNABLE WHITE

	DIST.	WATTAGE	OPEN REFLECTOR		FLUSH LENS		REGRESSED LENS	
			DELIVERED LUMENS	EFFICACY (lm/W)	DELIVERED LUMENS	EFFICACY (lm/W)	DELIVERED LUMENS	EFFICACY (lm/W)
P15	W	12.3	1311	107	1020	83	1031	84
	M	12.3	1263	103	1157	94	1161	94
	N	12.3	1216	99	1164	95	1170	95
P28	W	25.0	2649	106	2061	82	2083	83
	M	25.0	2544	102	2337	94	2345	94
	N	25.0	2427	97	2353	94	2364	95

MULTIPLIER TABLES

	COLOR TEMPERATURE		
	CCT	LUMENS	
		STANDARD	TUNABLE WHITE
80 CRI	2700K	0.92	0.83
	3000K	0.98	1.00
	3500K	1.00	0.99
	4000K	1.01	1.00
	5000K	1.02	0.98
90 CRI	2700K	0.76	–
	3000K	0.79	–
	3500K	0.82	–
	4000K	0.84	–
	5000K	0.88	–

	REFLECTOR FINISH	
	CATALOG NUMBER	CONVERSION FACTOR
	O TRIM	
O TRIM	CS	1.00
	SG ¹	0.92
	GD	0.93
	CG	0.96
	PW	0.86
	SPC	1.02
	RG	0.88
	WH ^[1]	0.89
R TRIM	BL ^[1]	0.47
	WH	1.00
	CS	0.98
	BL	0.79

TRIM	
CATALOG NUMBER	CONVERSION FACTOR
S	0.85
AD	0.85
PD	0.85
TD	0.75
WET/CC ^[2]	0.85

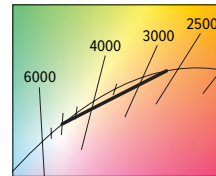

- Distribution will also be affected, consult factory.
 - Use multiplier when specified with O Trim Type.
- Photometrics tested in accordance with IESNA LM-79. Results based on O Trim Type, W Distribution and CS Reflector Finish, and 25°C ambient temperature. Static white results based on 80 CRI/3500K CCT. Tunable white results based on 80 CRI/4000K CCT. Actual performance may vary +/-5%.
 - Use multiplier tables to calculate additional options.

PHOTOMETRY

4DR-TL-P28/835-POE-PR-OW-OF-CS Total Luminaire Output: 2835 lumens; 25.0 Watts | Efficacy: 113.4 lm/W | 80 CRI; 3500K CCT

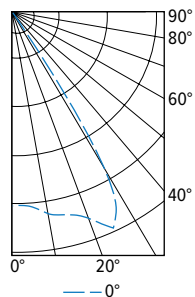

	VERTICAL ANGLE	HORIZONTAL ANGLE	ZONAL LUMENS
		0°	
CANDLEPOWER DISTRIBUTION	0	2559	
	5	2636	252
	15	2771	786
	25	3155	1460
	35	434	273
	45	62	47
	55	16	14
	65	1	2
	75	0	0
	85	0	0
	90	0	

LUMEN SUMMARY	ZONE	LUMENS	% FIXTURE
	0 - 40	2770	98
	0 - 60	2834	100
	0 - 90	2835	100
	0 - 180	2835	100

OPEN

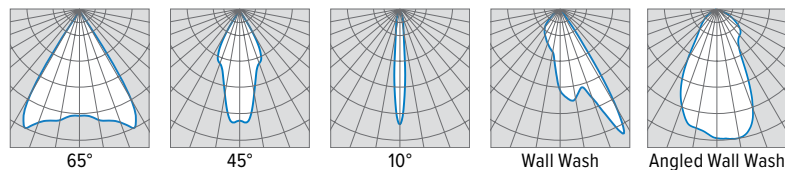

FLUSH

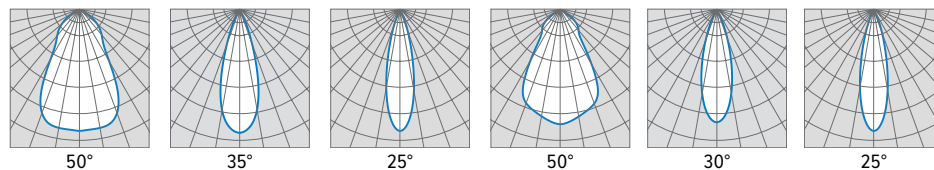

REGRESSED

4DR PoE | tunable **WHITE** 4.5" Downlight – Round

APERTURE ADAPTOR ORDERING INFO

ORDERING EXAMPLE: 4DR - GR - 0575 - WHT			
SERIES	CATALOG NUMBER	CEILING CUTOUT	FINISH
4AR 6AR 4DR 6DR 4DS 6DS 4PR 6PR 4PS 6PS 8DR	GR	Specify ceiling cutout in 1/8" increments. Example: 5.75" = 0575 See Kit Components for application limits.	CS Clear semi-specular powder coat WH White texture powder coat BL Black texture powder coat

For use with remodel downlights.

Additional finishes available, consult factory.

For limitations and instructions, see hew.com/aperture-adaptor.pdf

SLOPED CEILING ADAPTOR DETAILS

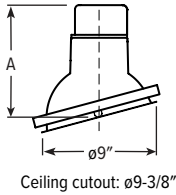

LUMENS	A (HEIGHT)						PLENUM HEIGHT
	5°	10°	15°	20°	25°	30°	
P15 - P44	8-13/16"	8-15/16"	9"	8-15/16"	8-7/8"	8-11/16"	9-1/4"
P62	9-9/16"	9-11/16"	9-11/16"	9-5/8"	9-1/2"	9-5/16"	10"

TRIMLOCK DETAILS

TWIST



PULL



RELEASE

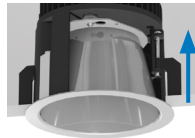

TRIM TYPE DETAILS

OPEN

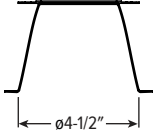

OPEN (WALL WASH)

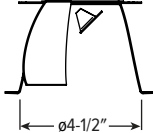

FLUSH

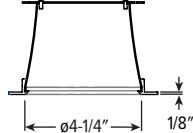

SHOWER

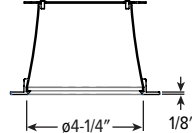

ANGLED

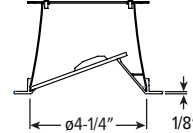

REGRESSED

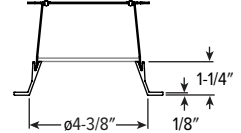

FLANGE TYPE DETAILS

1/2" STANDARD

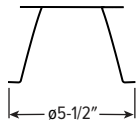

Ceiling Cutout: $\phi 5"$

1/4" MUD-IN

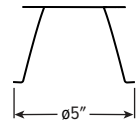

Ceiling cutout: $\phi 5\text{-}1/2"$

MUD FLANGE MOUNTING KIT (SLIM FLANGE TYPE)

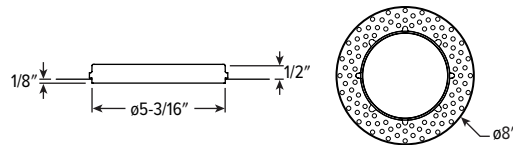

REFLECTOR FINISH DETAILS

SPC	SG	PW	GD	CG	RG	CS	WH	BL
Clear specular	Satin glow	Pewter	Gold	Champagne gold	Rose gold	Clear semi-specular	White	Black

SEE NEXT PAGE FOR MOUNTING DETAILS



4DR PoE | tunable **WHITE** 4.5" Downlight – Round

MOUNTING TYPE DETAILS

NEW CONSTRUCTION

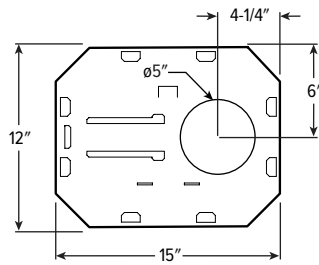

IC-RATED

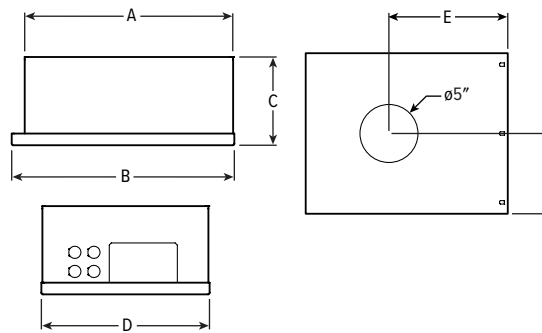

LUMENS	LENGTH					
	A	B	C	D	E	F
P15	15-3/16"	16"	6-3/8"	12-1/8"	9-1/2"	6-1/16"
P28	16-5/8"	17-1/2"	7-7/8"	14"	10-1/4"	7"

REMODEL

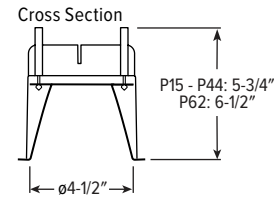

Receiver Bracket

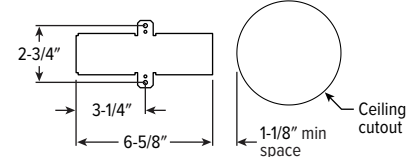

Driver and Junction Box

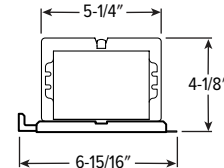

MOUNTING HARDWARE DETAILS

F1 Integral 2-position fixed pan bracket, universal bar hanger included

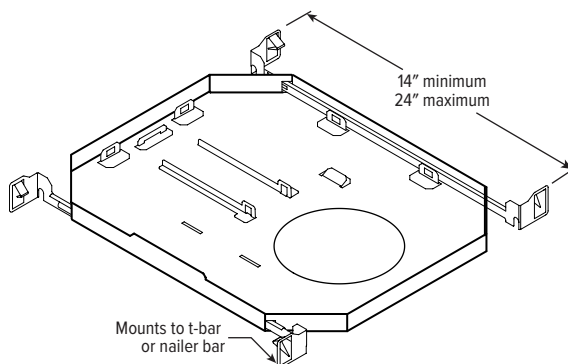

BA1 Adjustable butterfly pan bracket, bar hanger not included (N Mounting Type only)

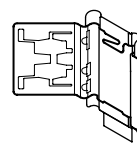

CA1 Adjustable caterpillar pan bracket, universal bar hanger included (N Mounting Type only)

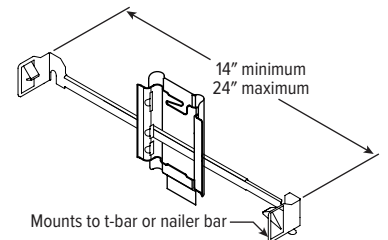

BA2 Adjustable butterfly pan bracket, heavy-duty universal bar hanger included (N Mounting Type only)

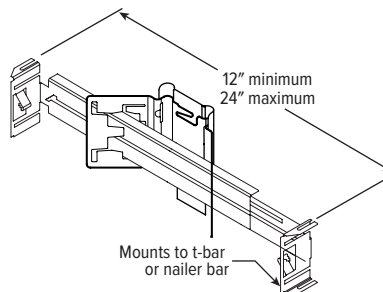

CA2 Adjustable caterpillar pan bracket, t-bar hanger included (N Mounting Type only)

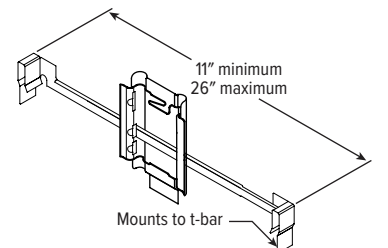

F1 with I Mounting Type

