

4DS tunable COLOR 4.5" Downlight – Square

FIXTURE PERFORMANCE DATA

OPEN REFLECTOR TRIM TYPE

	COLOR	DIST.	DELIVERED LUMENS	WATTAGE	EFFICACY (lm/W)
L11	4000K	W	1021	24.0	42.5
	RED		108	4.1	26.3
	BLUE		48	6.9	7.0
	GREEN		345	10.8	31.9
L16	4000K	W	1561	40.1	38.9
	RED		165	6.8	24.3
	BLUE		74	11.5	6.4
	GREEN		528	18.0	29.3

FLUSH LENS TRIM TYPE

	COLOR	DIST.	DELIVERED LUMENS	WATTAGE	EFFICACY (lm/W)
L11	4000K	W	1106	24.0	46.1
	RED		117	4.1	28.5
	BLUE		52	6.9	7.5
	GREEN		374	10.8	34.6
L16	4000K	W	1691	40.1	42.2
	RED		179	6.8	26.3
	BLUE		80	11.5	7.0
	GREEN		572	18.0	31.8

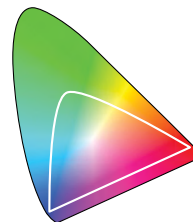

REGRESSED LENS TRIM TYPE

	COLOR	DIST.	DELIVERED LUMENS	WATTAGE	EFFICACY (lm/W)
L11	4000K	W	1062	24.0	44.3
	RED		112	4.1	27.3
	BLUE		50	6.9	7.2
	GREEN		359	10.8	33.2
L16	4000K	W	1625	40.1	40.5
	RED		172	6.8	25.3
	BLUE		77	11.5	6.7
	GREEN		549	18.0	30.5

MULTIPLIER TABLES

WHITE CONVERSION FACTOR		
CCT	LUMENS	WATTS
2000K	0.54	0.50
2700K	0.81	0.69
3000K	0.91	0.79
3500K	0.93	0.91
4000K	1.00	1.00
5000K	0.83	0.84
6000K	0.64	0.67
8000K	0.48	0.57

OPEN REFLECTOR FINISH		
CATALOG NUMBER	REFLECTOR FINISH	CONVERSION FACTOR
CS	Clear semi-specular	1.00
SG	Satin-glow	0.92
GD	Gold	0.93
CG	Champagne Gold	0.96
PW	Pewter	0.86
SPC	Specular	1.02
RG	Rose Gold	0.88

TRIM	
CATALOG NUMBER	CONVERSION FACTOR
AD	0.85
PD	0.85

- Photometrics tested in accordance with IESNA LM-79. Results shown are based on 25°C ambient temperature.
- Wattage shown is based on 120V input.
- Actual lumens may vary +/-5%
- Use multiplier tables to calculate additional options.

PHOTOMETRY

4DS-L16/9TC-DIM-120-LW-OF-WH Total Luminaire Output: 1691 lumens; 40.1 Watts | Efficacy: 42.2 lm/W | 97.6 CRI; 3905K CCT

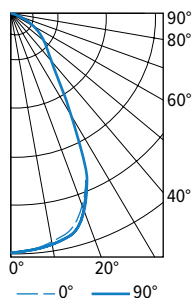

VERTICAL ANGLE	HORIZONTAL ANGLE			ZONAL LUMENS
	0°	45°	90°	
0	1258	1258	1258	
5	1246	1246	1247	118
15	1175	1192	1200	334
25	912	1033	915	434
35	413	628	405	318
45	261	283	259	213
55	158	162	157	146
65	83	81	81	84
75	35	34	35	38
85	4	3	5	7
90	0	0	0	

LUMEN SUMMARY	ZONE	LUMENS	% FIXTURE
	0 - 30	886	52
	0 - 40	1204	71
	0 - 60	1563	92
	0 - 90	1691	100
	0 - 180	1691	100



4DS tunable COLOR 4.5" Downlight – Square

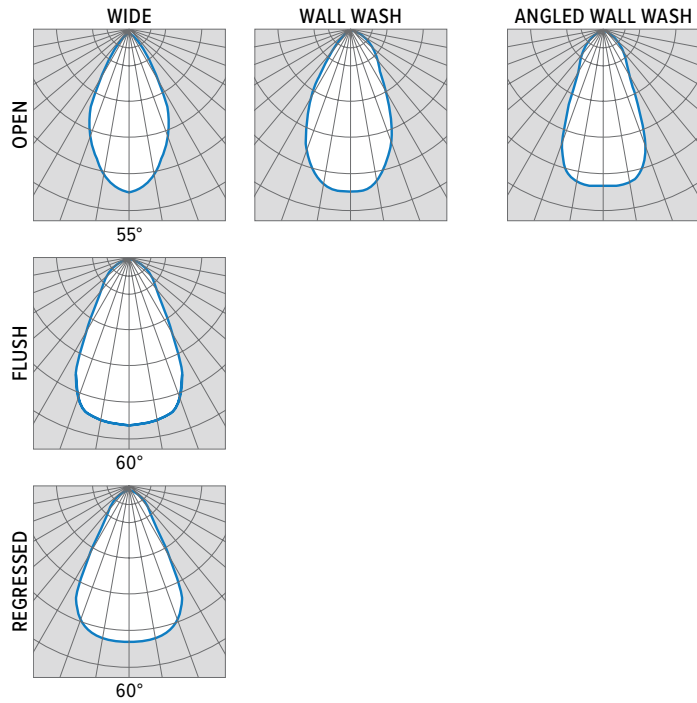

TRIM TYPE DETAILS

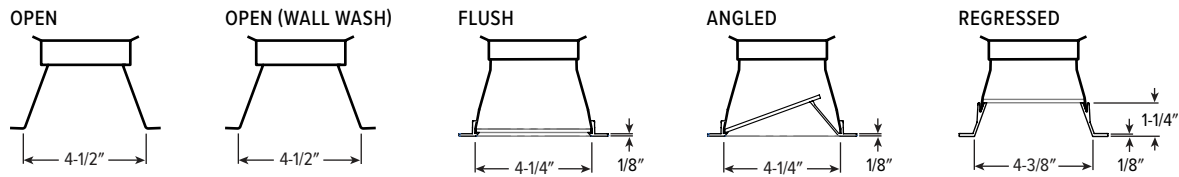

FLANGE TYPE DETAILS

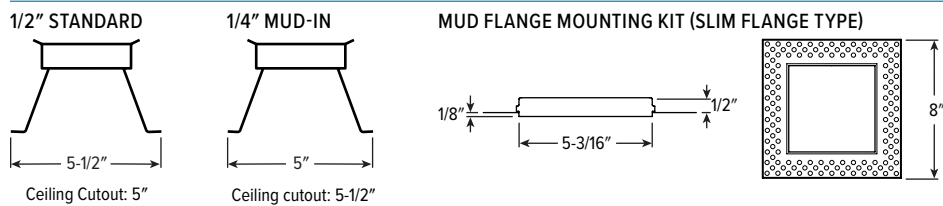

FINISH DETAILS

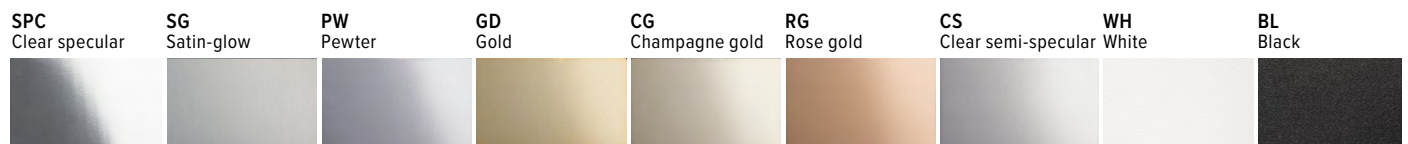

4DS tunable COLOR 4.5" Downlight – Square

CONTROL DETAILS



PROTOCOL	(1) DIMMING ^[1]	(2) CCT	(3) SATURATION	(4) HUE
0-10V DIM ^[4]	1%	1650 - 8000K	^[2]	^[2]
DALI TYPE 8	0.1%	1650 - 8000K	—	—
LUTRON ECOSYSTEM ^[3]	0.1%	1650 - 8000K	—	—
WATTSTOPPER DLM ^[3]	0.1%	1650 - 8000K	—	—
DMX512-A-RDM ^[3]	0.1%	1650 - 8000K	1 - 100%	1 - 60°

- ¹ 100 – 0.1% dimming is available when connected to 0.1% dimming capable digital controls. 100 – 1% dimming is available with analog 0 – 10V control.
- ² Two 0 – 10V lines can be used to control DIM and CCT independently, or program Scenes – in any combination of DIM, CCT, HUE and SAT – and recall them with five 0 - 10V presets.
- ³ May be limited to 1% dimming by controller; see control system specification for details.
- ⁴ 1 – 10V signal dims module to approximately 1%. In-line power relay required to achieve 0% output.

MOUNTING TYPE DETAILS

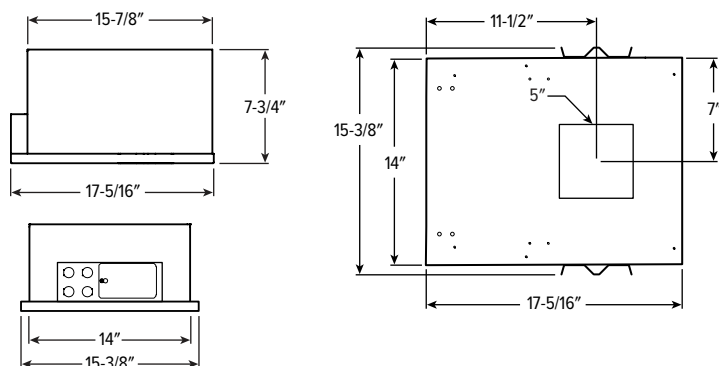

MOUNTING HARDWARE DETAILS

F1 Factory-installed 2-position fixed pan bracket, universal bar hanger included, ships uninstalled

