

# 4PR LED 4.5" Shallow Plenum Downlight – Round

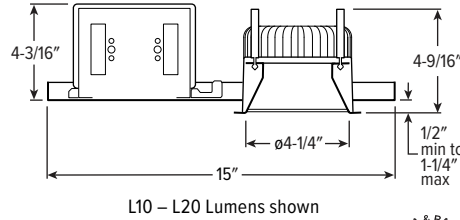
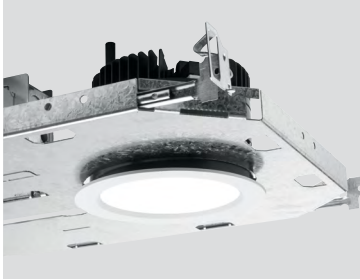

L10 – L20 Lumens shown

CATALOG #: \_\_\_\_\_

TYPE: \_\_\_\_\_

PROJECT: \_\_\_\_\_



## NEW CONSTRUCTION AND REMODEL

ORDERING EXAMPLE: **4PR - TL - L20/835 - OPTIONS - CONTROL/DIM - UNV - LW - OF - WH - TRIM OPTIONS - N - F1**

HOUSING TRIM MOUNT

### HOUSING

SERIES	LUMENS <sup>[1]</sup>	CRI	CCT	OPTIONS	CONTROL	DRIVER	VOLTAGE
4PR - TL	Single CCT or TW	8 80	27 2700K	See page 3 for EMERGENCY BATTERY OPTIONS.	Click <a href="#">HERE</a> for control options.	See page 5 for ADDITIONAL DRIVER OPTIONS.	UNV 120-277V
TrimLock	L10 1,000lm <sup>[2]</sup> L15 1,500lm	9 90 <sup>[3]</sup>	30 3000K 35 3500K 40 4000K	See page 3 for APERTURE ADAPTOR ORDERING INFO.	- None	<b>DIM</b> Dimming driver, 0-10V <b>DIM1</b> 1% Dimming driver, 0-10V <b>DIM LINE</b> Driver with line voltage dimming wires <sup>[7]</sup>	347 347V <sup>[8]</sup>
	Single CCT only		50 5000K	<b>ATH</b> Airtight construction			
	L20 2,000lm		TW Tunable white (80 CRI, 2700K-5000K)	<b>CP</b> Chicago plenum (CCEA) <sup>[4]</sup>			
	L30 3,000lm			<b>F</b> Fuse kit			
	L40 4,000lm			<b>SDT</b> Stepdown transformer <sup>[5]</sup> <b>(L__)</b> Additional lower lumen packages available. <sup>[6]</sup> Example: 3,500 lumens = 4PR-TL-L40/835-(L35)			

### TRIM<sup>[9]</sup>

TRIM TYPE	DISTRIBUTION <sup>[10]</sup>	FLANGE TYPE	REFLECTOR FINISH	TRIM OPTIONS
L Flush lens	W 65° Wide	OF 1/2" standard flange	CS Clear semi-specular powder coat	IP IP65 rated trim
A Angled lens <sup>[11]</sup>	M 35° Medium	SF 1/4" mud-in flange <sup>[13]</sup>	WH White texture powder coat	AD Diffuse acrylic lens <sup>[14]</sup>
S Non-conductive flush lens for shower applications <sup>[12]</sup>	N 25° Narrow		BL Black texture powder coat	PD Diffuse 1/8" polycarbonate lens <sup>[15]</sup> WET/CC Wet location, covered ceiling listed AM Anti-microbial <sup>[16]</sup>

### MOUNTING

#### MOUNTING TYPE<sup>[17]</sup>

- N Open pan for new construction
- I IC-rated enclosure for new construction<sup>[19]</sup>
- R Remodel kit<sup>[20]</sup>

#### MOUNTING HARDWARE<sup>[18]</sup>

- F1 Integral 2-position fixed pan bracket, universal bar hanger included<sup>[21]</sup>
- BA1 Adjustable butterfly pan bracket, bar hanger not included<sup>[22]</sup>
- CA1 Adjustable caterpillar pan bracket, universal bar hanger included<sup>[23]</sup>

### NOTES

- <sup>1</sup> Lumen output based on L Trim Type, W Distribution and WH finish, 80 CRI, 3500K for static white and 4000K for tunable white. Actual performance may vary +/-5%. See page 2 for FIXTURE PERFORMANCE DATA. Additional lumen packages available, see Options.
- <sup>2</sup> Not available with EM/10W emergency batteries.
- <sup>3</sup> Not available with tunable white.
- <sup>4</sup> I Mounting Type required.
- <sup>5</sup> May be required for 347V, see product builder at [hew.com/product-builder](http://hew.com/product-builder)
- <sup>6</sup> Specify in increments of 100 nominal lumens. Option must be specified with next higher lumen package.
- <sup>7</sup> L30 lumen package max. Not available with tunable white.
- <sup>8</sup> Not available with Tunable White, EM batteries, or DMX Driver.
- <sup>9</sup> Trim ships separately.
- <sup>10</sup> Beam angle based on WH Reflector Finish and L Trim Type.
- <sup>11</sup> W Distribution only. AD Trim Option standard.
- <sup>12</sup> W Distribution, OF Flange Type, and WH Reflector Finish only. AD, IP and WET/CC Trim Options standard.
- <sup>13</sup> For use with mud-in plaster construction only, supplied with mud flange installation kit. See page 4 for FLANGE TYPE DETAILS. Not available with ATH or IP Options.
- <sup>14</sup> L Trim Type only. W Distribution only.
- <sup>15</sup> W Distribution only.
- <sup>16</sup> WH and BL Reflector Finishes only. Not available with S Trim Type.
- <sup>17</sup> Mounting hardware required (N and I only), ordered separately, see MOUNTING HARDWARE ordering info. See page 4 for MOUNTING TYPE DETAILS.
- <sup>18</sup> Specify for N and I Mounting Types only. Additional mounting hardware options available. See page 5 for MOUNTING HARDWARE DETAILS.
- <sup>19</sup> L20 lumen package max. Not available with EM batteries.
- <sup>20</sup> Also used in new construction sheetrock ceilings. Pan-less installation.
- <sup>21</sup> N and I Mounting Types only. I Mounting requires external brackets.
- <sup>22</sup> N Mounting Type only.
- <sup>23</sup> N Mounting Type only.



# 4PR LED 4.5" Shallow Plenum Downlight – Round

## FEATURES

- Innovative TrimLock reflector retention system ensures trim remains flush with ceiling plane
- Die-cast trim with flush or angled lens provides glare-free illumination for a soft ceiling appearance
- Industry-leading efficacies as high as 100 lm/W
- Fully room-side accessible
- Slim 5 inch depth for minimal plenum space applications
- New construction mounting pan, IC-rated, or pan-less remodel kit available
- Low UGR meets LEED and WELL requirements
- Support human-centric design with adaptive, individualized lighting using tunable white light
- Wireless in-fixture control solutions available
- Beam angles ranging from 25° narrow to 65° wide for tailored performance
- Contemporary design provides glare-free illumination for a soft ceiling appearance
- Made Right Here® in the USA

## SPECIFICATIONS

- HOUSING** – Spun housing with forged aluminum heat sink. Galvanized steel splice compartment with driver mounting plate/enclosure. Mounting clips allow for ceiling thickness from 1/2" – 1-1/4" (consult factory for additional ceiling thicknesses).
- TRIMLOCK** – Innovative TrimLock reflector retention system ensures the trim remains flush with the ceiling plane.
- LENSED TRIM** – Die-cast aluminum frame with micro-prismatic, acrylic lens.
- ELECTRICAL** – High-performance Class 2 C.O.B. LED array. Modular quick-connect plug for easy field-connection of LED light assembly to driver. Reported L70>55,000 hours. Reported L90>55,000 hours. Estimated L70 = 200,000 hours. Tunable White products use LEDs of multiple CCTs and may produce a perceptibly different shade of white from single-CCT products at the same CCT. All CCTs are within 3 MacAdam ellipses.
- MOUNTING** – Recessed 20 ga. galvanized steel mounting pan for new construction or IC-rated enclosure. Remodel kit option includes receiver bracket hardware. Minimum 24" O.C. marked spacing required for L30 lumen package.
- LISTINGS** –
  - cCSAus conforms to UL STD 1598; Certified to CAN/CSA STD C22.2 No. 250.0 for dry and damp locations. LED light assembly conforms to UL 2108 for remote installation.
  - Suitable for wet location under covered ceiling when specified with WET/CC option.
  - IC-rated for direct contact with insulation when specified with I Mounting Type.
  - City of Chicago Environmental Air approved when specified with CP option.
  - IP65 rated trim when specified with IP option.
  - Complies with ASTM-E283 when specified with ATH option.
  - RoHS compliant.
  - Build America, Buy America (BABA) and Buy American Act (BAA) compliant. Request certification at Request certification at [hew.com/buy-american](http://hew.com/buy-american)
- WARRANTY** – 5-year limited warranty, see [hew.com/warranty](http://hew.com/warranty)

## FIXTURE PERFORMANCE DATA

	DISTRIBUTION	WATTAGE	FLUSH (L)	
			DELIVERED LUMENS	EFFICACY (lm/W)
L10	W	10.7	921	86
	M	10.7	1072	100
	N	10.7	1064	99
L15	W	16.7	1405	84
	M	16.7	1636	98
	N	16.7	1624	97
L20	W	22.8	1830	80
	M	22.8	2130	93
	N	22.8	2114	93
L30	W	46.6	3127	67
	M	46.6	3538	76
	N	46.6	3516	75
L40	W	41.4	4044	98
	M	41.4	4416	107
	N	41.4	4343	105

## MULTIPLIER TABLES

	COLOR TEMPERATURE		
	CCT	SINGLE CCT	TW
80 CRI	2700K	0.92	0.83
	3000K	0.98	1.00
	3500K	1.00	0.99
	4000K	1.01	1.00
	5000K	1.02	0.98

90 CRI	2700K	0.76	–
	3000K	0.79	–
	3500K	0.82	–
	4000K	0.84	–
	5000K	0.88	–

TRIM OPTIONS	
CATALOG NUMBER	CONVERSION FACTOR
S	0.85
AD	0.85
PD	0.85

## TUNABLE WHITE

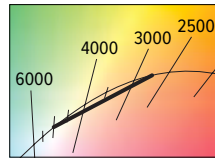

- Photometrics tested in accordance with IESNA LM-79. Results based on L trim type, W distribution and WH Reflector Finish, 80 CRI, 3500K for single CCT and 4000K for tunable white, wattage for 120V input, and 25°C ambient temperature. Actual performance may vary +/-5%.
- To calculate lumen output in emergency mode, multiply the battery wattage by the efficacy.
- Use multiplier tables to calculate additional options.
- POE PR fixtures efficacy is typically 10-12% higher than shown at same lumen level. Consult factory during project design phase for details.

## PHOTOMETRY

4PR-TL-L20/835-DIM-UNV-LW-OF-WH Report #: 12316380.29 ; 06/12/18 | Total Luminaire Output: 1830 lumens; 22.8 Watts | Efficacy: 80 lm/W | 82.7 CRI; 3565K CCT

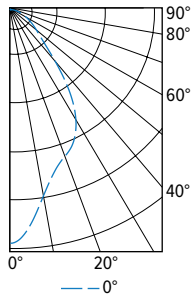

CANDLEPOWER DISTRIBUTION	VERTICAL ANGLE	HORIZONTAL ANGLE	ZONAL LUMENS
		0°	
	0	1465	
	5	1365	91
	15	1057	167
	25	926	222
	35	663	187
	45	304	10
	55	178	73
	65	104	45
	75	52	22
	85	13	4
	90	2	

LUMEN SUMMARY	ZONE	LUMENS	% FIXTURE
	0 - 40	1253	69
	0 - 60	1656	91
	0 - 90	1830	100
	0-180	1830	100

## FLUSH (L)

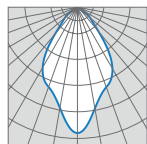

65° Wide

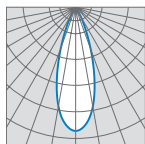

35° Medium

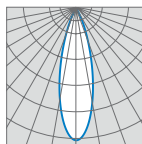

25° Narrow

## ANGLED (A)

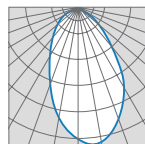

Wall Wash



# 4PR LED 4.5" Shallow Plenum Downlight – Round

## EMERGENCY BATTERY OPTIONS

Additional limitations apply, see page 1. Specify CEC in the option code when California Energy Commission regulations are required.

CATALOG NUMBER	DESCRIPTION
EM/7W	7-watt emergency battery <sup>[1]</sup>
EM/7W/RTS	7-watt emergency battery with regressed test switch <sup>[2]</sup>
EM/7W/IPRTS	7-watt emergency battery with IP65 rated regressed test switch <sup>[3]</sup>
EM/10W	10-watt emergency battery <sup>[1]</sup>
EM/10W/RTS	10-watt emergency battery with regressed test switch <sup>[2]</sup>
EM/10W/IPRTS	10-watt emergency battery with IP65 rated regressed test switch <sup>[3]</sup>

- <sup>1</sup> Not available with S Trim Type or IP Trim Option.
- <sup>2</sup> Not available with S Trim Type, IP or WET/CC Trim Options.
- <sup>3</sup> Must specify IP or WET/CC Trim Options.

## TEST SWITCH DETAILS



Regressed  
ø1-3/4"

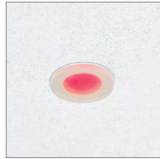

IP-Rated  
ø1-3/4"



Standard  
2-3/4" x 4-1/2"

## MOUNTING DETAILS

Max remote distance is 50', connection by others.

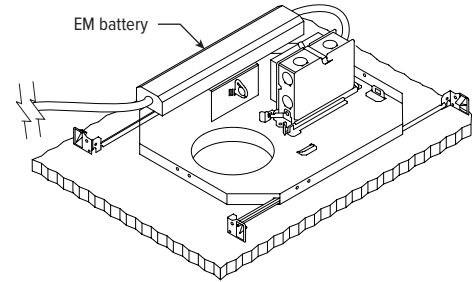
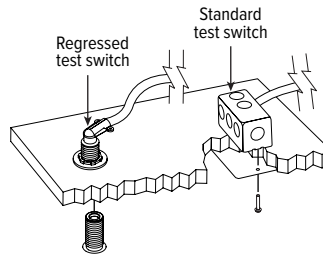

## APERTURE ADAPTOR ORDERING INFO

ORDERING EXAMPLE: 4DR - GR - 0575 - WHT					
SERIES	CATALOG NUMBER	CEILING CUTOUT	FINISH		
4AR	6AR	GR	Specify ceiling cutout in 1/8" increments. Example: 5.75" = <b>0575</b> See Kit Components for application limits.	CS	Clear semi-specular powder coat
4DR	6DR			WH	White texture powder coat
4DS	6DS			BL	Black texture powder coat
4PR	6PR				
4PS	6PS				
	8DR				

Adaptor (goof ring) corrects ceiling cutout errors during remodel downlight installation.

Additional finishes available, consult factory.

For limitations and instructions, see [hew.com/aperture-adaptor.pdf](http://hew.com/aperture-adaptor.pdf)

## CROSS SECTIONS

### L10 – L20 LUMENS

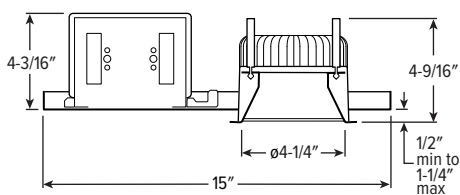

### L30 – L40 LUMENS

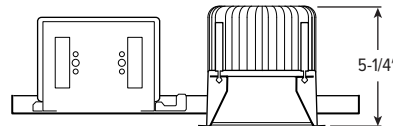

## TRIMLOCK DETAILS

### TWIST



### PULL



### RELEASE



## TRIM TYPE DETAILS

### FLUSH

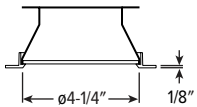

### SHOWER

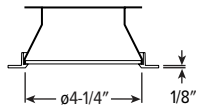

### ANGLED

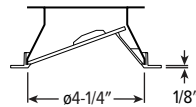

# 4PR LED

## 4.5" Shallow Plenum Downlight – Round

### FLANGE TYPE DETAILS

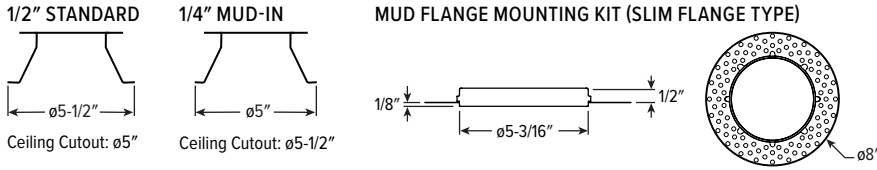

### REFLECTOR FINISH DETAILS

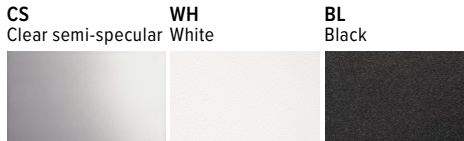

### MOUNTING TYPE DETAILS

Flex conduit is recommended for installation.

#### NEW CONSTRUCTION

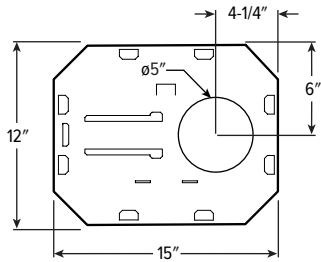

#### IC-RATED

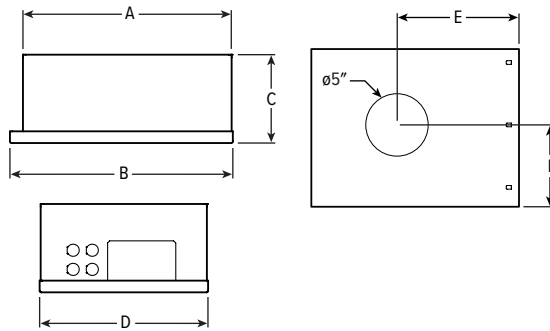

LUMENS	LENGTH					
	A	B	C	D	E	F
L10 - L20	15-1/16"	16"	4-1/2"	12-1/8"	9-1/2"	6-1/16"

#### REMODEL

H.E. Williams Inc. strongly recommends installing a trial fixture to confirm fitment on-site prior to ordering full project quantities.

#### CROSS SECTION

L10 – L20 lumens shown

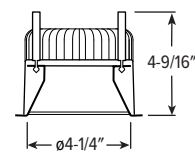

#### DRIVER & JUNCTION BOX

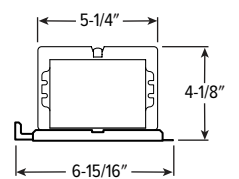

#### RECEIVER BRACKET

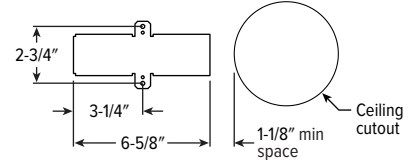

MOUNTING DETAILS CONTINUED ON NEXT PAGE.



# 4PR LED 4.5" Shallow Plenum Downlight – Round

## MOUNTING HARDWARE DETAILS

**F1** Integral 2-position fixed pan bracket, universal bar hanger included

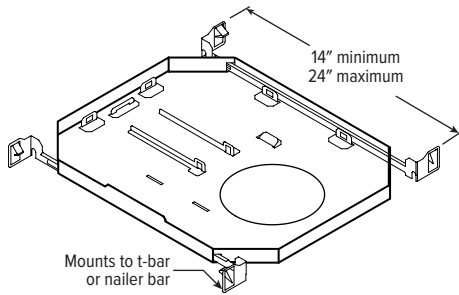

**BA1** Adjustable butterfly pan bracket, bar hanger not included (N Mounting Type only)

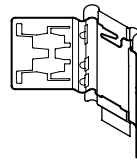

**CA1** Adjustable caterpillar pan bracket, universal bar hanger included (N Mounting Type only)

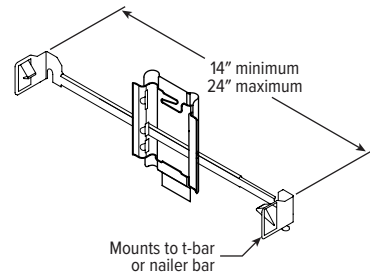

**F1 with I Mounting Type**

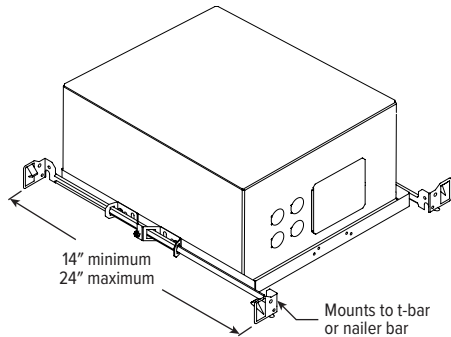

**BA2** Adjustable butterfly pan bracket, heavy-duty universal bar hanger included. (N Mounting Type only)

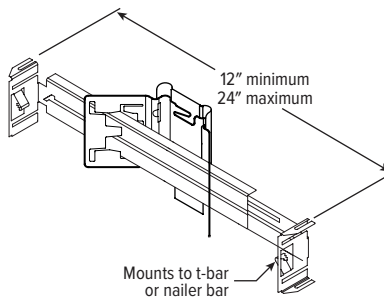

**CA2** Adjustable caterpillar pan bracket, t-bar hanger included (N Mounting Type only)

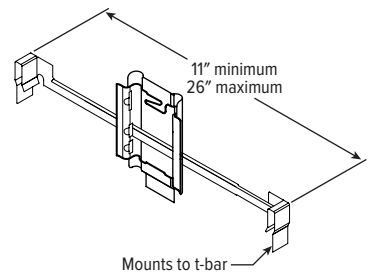

## ADDITIONAL DRIVER OPTIONS

Lumen restrictions apply: L20 max for DMX driver, L20 max for Lutron drivers, L30 max for DIM LINE driver. R mounting type requires top access with DMX driver. 347V may require stepdown transformer, see product builder at [hew.com/product-builder](http://hew.com/product-builder). I Mounting Type not available with Lutron driver.

CATALOG NUMBER	DESCRIPTION
DIM	Driver with external dimming wires prewired for 0-10V low voltage applications (tunable white: (1) 0-10V signal controls dimming and (1) 0-10V signal controls CCT)
DIM1	1% driver with external dimming wires prewired for 0-10V low voltage applications
DIM LINE <sup>[1]</sup>	Line voltage dimming driver (TRIAC and ELV compatible, 120V only)
DA	Driver with 12V auxiliary power, without external dimming wires (not available with 347V)
DALI	DALI dimming driver
DMX	Driver prewired for DMX applications
LDE1 <sup>[1]</sup>	Lutron Hi-lume 1% EcoSystem dimming driver
LD2	Lutron DALI-2 digital driver, 1%
PoE PR	Power over Ethernet-ready, fixture powered and controlled by remote UL- or CSA-listed PoE driver

<sup>1</sup> Single CCT only.

## TUNABLE WHITE DRIVER DETAILS

