

6AR PoE | tunable WHITE 6" Adjustable Downlight – Round

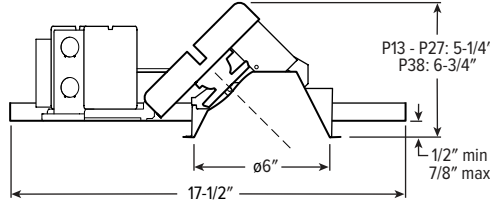

CATALOG #: _____
TYPE: _____
PROJECT: _____

NEW CONSTRUCTION AND REMODEL

FEATURES

- Create scalable, highly functioning smart buildings with Platformatics Power over Ethernet controls

SPECIFICATIONS

- HOUSING** – Die-cast aluminum spun and stamped articulating mechanism with forged aluminum heat sink. Galvanized steel splice compartment with driver mounting plate/enclosure. Mounting clips allow for ceiling thickness from 1/2" - 7/8".
- OPEN REFLECTOR** – Low-iridescent anodized aluminum. Clear semi-specular finish standard.
- LENSED TRIM** – Die-cast aluminum frame with micro-prismatic, acrylic lens.
- ELECTRICAL** – High-performance Class 2 LED array. Modular quick-connect plug for easy field-connection of LED light assembly to driver. Reported L70>50,000 hours. Low-voltage DC fixture, to be fed by Class 2 power supply. Tunable White products use LEDs of multiple CCTs and may produce a perceptibly different shade of white from single-CCT products at the same CCT. All CCTs are within 3 MacAdam ellipses.
- MOUNTING** – Recessed. 20 ga. galvanized steel mounting pan for new construction or IC-rated enclosure. Remodel kit option includes receiver bracket hardware. N and R mounting types for use in non-fire rated installations only. Minimum 24" O.C. marked spacing required for P38 lumen package.
- LISTINGS** –
 - cCSAus conforms to UL STD 1598; Certified to CAN/CSA STD C22.2 No. 250.0 for damp locations. LED light assembly conforms to UL 2108 for remote installation.
 - Suitable for wet location under covered ceiling when specified with WET/CC option.
 - IC-rated for direct contact with insulation when specified with I Mounting Type.
 - City of Chicago Environmental Air approved when specified with CP option.
 - Complies with ASTM-E283 when specified with ATH option.
 - RoHS compliant.
- WARRANTY** – 5-year limited warranty, see hew.com/warranty.

SYSTEM REQUIREMENTS

- PoE-ready luminaires are connected to building power systems through network integration and require other components for complete PoE lighting system
- For additional PoE info, see hew.com/poe
- Consult factory for design support



ORDERING EXAMPLE: 6AR - P27/835 - OPTIONS - POE PR - OW - OF - CS - TRIM OPTIONS - N - F1

HOUSING

SERIES	LUMENS ⁽¹⁾	CRI	CCT	OPTIONS	CONTROL ⁽²⁾	
6AR	P13 1,300lm	8 80	27 2700K	ATH Airtight construction ⁽⁵⁾	POE PR Power over Ethernet, Platformatics-ready	
	P27 2,700lm	9 90 ⁽⁴⁾	30 3000K	CP Chicago plenum (CCEA) ⁽⁶⁾		
	P38 3,800lm ⁽³⁾		35 3500K	40 4000K		
				50 5000K		
				TW Tunable white (80 CRI, 2700K–5000K)		

TRIM ⁽⁷⁾

TRIM TYPE	DISTRIBUTION ⁽⁸⁾	FLANGE TYPE	REFLECTOR FINISH	TRIM OPTIONS
O Open reflector	W Wide	OF 1/2" standard flange	Open trim types	MWT Textured white trim flange ⁽¹¹⁾
L Flush lens	55° Open	SF 1/4" mud-in flange ⁽¹⁰⁾	CS Clear semi-specular anodize	AD Diffuse acrylic lens ⁽¹²⁾
A Angled lens	55° Flush		WH White texture powder coat	PD Diffuse 1/8" polycarbonate lens ⁽¹³⁾
	50° Angled		BL Black texture powder coat	WET/CC Wet location, covered ceiling listed ⁽¹⁴⁾
	M Medium		Lens trim types	AM Anti-microbial ⁽¹⁵⁾
	35° Open		CS Clear semi-specular powder coat	
	35° Flush		WH White texture powder coat	
	35° Angled		BL Black texture powder coat	
	N Narrow ⁽⁹⁾			
	25° Open			
	25° Flush			
	30° Angled			

MOUNTING

MOUNTING TYPE ⁽¹⁶⁾

- N Open pan for new construction
- I IC-rated enclosure for new construction ⁽¹⁸⁾
- R Remodel kit ⁽¹⁹⁾

MOUNTING HARDWARE ⁽¹⁷⁾

- F1 Factory-installed 2-position fixed pan bracket, universal bar hanger included ⁽²⁰⁾
- BA1 Adjustable butterfly pan bracket, bar hanger not included ⁽²¹⁾
- CA1 Adjustable caterpillar pan bracket, universal bar hanger included ⁽²²⁾

NOTES

- Static white lumen output based on O trim type, W distribution and CS finish, 80 CRI, 3000K for single CCT and 4000K for TW. Actual lumens may vary +/-5%. See page 2 for FIXTURE PERFORMANCE DATA.
- See page 5 for NODE CONNECTION DETAILS. For additional PoE info, see hew.com/poe.
- N Mounting Type only. Not available with Tunable White.
- Extended lead times may apply. Consult factory for availability. Not available with Tunable White.
- I Mounting Type required.
- I Mounting Type required. P27 lumen package max.
- Trim ships separately.
- Beam angle based on CS or WH reflector finish.
- Not available with Tunable White when specified with O Trim Type.
- For use with mud-in plaster construction only, supplied with mud flange installation kit. See page 3 for FLANGE TYPE DETAILS. Not available with ATH option.

- Not available with WH Reflector Finish or L Trim Type.
- L and A Trim Types only. W distribution only.
- L and A Trim Types only. W distribution only.
- L Trim Type only. Not available with PD trim option.
- WH and BL Reflector Finishes only.
- Mounting hardware required (N and I only), ordered separately, see MOUNTING HARDWARE ordering info. See page 4 for MOUNTING TYPE DETAILS.
- Additional mounting hardware options available. See page 5 for MOUNTING HARDWARE DETAILS.
- Not available with P38 lumen package.
- Also used in new construction sheetrock ceilings. P27 lumen package max.
- N and I Mounting Types only. Universal bar hanger ships uninstalled. I Mounting requires external brackets.
- N Mounting Type only.
- N Mounting Type only.



6AR PoE | tunable WHITE 6" Adjustable Downlight – Round

FIXTURE PERFORMANCE DATA

STANDARD

OPEN REFLECTOR TRIM TYPE

	DISTRIBUTION	DELIVERED LUMENS	WATTAGE	EFFICACY (lm/W)
P13	W	1305	12.3	106.1
	M	1308	12.3	106.4
	N	1308	12.3	106.3
P27	W	2651	25.0	106.0
	M	2658	25.0	106.3
	N	2657	25.0	106.3
P38	W	3792	37.5	101.1
	M	3789	37.5	101.0
	N	3627	37.5	96.7

FLUSH LENS TRIM TYPE

	DISTRIBUTION	DELIVERED LUMENS	WATTAGE	EFFICACY (lm/W)
P13	W	1146	12.3	93.2
	M	1223	12.3	99.5
	N	1216	12.3	98.9
P27	W	2328	25.0	93.1
	M	2485	25.0	99.4
	N	2471	25.0	98.8
P38	W	3326	37.5	88.7
	M	3531	37.5	94.2
	N	3391	37.5	90.4

ANGLED LENS TRIM TYPE

	DISTRIBUTION	DELIVERED LUMENS	WATTAGE	EFFICACY (lm/W)
P13	W	952	12.3	77.4
	M	1137	12.3	92.4
	N	1161	12.3	94.4
P27	W	1934	25.0	77.4
	M	2310	25.0	92.4
	N	2358	25.0	94.3
P38	W	2786	37.5	74.3
	M	3258	37.5	86.9
	N	3173	37.5	84.6

TUNABLE WHITE

OPEN REFLECTOR TRIM TYPE

	DISTRIBUTION	DELIVERED LUMENS	WATTAGE	EFFICACY (lm/W)
P13	W	1048	12.3	85.2
	M	1093	12.3	88.9
	N	–	–	–
P27	W	1778	25.0	71.1
	M	1838	25.0	73.5
	N	–	–	–
P38	W	–	–	–
	M	–	–	–
	N	–	–	–

FLUSH LENS TRIM TYPE

	DISTRIBUTION	DELIVERED LUMENS	WATTAGE	EFFICACY (lm/W)
P13	W	958	12.3	77.9
	M	1026	12.3	83.4
	N	1013	12.3	82.3
P27	W	1630	25.0	65.2
	M	2427	25.0	97.0
	N	1641	25.0	65.7
P38	W	–	–	–
	M	–	–	–
	N	–	–	–

ANGLED LENS TRIM TYPE

	DISTRIBUTION	DELIVERED LUMENS	WATTAGE	EFFICACY (lm/W)
P13	W	824	12.3	67.0
	M	949	12.3	77.2
	N	966	12.3	78.5
P27	W	1778	25.0	71.1
	M	1596	25.0	63.8
	N	1546	25.0	61.8
P38	W	–	–	–
	M	–	–	–
	N	–	–	–

MULTIPLIER TABLES

	COLOR TEMPERATURE		
	CCT	LUMENS	
		STANDARD	TUNABLE WHITE
80 CRI	2700K	0.92	0.83
	3000K	0.98	1.00
	3500K	1.00	0.99
	4000K	1.01	1.00
	5000K	1.02	0.98
90 CRI	2700K	0.76	–
	3000K	0.79	–
	3500K	0.82	–
	4000K	0.84	–
	5000K	0.88	–

OPEN REFLECTOR FINISH	
CATALOG NUMBER	CONVERSION FACTOR
CS	1.00
WH	0.89
BL	0.79

TRIM	
CATALOG NUMBER	CONVERSION FACTOR
AD ¹	0.85
PD ¹	0.85

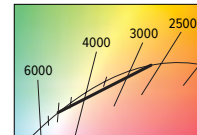

- Distribution will also be affected, consult factory.
- Photometrics tested in accordance with IESNA LM-79. Results shown are based on 25°C ambient temperature.
 - Standard results based on 3500K/80 CRI, 0° tilt, actual lumens may vary +/-5%
 - Tunable white results based on 4000K/80 CRI, 0° tilt, actual lumens may vary +/-5%
 - Use multiplier tables to calculate additional options.



6AR PoE | tunable WHITE 6" Adjustable Downlight – Round

PHOTOMETRY

6AR-P27-835-POE PR-OW-OF-WH (25° tilt) Total Luminaire Output: 2634 lumens; 25.0 Watts | Efficacy: 105.4 lm/W | 80 CRI; 3500K CCT

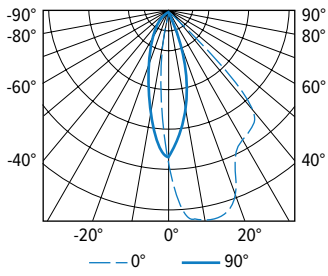

VERTICAL ANGLE	HORIZONTAL ANGLE					ZONAL LUMENS
	0°	45°	90°	135°	180°	
0	3480	3480	3480	3480	3480	
5	4862	4286	3083	2147	1733	289
15	5090	3800	1765	591	414	627
25	3900	3397	723	163	123	729
35	3463	2549	146	35	27	671
45	2265	283	15	8	8	301
55	27	3	0	0	3	16
65	0	0	0	0	0	0
75	0	0	0	0	0	0
85	0	0	0	0	0	0
90	0	0	0	0	0	0

LUMEN SUMMARY	ZONE	LUMENS	% FIXTURE
	0 - 30	1645	63
	0 - 40	2317	88
	0 - 60	2634	100
	0 - 90	2634	100
	0 - 180	2634	100

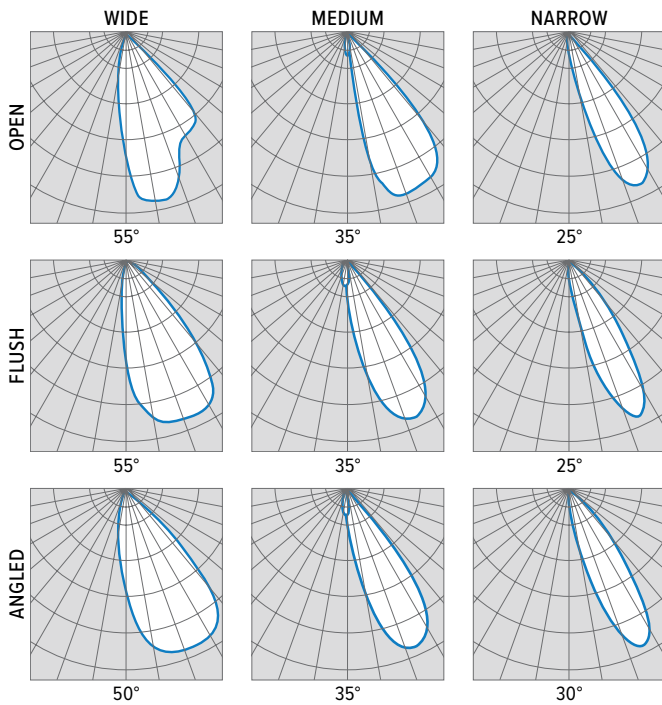

TRIM TYPE DETAILS

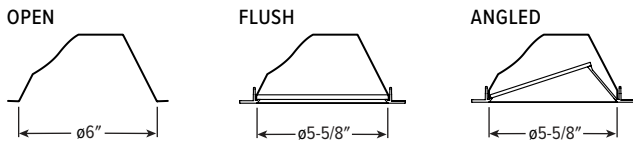

FLANGE TYPE DETAILS

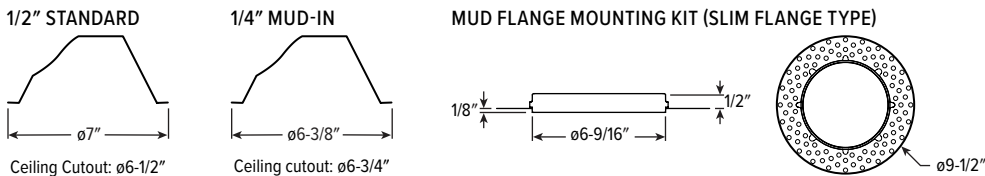

6AR PoE | tunable **WHITE** 6" Adjustable Downlight – Round

REFLECTOR FINISH DETAILS



MOUNTING TYPE DETAILS

NEW CONSTRUCTION

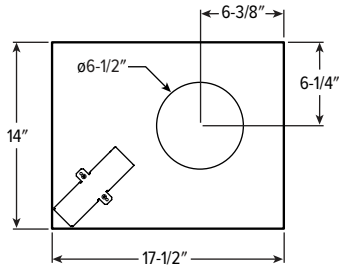

IC-RATED

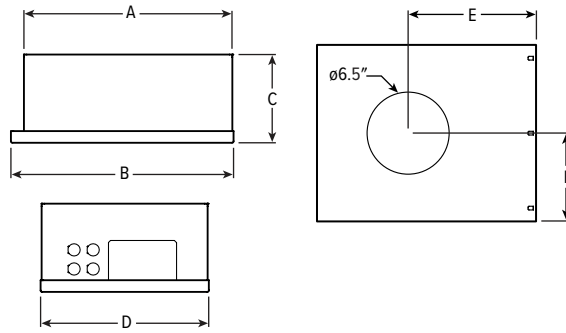

LUMENS	LENGTH					
	A	B	C	D	E	F
P13	15-3/16"	16"	6-3/8"	12-1/8"	9-1/2"	6-1/16"
P27	16-5/8"	17-1/2"	7-7/8"	14"	10-1/4"	7"

REMODEL

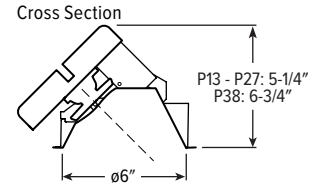

Receiver Bracket

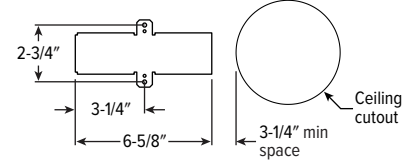

Driver and Junction Box

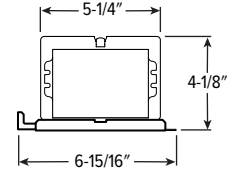

6AR PoE | tunable WHITE

6" Adjustable Downlight – Round

MOUNTING HARDWARE DETAILS

F1 Integral 2-position fixed pan bracket, universal bar hanger included

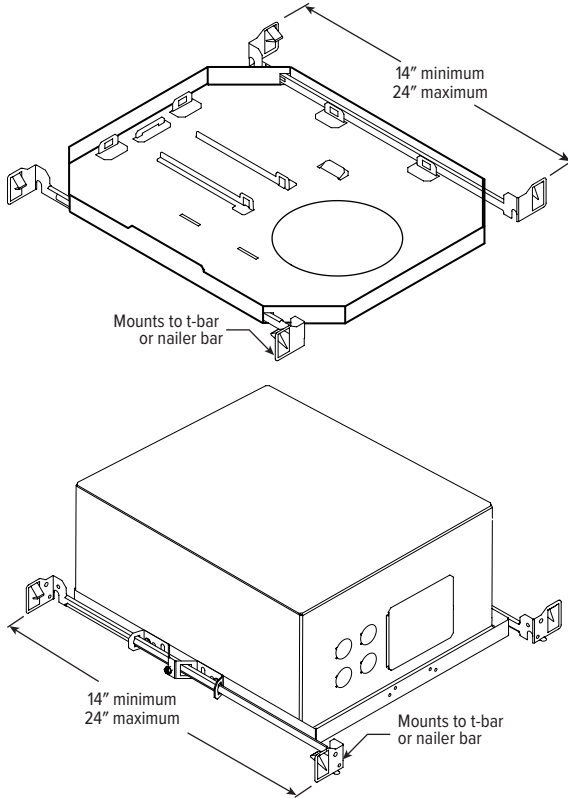

F1 with I Mounting Type

BA1 Adjustable butterfly pan bracket, bar hanger not included (N Mounting Type only)

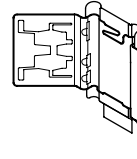

BA2 Adjustable butterfly pan bracket, heavy-duty universal bar hanger included (N Mounting Type only)

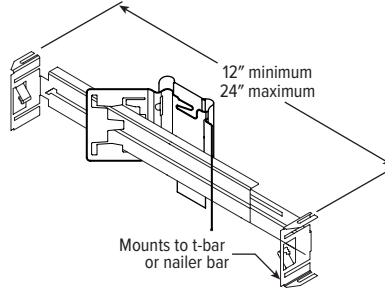

CA1 Adjustable caterpillar pan bracket, universal bar hanger included (N Mounting Type only)

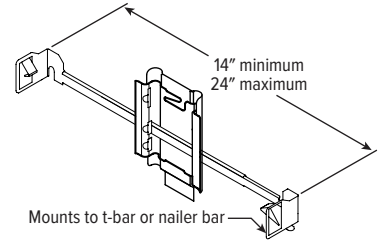

CA2 Adjustable caterpillar pan bracket, t-bar hanger included (N Mounting Type only)

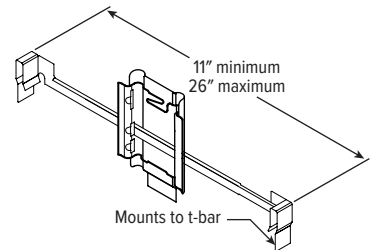

NODE CONNECTION DETAILS

Includes 24" cable with 4-position mating connector for Platformatics POE-LN2 node. See node spec sheet for details: platformatics.com/product/poe-ln2

