

# 6CR tunable **RGBW** 6.5" Compact Cylinder – Round

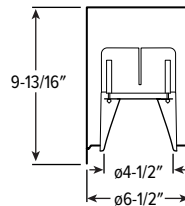

CATALOG #: \_\_\_\_\_

TYPE: \_\_\_\_\_

PROJECT: \_\_\_\_\_



TrimLock® TwistLock™

ORDERING EXAMPLE: **6CR - TL - 10 - L31/RGB940 - RDB - OPTIONS - WHT - DMX - UNV - FW - CS - CM**  
HOUSING TRIM MOUNT.

## HOUSING

SERIES	HEIGHT	LUMENS <sup>[1]</sup>	COLOR/CRI	CCT	REMOTE	OPTIONS	HOUSING FINISH <sup>[2]</sup>
6CR - TL TrimLock	10 10"	L31 3,100lm	RGB9 Red, green, blue, and 90 CRI white	27 2700K 30 3000K 35 3500K 40 4000K	RDB Remote mount control/driver box, galvanized steel <sup>[3]</sup>	EM/10WRM/RTS Remote mount 10-watt emergency battery with regressed test switch <sup>[4]</sup> F Fuse	ALUM Silver sparkle aluminum BLK Textured black BRZ Textured bronze NKL Textured nickel SLV Textured silver WHT Textured white

CONTROL <sup>[5]</sup>	VOLTAGE
DMX DMX512/RDM	UNV 120-277V

## TRIM

TRIM TYPE	DISTRIBUTION <sup>[6]</sup>	REFLECTOR FINISH <sup>[7]</sup>
F Open reflector with frosted top diffuser	W Wide 60° Open	CS Clear semi-specular powder coat WH White texture powder coat <sup>[10]</sup> BL Black texture powder coat
L Flush lens <sup>[8]</sup>	50° Flush	
R Regressed lens <sup>[9]</sup>	50° Regressed	
	M Medium 50° Open	
	N Narrow 25° Open	

## MOUNTING

### MOUNTING TYPE <sup>[11]</sup>

CM	Adjustable aircraft cable mount, 24", 48", 96", or 144" only, must specify. Example: 24" cable = <b>CM24</b> <sup>[12]</sup>
PM	Pendant mount. Example: 24" pendant = <b>PM24</b> <sup>[13]</sup>
PC	Power cord mount. Example: 24" cord = <b>PC24</b> <sup>[14]</sup>
SM	TwistLock surface mount to octagonal J-box
WM	Wall mount

## NOTES

- <sup>1</sup> Lumen output based on F Trim Type, W Distribution, CS Reflector Finish, 90 CRI/4000K CCT. Actual performance may vary +/- 5%, see page 2 for FIXTURE PERFORMANCE DATA.
- <sup>2</sup> See page 3 for HOUSING FINISH DETAILS.
- <sup>3</sup> Painted driver box available, specify RDB/BLK or RDB/WHT. See page 3 for REMOTE MOUNT DETAILS.
- <sup>4</sup> White output only in emergency mode. Max remote distance 50', including suspension length. Large remote box provided. Specify CEC in the option code when California Energy Commission regulations are required. See page 3 for REMOTE MOUNT DETAILS.
- <sup>5</sup> See page 3 for CONTROL DETAILS.
- <sup>6</sup> Beam angle based on F Trim Type and CS Reflector Finish. Trim Type affects beam angle. See page 2 for FIXTURE PERFORMANCE DATA.

- <sup>7</sup> See page 3 for REFLECTOR FINISH DETAILS.

- <sup>8</sup> W Distribution only.

- <sup>9</sup> W Distribution only.

- <sup>10</sup> W Distribution only.

- <sup>11</sup> See page 4 for MOUNTING DETAILS.

- <sup>12</sup> Canopy painted white unless specified otherwise. Must specify cord. See page 4 for CORD OPTIONS.

- <sup>13</sup> Specify length in 1" increments, minimum 6". Canopy and pendant match fixture housing color unless specified otherwise.

- <sup>14</sup> 48" and 96" lengths available. Canopy painted white unless specified otherwise. Must specify cord. See page 4 for CORD OPTIONS.



# 6CR tunable RGBW 6.5" Compact Cylinder – Round

## FEATURES

- Create rich, vibrant designs with lasting visual impact using the full visible light spectrum
- Engineered to deliver great performance in a sleek, space-saving design
- Superior optical control with beams as narrow as 25° and field changeable optics as wide as 60°
- Complement the architectural elements of any space with a multitude of housing, trim and cord finishes
- Limitless application opportunities via pendant, cable, power cord, wall and ceiling mounts
- Ensure a simple and secure installation with TwistLock™ surface mount technology
- Precision-engineered extruded aluminum housing and die-cast aluminum trim face for clean aesthetic
- Low UGR meets LEED and WELL requirements
- Made Right Here® in the USA

## SPECIFICATIONS

- HOUSING** – Extruded aluminum with die-cast aluminum accent ring.
- FINISH** – Polyester powder coat bonded to phosphate-free, multi-stage pretreated metal. All parts painted after fabrication to facilitate installation, increase efficiency, and inhibit corrosion.
- TRIMLOCK** – Innovative TrimLock® reflector retention system ensures trim remains secure.
- OPEN REFLECTOR** – Low-iridescent anodized aluminum with top diffuser. Clear semi-specular finish standard.
- LENSED TRIM** – Die-cast aluminum frame with micro-prismatic, acrylic lens.
- ELECTRICAL** – High-performance Class 2 CSP RGBW LED array. Modular quick-connect plug for easy field-connection of LED light assembly to driver. Reported L70>60,000 hours (all colors). Reported L90: Red: >23,000 hours, Green: >44,000 hours, Blue: >60,000 hours, White: >48,000 hours
- CONTROL** – DMX enabled; controllers provided by others.
- MOUNTING** – Surface, cable, pendant, power cord, or wall mount. Indoor applications only. Control and EM battery installed in remote mount box.
- LISTINGS** –
  - cCSAus conforms to UL STD 1598 and UL STD 8750. Certified to CAN/CSA STD C22.2 No. 250.0. Suitable for dry and damp locations.
  - Build America, Buy America (BABA) and Buy American Act (BAA) compliant. Request certification at [hew.com/buy-american](http://hew.com/buy-american)
- WARRANTY** – 5-year limited warranty, see [hew.com/warranty](http://hew.com/warranty)

## FIXTURE PERFORMANCE DATA

F TRIM TYPE (CS REFLECTOR FINISH)										
DISTRIBUTION	WHITE LED ONLY				RED ONLY		GREEN ONLY		BLUE ONLY	
	WATTAGE	DELIVERED LUMENS	EFFICACY (lm/W)	WATTAGE	MAX COLOR LUMENS	WATTAGE	MAX COLOR LUMENS	WATTAGE	MAX COLOR LUMENS	
C1	W	55.4	3098	56	17.9	206	14.4	1090	18.2	327
	M	55.4	3219	58	17.9	214	14.4	1132	18.2	340
	N	55.4	2907	53	17.9	201	14.4	1063	18.2	319

## MULTIPLIER TABLES

COLOR TEMPERATURE	
CCT	CONVERSION FACTOR
2700K	0.92
3000K	0.94
3500K	0.96
4000K	1.00

	REFLECTOR FINISH	
	CATALOG NUMBER	CONVERSION FACTOR
O TRIM	CS	1.00
	WH <sup>[1]</sup>	0.89
	BL <sup>[1]</sup>	0.47
R TRIM	WH	1.00
	CS <sup>[1]</sup>	0.98
	BL <sup>[1]</sup>	0.79

TRIM OPTIONS	
CATALOG NUMBER	CONVERSION FACTOR
F	1.00
L	0.76
R	0.74

- <sup>1</sup> Distribution will also be affected, consult factory.
- Photometrics tested in accordance with IESNA LM-79. Results based on F Trim Type, W Distribution, CS Reflector Finish, 90 CRI/4000K CCT, wattage for 120V input, and 25°C ambient temperature. Actual performance may vary +/-5%.
  - To calculate lumen output in emergency mode, multiply the battery wattage by the efficacy.
  - Use multiplier tables to calculate additional options.

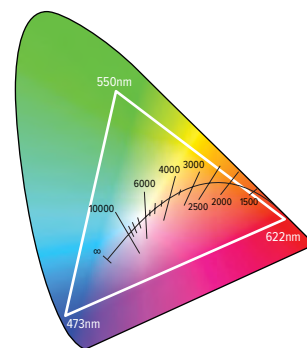

## PHOTOMETRY

6CR-TL-10-L31/RGB940-DMX-UNV-FW-OF-CS (White Only) Total Luminaire Output: 3098 lumens; 55.4 Watts | Efficacy: 56 lm/W | 90 CRI; 4000K CCT

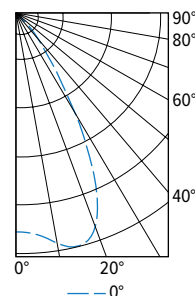

CANDLEPOWER DISTRIBUTION	VERTICAL ANGLE	HORIZONTAL ANGLE	ZONAL LUMENS
		0°	
	0	2942	
	5	2993	291
	15	3248	906
	25	2499	1107
	35	864	563
	45	250	196
	55	23	28
	65	6	6
75	1	1	
85	0	0	
90	0		

LUMEN SUMMARY	ZONE	LUMENS	% FIXTURE
	0 - 40	2866	93
	0 - 60	3090	100
	0 - 90	3098	100
	0-180	3098	100

## OPEN

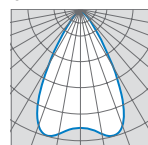

60° Wide

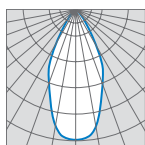

50° Medium

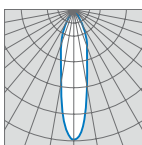

25° Narrow

## FLUSH

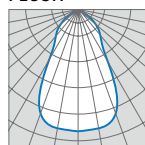

50° Wide

## REGRESSED

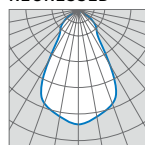

50° Wide



# 6CR tunable RGBW 6.5" Compact Cylinder – Round

## REMOTE MOUNT DETAILS

Max remote distance is 50' including suspension length, connection by others.

### CONTROL

Medium remote box provided when specified without EM battery.

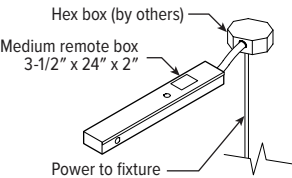

### EMERGENCY BATTERY

Large remote box provided.

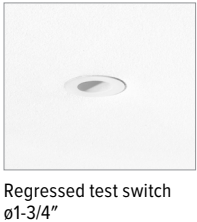
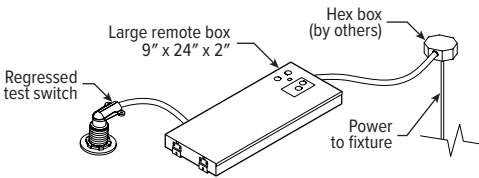

## CONTROL DETAILS

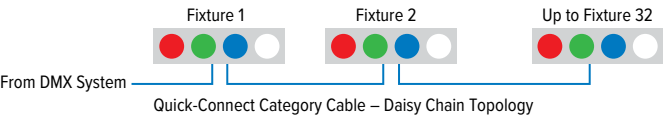

Note: Fixtures ship with DMX starting address of 1. (Red: 1, Green: 2, Blue: 3, White: 4). Terminator resistor (by others) is recommended at the end of each DMX run.

## TRIMLOCK DETAILS

### TWIST



### PULL



### RELEASE



## TRIM TYPE DETAILS

### OPEN (F)

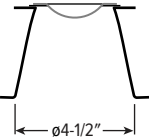

### FLUSH

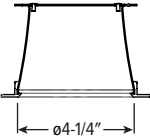

### REGRESSED

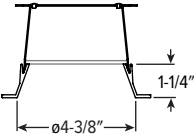

## HOUSING FINISH DETAILS

### WHITE

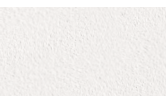

### BLACK



### BRONZE



### NICKEL



### SILVER



### ALUM



For custom color, please specify RAL code or a manufacturer code with description. All custom colors other than RAL require two sample swatches, minimum 1" square.

## REFLECTOR FINISH DETAILS

### Smooth Finish CS



### Textured Finish WH

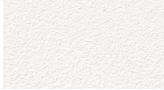

### BL



6CR

tunable **RGBW**  
6.5" Compact Cylinder – Round

MOUNTING DETAILS

PENDANT MOUNT (PM\_\_)



- Provided with:
- 38° Swivel canopy
  - 3/8" IPS Threaded stem
  - Specify length of stem, 6" minimum, 24" default length

WALL MOUNT (WM)



TOP VIEW

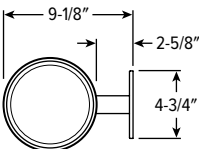

SIDE VIEW

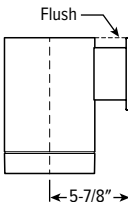

BACK VIEW

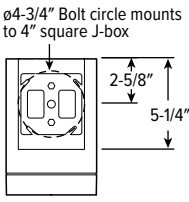

SURFACE MOUNT (SM)



**TwistLock™**  
Simple lift-and-twist mounting  
secures fixture to J-box.

CABLE MOUNT (CM\_\_)



- Provided with:
- Adjustable length aircraft cable, must specify length in 24", 48", 96", or 144" inches.
  - 18-gauge cord, see Cord Options for ordering info.
  - One 5" canopy
  - T-bar clip with 1/4-20 stud
  - Hard ceiling anchor provided by others

POWER CORD MOUNT (PC)



- Provided with:
- 18-gauge cord, see Cord Options for ordering info.
  - One 5" canopy
  - Power cord mounting adaptor

CORD OPTIONS

Must specify cord when cable and power cord mounting.

ORDERING EXAMPLE: S2438/W				
CORD TYPE	LENGTH	# CONDUCTORS	WIRE SIZE	COLOR
S Straight	24 24" 48 48" 96 96"	3 3 4 4 5 5 6 6	8 18-gauge	<b>Standard</b>
				/W White
				/B Black
				<b>Braided <sup>[1]</sup></b>
				/WH White
				/BL Black
S Straight	24 24" 48 48" 96 96"	3 3 4 4 5 5 6 6	8 18-gauge	/BR Brass
				/AE Aegean Blue
				/RE Red
				/SV Silver
				/GU Gunmetal
				/NK Nickel
S Straight	24 24" 48 48" 96 96"	3 3 4 4 5 5 6 6	8 18-gauge	/GR Gray

<sup>1</sup> (5) conductors cord only.

COLOR DETAILS

Additional colors may be available, consult factory.

