

CATALOG #: \_\_\_\_\_

TYPE: \_\_\_\_\_

PROJECT: \_\_\_\_\_

## NEW CONSTRUCTION AND REMODEL

### FEATURES

#### TrimLock®

- Create scalable, highly functioning smart buildings with Platformatics Power over Ethernet controls
- Tunable white from 2700K to 5000K CCT, minimum 80 CRI

### SPECIFICATIONS

- HOUSING** – Die-cast aluminum trim housing with forged aluminum heat sink. Galvanized steel splice compartment with driver mounting plate/enclosure. Swing-out mounting arms field adjust for ceiling thickness from 1/2" – 2-1/4".
- TRIMLOCK** – Innovative TrimLock reflector retention system ensures the trim remains flush with the ceiling plane.
- OPEN REFLECTOR** – Low-iridescent anodized aluminum. Clear semi-specular finish standard.
- LENSED TRIM** – Die-cast aluminum frame with micro-prismatic, acrylic lens.
- ELECTRICAL** – High-performance Class 2 LED array. Modular quick-connect plug for easy field-connection of LED light assembly to driver. Reported L70>50,000 hours. Low-voltage DC fixture, to be fed by Class 2 power supply. Tunable White products use LEDs of multiple CCTs and may produce a perceptibly different shade of white from single-CCT products at the same CCT. All CCTs are within 3 MacAdam ellipses.
- MOUNTING** – Recessed. 20 ga. galvanized steel mounting pan for new construction or IC-rated enclosure. Remodel kit option includes receiver bracket hardware. Minimum 24" O.C. marked spacing required for P44 and P62 lumen packages.
- LISTINGS** –
  - cCSAus conforms to UL STD 1598; Certified to CAN/CSA STD C22.2 No. 250.0 for damp locations. LED light assembly conforms to UL 2108 for remote installation.
  - Suitable for wet location under covered ceiling when specified with WET/CC or TD options.
  - IC-rated for direct contact with insulation when specified with I Mounting Type.
  - City of Chicago Environmental Air approved when specified with CP option.
  - Complies with ASTM-E283 when specified with ATH option.
  - RoHS compliant.

- WARRANTY** – 5-year limited warranty, see [hew.com/warranty](http://hew.com/warranty).

### SYSTEM REQUIREMENTS

- PoE-ready luminaires are connected to building power systems through network integration and require other components for complete PoE lighting system
- For additional PoE info, see [hew.com/platformatics](http://hew.com/platformatics)
- Consult factory for design support

ORDERING EXAMPLE: 4DR - TL - P28/835 - OPTIONS - POE PR - OW - OF - CS - TRIM OPTIONS - N - F1

### HOUSING

SERIES	LUMENS <sup>(1)</sup>	CRI	CCT	OPTIONS	CONTROL <sup>(2)</sup>
4DR - TL	P15 1,500lm	8 80	27 2700K	SCA_ Sloped ceiling adapter <sup>(6)</sup>	POE PR Power over Ethernet, Platformatics ready
TrimLock	P28 2,800lm	9 90 <sup>(4)</sup>	30 3000K	ATH Airtight construction	
	P44 4,400lm		35 3500K	CP Chicago plenum (CCEA) <sup>(7)</sup>	
	P62 6,200lm <sup>(3)</sup>		40 4000K		
			50 5000K		
			TW Tunable white (80 CRI, 2700K–5000K) <sup>(5)</sup>		

### TRIM <sup>(8)</sup>

TRIM TYPE	DISTRIBUTION <sup>(9)</sup>	FLANGE TYPE	REFLECTOR FINISH	TRIM OPTIONS
O Open reflector	W Wide	OF 1/2" standard flange	Open trim types	MWT Textured white trim flange <sup>(17)</sup>
L Flush lens	65° Open	SF 1/4" mud-in flange <sup>(15)</sup>	CS Clear semi-specular anodize	IP IP65 rated trim <sup>(18)</sup>
R Regressed lens	50° Flush		SG Satin-glow anodize	AD Diffuse acrylic lens <sup>(19)</sup>
A Angled lens <sup>(10)</sup>	50° Regressed		GD Gold anodize	PD Diffuse 1/8" polycarbonate lens <sup>(20)</sup>
S Non-conductive flush lens for shower applications <sup>(11)</sup>	M Medium <sup>(12)</sup>		CG Champagne gold anodize	TD Diffuse polycarbonate lens media at top of open reflector <sup>(21)</sup>
	45° Open		PW Pewter anodize	WET/CC Wet location, covered ceiling listed <sup>(22)</sup>
	35° Flush		SPC Clear specular anodize	AM Anti-microbial <sup>(23)</sup>
	N Narrow <sup>(13)</sup>		RG Rose gold anodize	
	10° Open		WH White texture powder coat	
	25° Flush		BL Black texture powder coat	
	25° Regressed		CS trim types	
	WW Wall wash <sup>(14)</sup>		Clear semi-specular powder coat	
			WH White texture powder coat	
			BL Black texture powder coat	
			MB Black texture splay with white flange <sup>(16)</sup>	

### MOUNTING

#### MOUNTING TYPE <sup>(24)</sup>

- N Open pan for new construction
- I IC-rated enclosure for new construction <sup>(26)</sup>
- R Remodel kit <sup>(27)</sup>

#### MOUNTING HARDWARE <sup>(25)</sup>

- F1 Integral 2-position fixed pan bracket, universal bar hanger included <sup>(28)</sup>
- BA1 Adjustable butterfly pan bracket, bar hanger not included <sup>(29)</sup>
- CA1 Adjustable caterpillar pan bracket, universal bar hanger included <sup>(30)</sup>

### NOTES

- Static white lumen output based on O trim type, W distribution and CS finish, 80 CRI, 3500K for single CCT and 4000K for TW. Actual lumens may vary +/-5%, see page 2 for FIXTURE PERFORMANCE DATA
- See page 4 for NODE CONNECTION DETAILS. For additional PoE info, see [hew.com/platformatics](http://hew.com/platformatics).
- N Mounting Type only.
- Extended lead times may apply. Consult factory for availability. Not available with Tunable White.
- P15 and P28 lumen packages only.
- 9" aperture, specify degrees of slope in 5° increments, 05°-30°. Not available with I Mounting Type, ATH or WET/CC options. Painted white. Other colors available, consult factory. See page 3 for SLOPED CEILING ADAPTOR DETAILS.
- I Mounting Type required.
- Trim ships separately.
- Beam angle based on CS or WH reflector finish.
- Available with WW Distribution only.
- W Distribution, OF Flange Type and WH Reflector Finish only. Standard with AD diffuse acrylic lens. IP and WET/CC options standard.
- Not available with lumen stops P44 and higher when specified with flush or regressed trim types.
- Not available with lumen stops P44 and higher when specified with flush or regressed trim types.
- O and A Trim Types only.
- For use with mud-in plaster construction only, supplied with mud flange installation kit. See page 3 for FLANGE TYPE DETAILS. Not available with ATH or IP options.
- R Trim Type only. Not available with MWT.
- Not available with WH Reflector Finish, L or S Trim Types.
- L and R Trim Types only.
- Not available with O trim type. W and WW distributions only.
- Not available with O trim type. W and WW distributions only.
- O Trim Type only. WET/CC standard unless ordered with EM/RTS.
- Not available with PD trim option.
- WH and BL Reflector Finishes only. Not available with S Trim Type.
- Mounting hardware required (N and I only), ordered separately, see MOUNTING HARDWARE ordering info. See page 4 for MOUNTING TYPE DETAILS.
- Additional mounting hardware options available. See page 5 for MOUNTING HARDWARE DETAILS.
- P15 lumen package only. P28 available, wide distribution only for lensed trims.
- Also used in new construction sheetrock ceilings. P28 lumen package max.
- N and I Mounting Types only. I Mounting requires external brackets.
- N Mounting Type only.
- N Mounting Type only.



# 4DR PoE | tunable WHITE 4.5" Downlight – Round

## FIXTURE PERFORMANCE DATA

### STATIC WHITE

	DIST.	WATTAGE	OPEN REFLECTOR		FLUSH LENS		REGRESSED LENS	
			DELIVERED LUMENS	EFFICACY (lm/W)	DELIVERED LUMENS	EFFICACY (lm/W)	DELIVERED LUMENS	EFFICACY (lm/W)
P15	W	12.3	1537	125.5	1196	97.6	1208	98.6
	M	12.3	1480	120.8	1356	110.7	1361	111.1
	N	12.3	1426	116.4	1365	111.4	1372	112.0
P28	W	25.0	2835	113.9	2196	87.8	2219	88.8
	M	25.0	2719	108.8	2491	99.6	2499	100.0
	N	25.0	2619	104.8	2507	100.3	2520	100.8
P44	W	37.5	4408	117.5	3430	91.5	3466	92.4
	M	37.5	4234	112.9	-	-	-	-
	N	37.5	4039	107.7	-	-	-	-
P62	W	50.0	6151	123.0	4786	95.7	4836	96.7
	M	50.0	5822	116.4	-	-	-	-
	N	50.0	5612	112.2	-	-	-	-

### TUNABLE WHITE

	DIST.	WATTAGE	OPEN REFLECTOR		FLUSH LENS		REGRESSED LENS	
			DELIVERED LUMENS	EFFICACY (lm/W)	DELIVERED LUMENS	EFFICACY (lm/W)	DELIVERED LUMENS	EFFICACY (lm/W)
P15	W	12.3	1311	107.0	1020	83.3	1031	84.1
	M	12.3	1263	103.1	1157	94.4	1161	94.7
	N	12.3	1216	99.3	1164	95.1	1170	95.5
P28	W	25.0	2649	105.9	2061	82.4	2083	83.3
	M	25.0	2544	101.8	2337	93.5	2345	93.8
	N	25.0	2427	97.1	2353	94.1	2364	94.6

### MULTIPLIER TABLES

	COLOR TEMPERATURE		
	CCT	LUMENS	
		STANDARD	TUNABLE WHITE
80 CRI	2700K	0.92	0.83
	3000K	0.98	1.00
	3500K	1.00	0.99
	4000K	1.01	1.00
	5000K	1.02	0.98
90 CRI	2700K	0.76	-
	3000K	0.79	-
	3500K	0.82	-
	4000K	0.84	-
	5000K	0.88	-

	REFLECTOR FINISH	
	CATALOG NUMBER	CONVERSION FACTOR
O TRIM	CS	1.00
	SG <sup>1</sup>	0.92
	GD	0.93
	CG	0.96
	PW	0.86
	SPC	1.02
	RG	0.88
	WH <sup>1</sup>	0.89
R TRIM	WH	1.00
	CS	0.98
	BL	0.79

TRIM	
CATALOG NUMBER	CONVERSION FACTOR
S	0.85
AD	0.85
PD	0.85
TD	0.75
WET/CC <sup>2</sup>	0.85

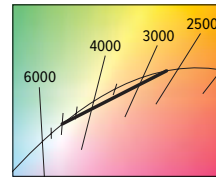

- Distribution will also be affected, consult factory.
  - Use multiplier when specified with O Trim Type.
- Photometrics tested in accordance with IESNA LM-79. Results shown are based on 25°C ambient temperature.
  - Standard results based on 3500K/80 CRI, actual lumens may vary +/-5%
  - Tunable white results based on 4000K/80 CRI, actual lumens may vary +/-5%
  - Use multiplier tables to calculate additional options.

### PHOTOMETRY

4DR-TL-P28/835-POE-PR-OW-OF-CS Total Luminaire Output: 2835 lumens; 25.0 Watts | Efficacy: 113.4 lm/W | 80 CRI; 3500K CCT

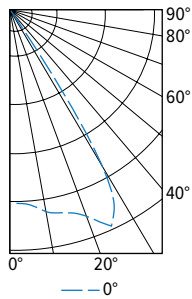

	VERTICAL ANGLE	HORIZONTAL ANGLE	ZONAL LUMENS
		0°	
CANDELPWER DISTRIBUTION	0	2559	
	5	2636	252
	15	2771	786
	25	3155	1460
	35	434	273
	45	62	47
	55	16	14
	65	1	2
	75	0	0
	85	0	0
	90	0	0

	LUMEN SUMMARY		
	ZONE	LUMENS	% FIXTURE
LUMEN SUMMARY	0 - 40	2770	98
	0 - 60	2834	100
	0 - 90	2835	100
	0 - 180	2835	100



# 4DR PoE | tunable WHITE 4.5" Downlight – Round

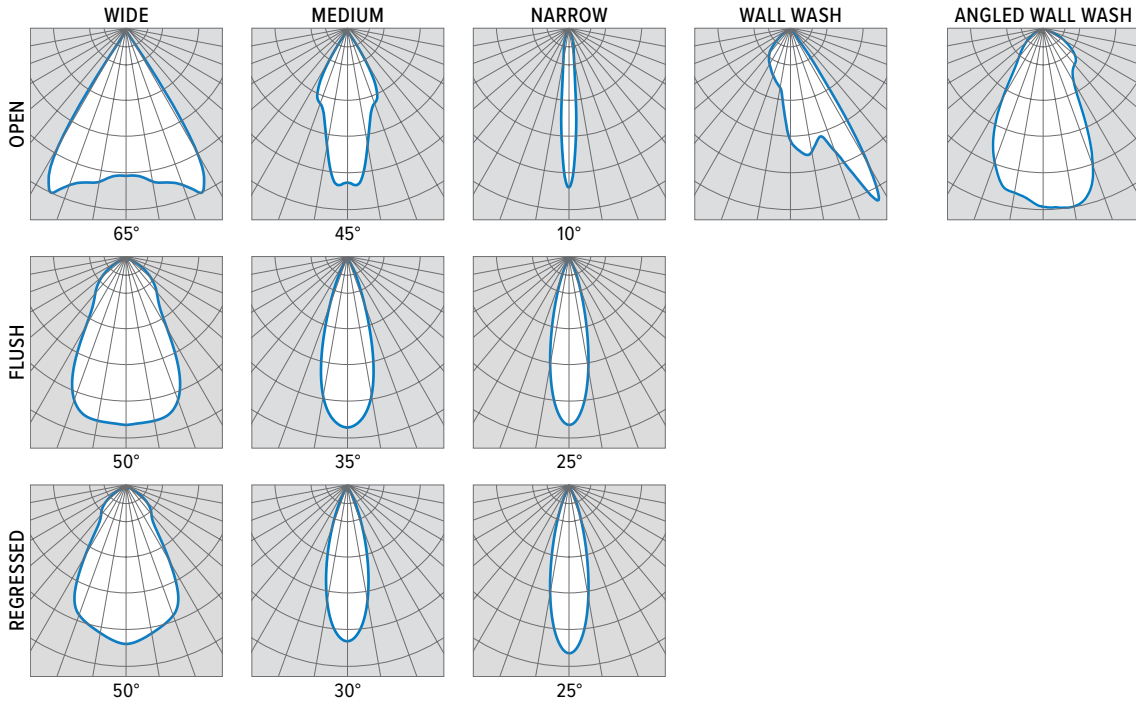

## TRIMLOCK DETAILS



## SLOPED CEILING ADAPTOR DETAILS

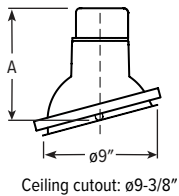

LUMENS	A (HEIGHT)						PLENUM HEIGHT
	5°	10°	15°	20°	25°	30°	
P15 - P44	8-13/16"	8-15/16"	9"	8-15/16"	8-7/8"	8-11/16"	9-1/4"
P62	9-9/16"	9-11/16"	9-11/16"	9-5/8"	9-1/2"	9-5/16"	10"

15° Shown

## TRIM TYPE DETAILS

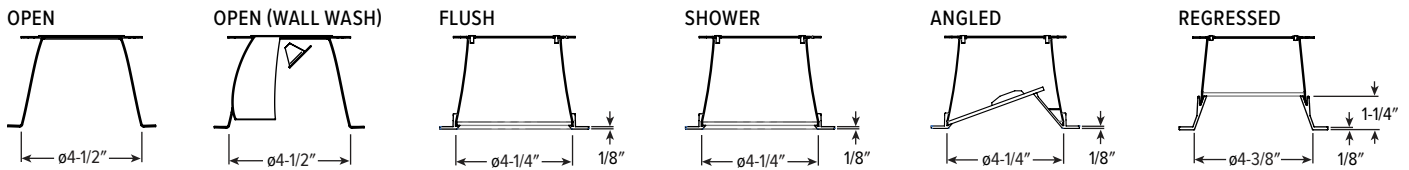

## FLANGE TYPE DETAILS

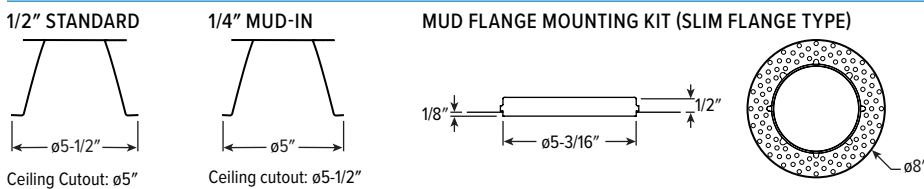

# 4DR PoE | tunable **WHITE** 4.5" Downlight – Round

## REFLECTOR FINISH DETAILS

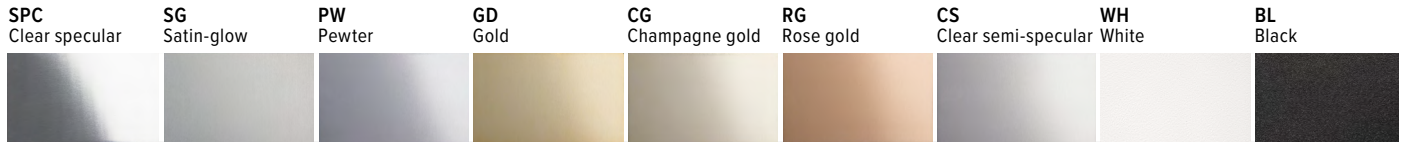

## MOUNTING TYPE DETAILS

### NEW CONSTRUCTION

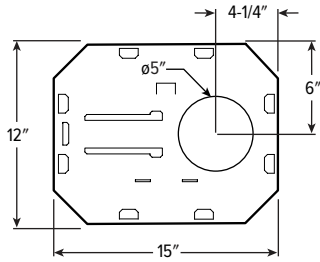

### IC-RATED

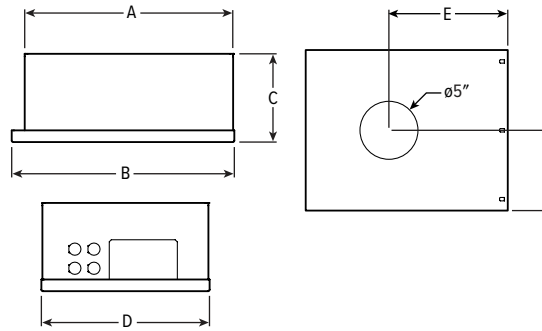

LUMENS	LENGTH					
	A	B	C	D	E	F
P15	15-3/16"	16"	6-3/8"	12-1/8"	9-1/2"	6-1/16"
P28	16-5/8"	17-1/2"	7-7/8"	14"	10-1/4"	7"

### REMODEL

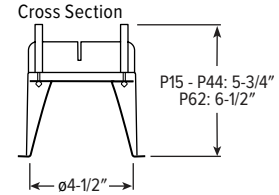

### Receiver Bracket

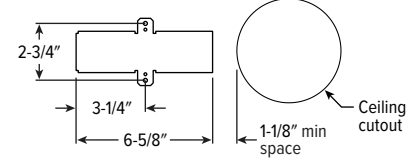

### Driver and Junction Box

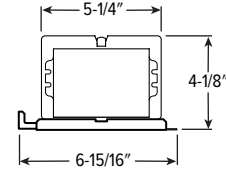

## NODE CONNECTION DETAILS

Includes 24" cable with 4-position mating connector for Platformatics POE-LN2 node. See node spec sheet for details: [platformatics.com/product/poe-ln2](http://platformatics.com/product/poe-ln2)

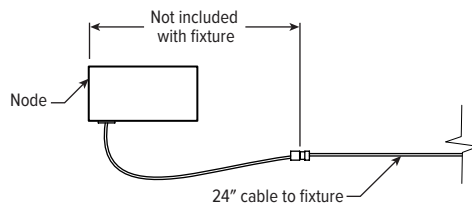

# 4DR PoE | tunable **WHITE** 4.5" Downlight – Round

## MOUNTING HARDWARE DETAILS

**F1** Integral 2-position fixed pan bracket, universal bar hanger included

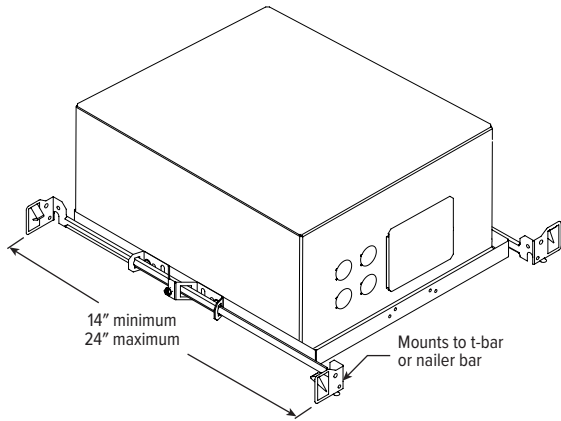
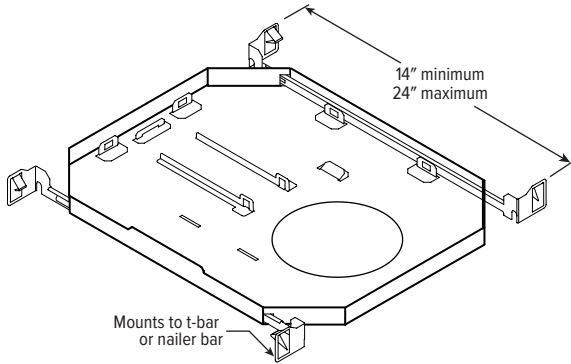

F1 with I Mounting Type

**BA1** Adjustable butterfly pan bracket, bar hanger not included (N Mounting Type only)

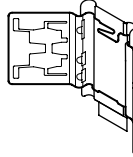

**BA2** Adjustable butterfly pan bracket, heavy-duty universal bar hanger included (N Mounting Type only)

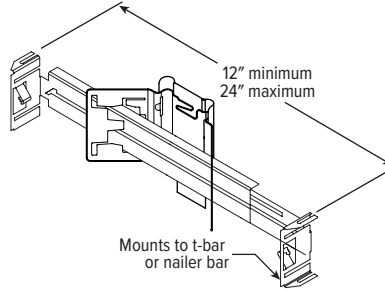

**CA1** Adjustable caterpillar pan bracket, universal bar hanger included (N Mounting Type only)

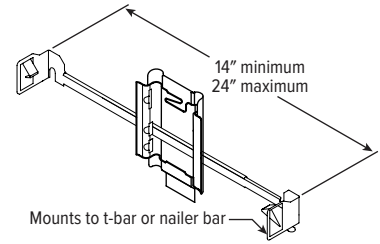

**CA2** Adjustable caterpillar pan bracket, t-bar hanger included (N Mounting Type only)

