

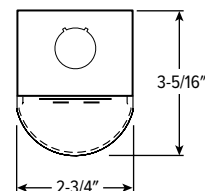

CATALOG #:

TYPE:

PROJECT:



FEATURES

- Ready to ship in 48 hours with on-hand inventory to support immediate job requirements
- Easy to install and service with long-lasting performance
- Small fixture profile allows inconspicuous placement in confined spaces
- Row applications produce continuous light with minimal interruption
- Round diffuse acrylic lens enhances uniformity and minimizes glare
- High-performance up to 152 lm/W
- Quick-wire knockouts in back of fixture housing for easy attachment of incoming power supply
- All parts painted after fabrication to provide safe installation without gloves
- Made Right Here® in the USA

ORDERING INFO

CATALOG NUMBER	LENGTH	LUMENS	CRI	CCT	SHIELDING	DRIVER	VOLTAGE	UPC CODE
75R-4-L50/835-QS-DIM-UNV	44-5/8"	5,000lm	80	3500K	Diffuse acrylic	Dimming driver, 0-10V	120-277V	850047638144
75R-4-L50/840-QS-DIM-UNV				4000K				850047638120

ACCESSORY CATALOG NUMBER	DESCRIPTION	UPC CODE
EM/10W KIT-NC-QS	10-watt emergency battery kit, no conduit ⁽¹⁾	850047638670

SPECIFICATIONS

- HOUSING – 22-gauge die-formed C.R.S.
- SHIELDING – Diffuse acrylic lens.
- FINISH – 92% minimum average reflective white polyester powder coat bonded to phosphate-free, multi-stage pretreated metal. All parts painted after fabrication to facilitate installation, increase efficiency, and inhibit corrosion.
- ELECTRICAL – High-quality mid-power LED board. L70 > 72,000 hours per IES TM-21. 25°C maximum ambient operating temperature. 50/60 Hz constant current driver.
- MOUNTING – Surface (ceiling or wall) or suspended (hanging hardware required).
- PACKAGING – One fixture per box, 182 per pallet.
- LISTINGS –
 - cETLus conforms to UL STD 1598. Certified to CAN/CSA STD C22.2 No. 250.0. Suitable for damp locations
 - Build America, Buy America (BABA) and Buy American Act (BAA) compliant. Request certification at hew.com/buy-american
 - WARRANTY – 5-year limited warranty, see hew.com/warranty

NOTES

- ¹ Ships separately, field installed. CEC compliant. EM battery and test switch field installed in fixture.





FIXTURE PERFORMANCE DATA

CATALOG NUMBER	CCT	DELIVERED LUMENS	WATTAGE	EFFICACY (lm/W)
75R-4-L50/835-QS-DIM-UNV	3500K	4867	33.0	147
75R-4-L50/840-QS-DIM-UNV	4000K	5013	33.0	152

- Photometrics tested in accordance with IESNA LM-79. Results based on 80 CRI/3500K CCT, wattage for 120V input, and 25°C ambient temperature. Actual performance may vary +/-5%.
- To calculate lumen output in emergency mode, multiply the battery wattage by the efficacy.

DISTRIBUTION CURVE

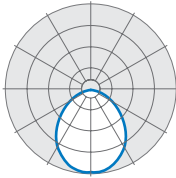

DIMENSIONS

BACK VIEW

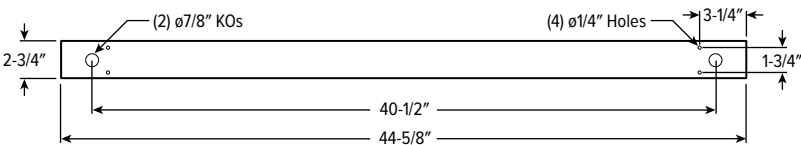

ACCESSORY DETAILS

EMERGENCY BATTERY KIT

