

SIDE MOUNT T8 STRIP

SM75

SUBMITTAL:

T8

JOB:

TYPE:

VOLTAGE:

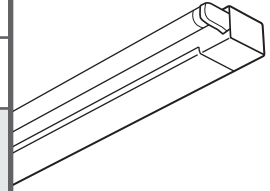

EXAMPLE

SM75 - 4 - 1 32 - OPTIONS - EB1 - UNV

SERIES NOMINAL LENGTH TOTAL WATTAGE/LAMPS TYPE OPTIONS BALLAST TYPE VOLTAGE



FEATURES

- ▶ Small profile allows inconspicuous placement in confined spaces.
- ▶ Factory-mounted, prewired sockets cut installation time.
- ▶ Quarter-turn fastener secures wireway cover to housing.
- ▶ Special reflectors are available for precise light distribution.
- ▶ Ballast secured by two captive bolts and nuts to ensure a tight, reliable fit for maximum heat dissipation.
- ▶ This fixture is proudly made in the USA.

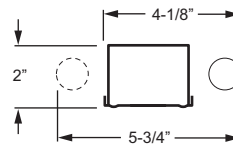

SPECIFICATIONS

Housing – 22-gauge die-formed C.R.S.
Finish – 92% minimum average reflective white polyester powder coat bonded to phosphate-free, multi-stage pretreated metal. All parts painted after fabrication to facilitate installation, increase efficiency, and inhibit corrosion.
Electrical – Electronic ballast standard, instant start T8, rated Class P.
Mounting – Surface or suspended.
Labels – UL/CUL listed as fluorescent luminaire suitable for dry or damp locations.

ORDERING INFORMATION

SERIES

SM75 Side Mount T8 Strip

NOMINAL LENGTH

18	18"
2	2'
3	3'
4	4'
6	6'
8	8'

TOTAL LAMPS

1, 2, or 4 (1- or 2-lamp cross-section)

LAMP WATTAGE/TYPE

15	18", 15-watt T8
17	2', 17-watt T8
25	3', 25-watt T8
32	4', 32-watt T8
59	8', 59-watt T8

OPTIONS

For generic **EM ballast** options (must specify voltage), see Fluorescent Information section. Size restrictions apply.

ALUM .032" thick aluminum fixture, painted after fabrication

ACCESSORIES

See back for **special reflectors**, ordered separately.

See Fluorescent Information section for **mounting accessories**.

BALLAST TYPE

See Information section for complete ballast offering.

EB1	1-lamp electronic ballast
EB2	2-lamp electronic ballast
EB2/2	(2) 2-lamp electronic ballasts
EB4	4-lamp electronic ballast

VOLTAGE

120	120V
277	277V
UNV	120-277V
347	347V

T8

PHOTOMETRY

Catalog #: **SM75-4-132-EB1**

SPECIAL REFLECTORS

Reflectors are ordered separately. For additional styles, see Fluorescent Information section.

Note: Drawings represent reflector style. Actual cross-section will vary depending on fixture/lamp configuration.

Example:
R1098-4-SM75 REFL

R0272



R1098



R1360



R1362



TEST REPORT INFORMATION

- ▶ Test Report #: 8597.0
- ▶ Date: 12/28/95
- ▶ Lamp Type: F32T8/SPX35/RS
- ▶ Lamp Quantity: 1

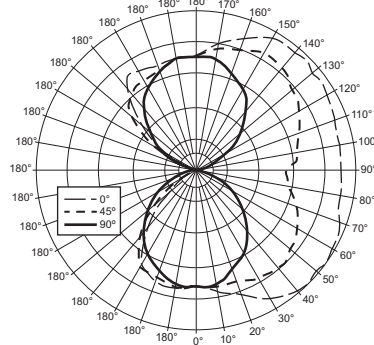

CANDLEPOWER DISTRIBUTION

Vertical Angle	Horizontal Angle			Zonal Lumens
	0°	45°	90°	
0°	346.	346.	346.	
5°	353.	351.	350.	33.6
15°	379.	355.	333.	99.3
25°	417.	363.	302.	158.3
35°	456.	376.	265.	203.2
45°	475.	382.	213.	219.5
55°	475.	363.	158.	206.8
65°	466.	336.	99.	177.0
75°	440.	302.	44.	151.4
85°	435.	275.	5.	139.0
90°	430.	270.	0.	
95°	432.	302.	6.	151.8
105°	434.	315.	36.	167.4
115°	449.	345.	89.	207.7
125°	462.	372.	150.	235.9
135°	468.	394.	208.	241.5
145°	464.	406.	266.	220.9
155°	437.	395.	298.	161.5
165°	401.	376.	326.	99.2
175°	360.	355.	341.	33.0
180°	340.	340.	340.	

ZONAL CAVITY COEFFICIENTS

	Ceiling			.80			.70			.50		
	Wall	.70	.50	.30	.70	.50	.30	.50	.30	.10		
Room Cavity Ratio	0	1.05	1.05	1.05	.97	.97	.97	.81	.81	.81		
1	.94	.89	.85	.86	.82	.78	.69	.66	.63			
2	.85	.77	.71	.78	.71	.65	.59	.55	.51			
3	.78	.68	.60	.71	.62	.55	.52	.47	.43			
4	.71	.60	.51	.65	.55	.48	.46	.40	.36			
5	.65	.53	.44	.59	.48	.41	.41	.35	.30			
6	.59	.47	.39	.54	.43	.36	.36	.31	.26			
7	.55	.42	.34	.50	.39	.32	.33	.27	.23			
8	.50	.38	.30	.46	.35	.28	.29	.24	.20			
9	.47	.34	.27	.43	.32	.25	.27	.21	.17			
10	.43	.31	.24	.40	.29	.22	.24	.19	.15			

Effective Floor Cavity Reflectance = .20

LUMEN SUMMARY

Zone	Lumens	% Lamp	% Fixture
0 - 30	291.	9.9	10.0
0 - 40	495.	16.8	17.0
0 - 60	921.	31.2	31.7
0 - 90	1388.	47.1	47.8
90 - 120	527.	17.9	18.1
90 - 130	763.	25.9	26.2
90 - 150	1225.	41.5	42.1
90 - 180	1519.	51.5	52.2
Total Luminaire:			
0 - 180	2907.	98.5	100.0

Total Luminaire Optical Efficiency: **98.5%**
IES Spacing Criteria: Across = 1.6, Along = 1.3

FIXTURE DETAILS

BACK VIEW

