

CATALOG #: \_\_\_\_\_

TYPE: \_\_\_\_\_

PROJECT: \_\_\_\_\_

## FEATURES

- Provides 90 minutes of emergency operation
- Ultra-bright, energy-efficient, long-life LEDs in red or green
- Optional tamper-resistant hardware helps discourage unauthorized access to the unit
- Adjustable LED lamp heads provide optimal center-to-center spacing
- Remote capable option available
- Unique dual color LED indicator light provides battery condition alert
- Fully automatic solid-state two rate charger recharges battery in 24 hours
- Removable directional indicators
- Custom message available
- Self-diagnostic option performs monthly, biannual, and annual tests to ensure reliable operation and meets electrical and life safety codes

## SPECIFICATIONS

- HOUSING** – 5VA flame retardant, UV stabilized polycarbonate in white, black or gray finish. High-impact resistant, UV stabilized polycarbonate clear lens. Corrosion resistant enclosure with engineering grade silicone gasket.
- ELECTRICAL** – Dual 120/277 voltage. 3.6W (3 LEDs x 1.2 watt) per head. 6V long life, maintenance free, rechargeable NiCd battery.
- MOUNTING** – Die-cast aluminum mounting canopy included for top or end mount. Universal KO pattern on back plate for wall mount. Knockouts provided for conduit feed applications.
- LISTINGS** –
  - UL 924 standard as an emergency light suitable for wet locations (0°C - +50°C).
  - Meets NFPA 101 Life Safety Code, NEC, OSHA, Local and State Codes.
  - Certified to CEC under Title 20 Regulations.
- WARRANTY** – 5-year limited warranty

## ORDERING EXAMPLE: EXIT/EM/W SF - R - WHT - OPTIONS - D

### ORDERING INFO

SERIES	NUMBER OF FACES	LETTER COLOR	HOUSING COLOR
EXIT/EM/W	SF Single Face	R Red	WHT Industry-standard white
	DF Double Face	G Green	BLK Black
			GRAY Gray with white faceplate

OPTIONS	VOLTAGE
TP Tamper-resistant hardware	D 120V/277V
COPY/SF Custom message, single face <sup>[1]</sup>	
COPY/DF Custom message, double face <sup>[2]</sup>	
CW Internal heater with battery blanket <sup>[3]</sup>	
RC Remote capable <sup>[4]</sup>	
SDT Self-diagnostic test	
PC2 Polycarbonate shield <sup>[5]</sup>	

### REMOTE HEADS: WETRHL - GRAY - OPTIONS - MV <sup>[6]</sup>

SERIES	HOUSING	HOUSING COLOR	OPTIONS	VOLTAGE
WETRHL Wet location single remote head, 8 LEDs	D Die-cast P Polycarbonate	BLK Black GRAY Gray	SDT For use with self-diagnostic test fixtures <sup>[7]</sup>	MV Multi-voltage <sup>[8]</sup>
WETDRHL Wet location dual remote head, 8 LEDs				

## NOTES

- Consult factory.
- Consult factory.
- For cold temperature applications -20°C - +50°.
- Up to 7.2W.
- Wall mount only. Ships separately. See page 2 for OPTIONS DETAILS.
- Optional. Ships separately. See page 2 for REMOTE HEAD DETAILS. Must specify RC option.
- Required when fixture is specified with SDT.
- For use with 3.6V, 6V, 9.6V, or 12V power source.

# EXIT/EM/W LED Exit & Emergency Light - Wet Location

## MOUNTING DETAILS

### WALL MOUNT BOLT CIRCLE PATTERN

Not to scale.

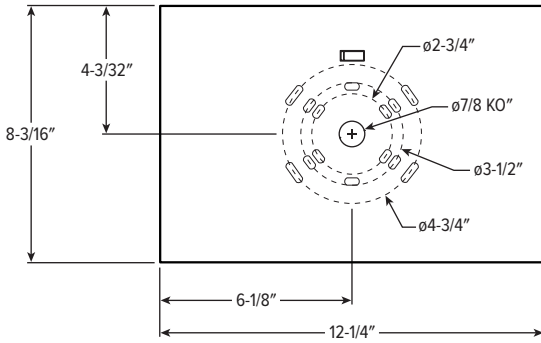

## REMOTE HEAD DETAILS

### WETRHL



DIMENSIONS: 4-1/2" x 6-5/8"

### WETDRHL



DIMENSIONS: 10-3/8" x 6-3/4"

## OPTIONS DETAILS

Wall mount only. Ships separately.

### PC2



DIMENSIONS: 15" x 22" x 7-3/4"