

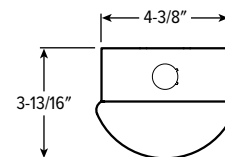

CATALOG #:

TYPE:

PROJECT:



FEATURES

- Ready to ship in 48 hours with on-hand inventory to support immediate job requirements
- Easy to install and service with long-lasting performance
- Provides uniform downward light distribution and subtle side illumination
- Diffuse acrylic lens enhances uniformity and minimizes glare
- Wireway is accessible without the use of tools
- High-performance up to 146 lm/W
- Quick-wire knockouts in back of fixture housing for easy attachment of incoming power supply
- All parts painted after fabrication to provide safe installation without gloves
- Made Right Here® in the USA

ORDERING INFO

| CATALOG NUMBER | LENGTH | LUMENS | CRI | CCT | SHIELDING | DRIVER | VOLTAGE | UPC CODE |
|----------------------------|--------|---------|-----|-------|------------------------|-----------------------|----------|--------------|
| NW-4-L54/840-RA-QS-DIM-UNV | 4' | 5,400lm | 80 | 4000K | Ribbed diffuse acrylic | Dimming driver, 0-10V | 120-277V | 850047638816 |
| NW-4-L54/850-RA-QS-DIM-UNV | | 5,400lm | | 5000K | | | | 850047638717 |
| NW-4-L74/850-RA-QS-DIM-UNV | | 7,400lm | | 5000K | | | | 850047638786 |

| ACCESSORY CATALOG NUMBER | DESCRIPTION | UPC CODE |
|--------------------------|--|--------------|
| EM/10W KIT-NC-QS | 10-watt emergency battery kit, no conduit ^[1] | 850047638670 |

SPECIFICATIONS

- HOUSING – 22-gauge die-formed C.R.S.
- SHIELDING – Linear ribbed diffuse acrylic.
- FINISH – 92% minimum average reflective white polyester powder coat bonded to phosphate-free, multi-stage pretreated metal. All parts painted after fabrication to facilitate installation, increase efficiency, and inhibit corrosion.
- ELECTRICAL – High-quality mid-power LED board. L80 > 72,000 hours per IES TM-21. 50/60 Hz constant current driver.
- MOUNTING – Surface or suspended.
- PACKAGING – One fixture per box, 90 per pallet.
- LISTINGS –
 - cCSAus certified as luminaire suitable for dry or damp locations.
 - DesignLights Consortium qualified product. Not all versions of this product may be DLC qualified, see the DLC Qualified Products List at designlights.org/QPL
 - Build America, Buy America (BABA) and Buy American Act (BAA) compliant. Request certification at hew.com/buy-american
 - WARRANTY – 5-year limited warranty, see hew.com/warranty

NOTES

- ¹ Ships separately, field installed. CEC compliant. EM battery and test switch field installed in fixture.





FIXTURE PERFORMANCE DATA

| CATALOG NUMBER | CCT | DELIVERED LUMENS | WATTAGE | EFFICACY (lm/W) |
|----------------------------|-------|------------------|---------|-----------------|
| NW-4-L54/840-RA-QS-DIM-UNV | 4000K | 5691 | 40.2 | 142 |
| NW-4-L54/850-RA-QS-DIM-UNV | 5000K | 5857 | 40.2 | 146 |
| NW-4-L74/850-RA-QS-DIM-UNV | 5000K | 7851 | 55.6 | 141 |

- Photometrics tested in accordance with IESNA LM-79. Results based on 80 CRI/3500K CCT, wattage for 120V input, and 25°C ambient temperature. Actual performance may vary +/-5%.
- To calculate lumen output in emergency mode, multiply the battery wattage by the efficacy.

DISTRIBUTION CURVE

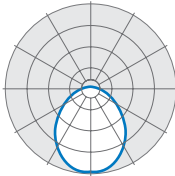

DIMENSIONS

BACK VIEW

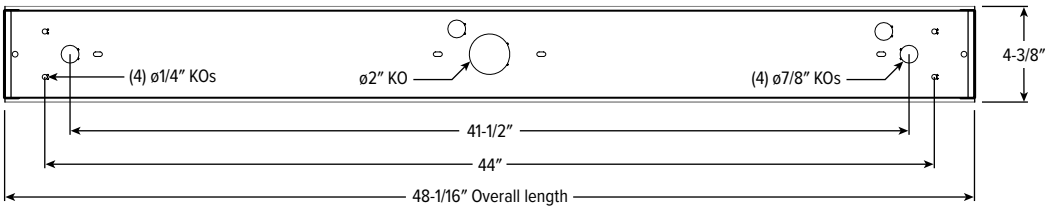

ACCESSORY DETAILS

EMERGENCY BATTERY KIT

