

CATALOG #: _____

TYPE: _____

PROJECT: _____

FEATURES

- Support human-centric design with adaptive, individualized lighting using tunable white light
- Shallow fixture depth for low ceiling applications
- Uniform ambient illumination
- Companion recessed and retrofit kit preserve continuity, see hew.com
- Maximize energy savings with efficacies up to 120 lm/W
- Heavy duty C.R.S. construction
- Made Right Here® in the USA

SPECIFICATIONS

- HOUSING – Precision die-formed 20-gauge C.R.S.
- REFLECTOR – Precision die-formed 22-gauge C.R.S. Highly reflective non-glare matte white polyester powder coat.
- SHIELDING – Diffuse ribbed acrylic.
- FINISH – Textured matte white polyester TGIC powder coat bonded to phosphate-free, multi-stage pretreated metal. All parts painted after fabrication to facilitate installation, increase efficiency, and inhibit corrosion.
- ELECTRICAL – High quality mid-power LED boards. L70 >50,000 hours per IES TM-21. Tunable White products use LEDs of multiple shade of white from single-CCT products at the same CCT. All CCTs are within 3 MacAdam ellipses.
- MOUNTING – Surface or suspended.
- LISTINGS – cCSAus certified as luminaire suitable for dry or damp locations.
- WARRANTY – 5-year limited warranty, see hew.com/warranty.

ORDERING EXAMPLE: PTS - 2 4 - L77/8TW - RA - OPTIONS - DALI - UNV

ORDERING INFO

| SERIES | WIDTH | LENGTH | LUMENS ^[1] | CRI | CCT | SHIELDING | |
|--------|---------------------|---------------------|-----------------------|---------------------|--------------------------------|----------------------------------|---------------------------------|
| PTS | 1 1' ^[2] | 2 2' ^[3] | 1x4 | 8 80 | TW Tunable white (3000K-5000K) | RA Diffuse ribbed acrylic, round | |
| | | 4 4' | L32 3,200lm | 9 90 ^[4] | | | TW2 Tunable white (2700K-6500K) |
| | 2 2' | 4 4' | L43 4,300lm | 2x2 | L29 2,900lm | L43 4,300lm | 2x4 |
| | | | L77 7,700lm | | | | |

| OPTIONS ^[6] | CONTROL ^[7] | VOLTAGE |
|--|--|--------------|
| EM/7W 7-watt emergency LED battery ^[8] | DALI Driver prewired for DALI applications | 120 120V |
| EM/7WRM Remote mount 7-watt emergency battery ^[9] | DIM (1) 0-10V signal to control dimming (1) 0-10V signal to control CCT | 277 277V |
| EM/10W 10-watt emergency battery ^[10] | DMX Driver prewired for DMX applications | UNV 120-277V |
| EM/10WLP Low-profile 10-watt emergency battery ^[11] | PSQ Lutron T-Series 2-channel tunable white 1%. | |
| EM/12W (L__) | | |
| AMW | | |

NOTES

- ¹ Lumen output based on 3500 CCT. Actual lumens may vary +/-5%, see page 2 for FIXTURE PERFORMANCE DATA.
- ² 4' length only.
- ³ 2' width only.
- ⁴ Extended lead times may apply. Consult factory for availability.
- ⁵ Increases lumen output by 3%.
- ⁶ Suspended mounting available. See page 3 for SUSPENDED MOUNTING DETAILS.
- ⁷ See page 3 for CONTROL DETAILS.
- ⁸ 2x2 and 2x4 only.
- ⁹ 1x4 only.
- ¹⁰ 2x2 & 2x4 only.
- ¹¹ 1x4 only.
- ¹² 2x2 & 2x4 only.
- ¹³ Specify in increments of 100 nominal lumens. Option must be specified with next higher lumen package.



FIXTURE PERFORMANCE DATA

| | LED PACKAGE | DELIVERED LUMENS | WATTAGE | EFFICACY (lm/W) |
|-----|-------------|------------------|---------|-----------------|
| 1x4 | L32 | 3292 | 27.4 | 120.3 |
| | L43 | 4319 | 37.1 | 116.4 |
| 2x2 | L29 | 2929 | 26.8 | 109.1 |
| | L43 | 4422 | 38.8 | 113.9 |
| 2x4 | L33 | 3423 | 28.6 | 119.9 |
| | L58 | 5878 | 52.6 | 111.8 |
| | L77 | 7716 | 65.0 | 118.8 |

- Photometrics tested in accordance with IESNA LM-79. Results shown are based on 25°C ambient temperature.
- Wattage shown is average for 120V through 277V input.
- Results based on 4000K, 80 CRI, actual lumens may vary +/-5%
- Use multiplier table to calculate additional options.

MULTIPLIER TABLE

| | | COLOR TEMPERATURE | | | |
|--------|-------|-------------------|---------|--------|---------|
| | CCT | TW | | TW2 | |
| | | LUMENS | WATTAGE | LUMENS | WATTAGE |
| 80 CRI | 2700K | - | - | 0.93 | 1.02 |
| | 3000K | 0.95 | 1.04 | 0.95 | 1.01 |
| | 3500K | 0.98 | 1.02 | 0.98 | 1.00 |
| | 4000K | 1.00 | 1.00 | 1.00 | 1.00 |
| | 5000K | 0.96 | 1.04 | 1.02 | 1.00 |
| | 6500K | - | - | 1.01 | 1.04 |
| 90 CRI | 2700K | - | - | 0.93 | 1.02 |
| | 3000K | 0.91 | 1.03 | 0.95 | 1.01 |
| | 3500K | 0.96 | 1.01 | 0.98 | 1.00 |
| | 4000K | 1.00 | 1.00 | 1.00 | 1.00 |
| | 5000K | 1.03 | 1.03 | 1.03 | 1.00 |
| | 6500K | - | - | 1.02 | 1.04 |

TW

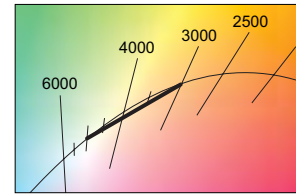

TW2

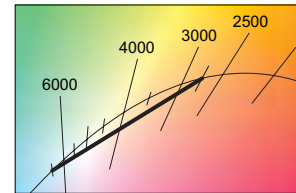

PHOTOMETRY

PTS-24-L77/8TW-RA-DALI Total Luminaire Output: 7716 lumens; 65 Watts | Efficacy: 119 lm/W | 82.7 CRI; 3494K CCT

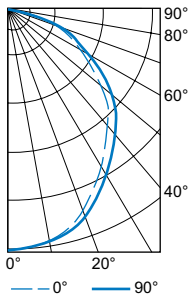

| VERTICAL ANGLE | HORIZONTAL ANGLE | | | ZONAL LUMENS |
|----------------|------------------|------|------|--------------|
| | 0° | 45° | 90° | |
| 0 | 2952 | 2952 | 2952 | |
| 5 | 2907 | 2903 | 2888 | 277 |
| 15 | 2822 | 2831 | 2843 | 793 |
| 25 | 2486 | 2519 | 2550 | 1148 |
| 35 | 2009 | 2073 | 2127 | 1294 |
| 45 | 1634 | 1724 | 1812 | 1320 |
| 55 | 1188 | 1300 | 1404 | 1166 |
| 65 | 769 | 912 | 1036 | 900 |
| 75 | 365 | 560 | 693 | 589 |
| 85 | 74 | 247 | 283 | 231 |
| 90 | 0 | 0 | 0 | |

| LUMEN SUMMARY | ZONE | LUMENS | % FIXTURE |
|---------------|---------|--------|-----------|
| | 0 - 30 | 2218 | 29 |
| | 0 - 40 | 3511 | 46 |
| | 0 - 60 | 5997 | 78 |
| | 0 - 90 | 7716 | 100 |
| | 0 - 180 | 7716 | 100 |

PTS-14-L43/8TW-RA-DALI Total Luminaire Output: 4319 lumens; 37 Watts | Efficacy: 116 lm/W | 84.9 CRI; 3544K CCT

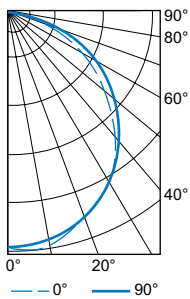

| VERTICAL ANGLE | HORIZONTAL ANGLE | | | ZONAL LUMENS |
|----------------|------------------|------|------|--------------|
| | 0° | 45° | 90° | |
| 0 | 1574 | 1574 | 1574 | |
| 5 | 1610 | 1592 | 1568 | 151 |
| 15 | 1538 | 1534 | 1516 | 431 |
| 25 | 1407 | 1414 | 1397 | 647 |
| 35 | 1224 | 1240 | 1241 | 769 |
| 45 | 977 | 1020 | 1035 | 778 |
| 55 | 699 | 768 | 801 | 683 |
| 65 | 448 | 531 | 545 | 508 |
| 75 | 199 | 279 | 291 | 284 |
| 85 | 31 | 50 | 59 | 70 |
| 90 | 0 | 0 | 0 | |

| LUMEN SUMMARY | ZONE | LUMENS | % FIXTURE |
|---------------|---------|--------|-----------|
| | 0 - 30 | 1228 | 28 |
| | 0 - 40 | 1997 | 46 |
| | 0 - 60 | 3457 | 80 |
| | 0 - 90 | 4319 | 100 |
| | 0 - 180 | 4319 | 100 |



CONTROL DETAILS

DIM

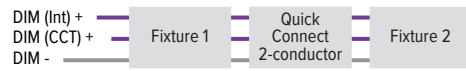

DMX



DALI



LUTRON T-SERIES



CROSS SECTIONS

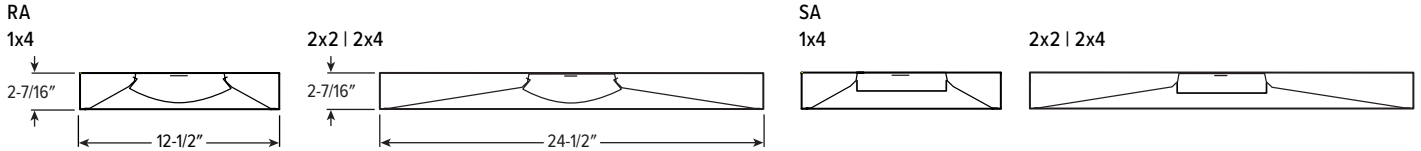

FIXTURE DETAILS

BACKVIEW

1x4

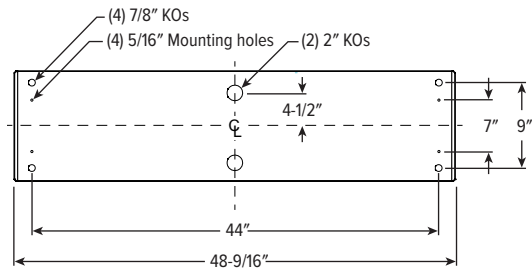

2x4

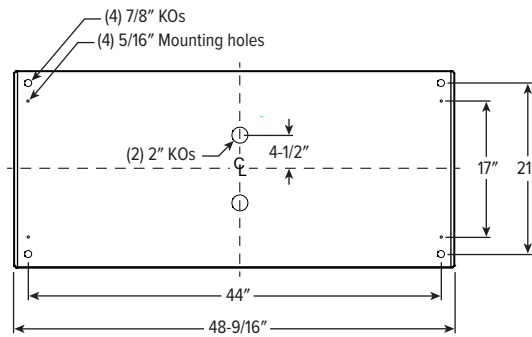

2x2

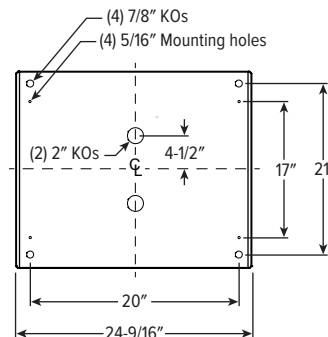

SUSPENDED MOUNTING DETAILS

AIRCRAFT CABLE

| ORDERING EXAMPLE: ACF*4P/D48 | | | |
|------------------------------|--|---------------------|----------|
| PREFIX | TYPE | LENGTH | |
| ACF*4P | Four point mount adjustable aircraft cable | D 1" grid & hardpan | 24 24" |
| | | N 9/16" grid | 48 48" |
| | | S Slot grid | 96 96" |
| | | | 144 144" |
| | | | 192 192" |
| | | 240 240" | |
| | | 300 300" | |

CORD OPTIONS

Units specified with aircraft cable require cord. Please specify cord type using ordering information below. Long fixture rows may require multiple feed points based on 18ga conductor size.

| EXAMPLE: S2438D/W | | | | |
|-------------------|--------|--------------------------|-----------|----------|
| CORD TYPE | LENGTH | # OF COND. ¹⁾ | WIRE SIZE | COLOR |
| S | 24 24" | 3 | 8D 18ga | /W White |
| | 48 48" | 4 | | /B Black |
| | 96 96" | 5 | | |
| | | 6 | | |

¹ Includes (2) 22ga purple & pink dimming conductors

STANDARD HARDWARE (Grid & Hardpan)

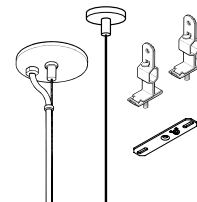

- Fixtures are provided with adjustable length aircraft cables and mounting hardware, must specify.
- One 5" canopy used at power feed location to cover the junction box. Three other suspension points use 2" canopy at the non-feed point. No J-box is required at non-feed points.

