

CurviLine (CV) Shown

CATALOG #: \_\_\_\_\_

Type: \_\_\_\_\_

PROJECT: \_\_\_\_\_

**FEATURES**

- Create scalable, highly functioning smart buildings with Platformatics Power over Ethernet controls
- Tunable white from 3000K to 5000K CCT, minimum 80 CRI
- Maximize energy savings with efficacies as high as 136 lm/W
- Architecturally styled cove creates a comfortable, low glare environment without cluttering the ceiling surface
- Heavy-duty hook-on mounting brackets make it easy to securely install and level fixtures
- Joiner and alignment system permit mounting in continuous rows with hairline seams that virtually disappear
- Made Right Here® in the USA

**ORDERING EXAMPLE: SMC CL - 4 - P50/840 - F / F - OPTIONS - POE PR**

**ORDERING INFO**

SERIES	STYLE	LENGTH	LUMENS <sup>[1]</sup>	CRI	CCT	FIXTURE TYPE
SMC	CL Classic	4 4'	4'	8 80	27 2700K	F Electrical feeder unit <sup>[2]</sup>
	CV CurviLine	8 8'	P30 3,000lm		30 3000K	J Joiner unit <sup>[3]</sup>
			P50 5,000lm		35 3500K	E End unit <sup>[4]</sup>
			P60 6,000lm		40 4000K	S Stand-alone unit <sup>[5]</sup>
				50 5000K		
				TW Tunable white (80 CRI, 3000K-5000K)		

**SPECIFICATIONS**

- HOUSING/REFLECTOR – Seam-welded extruded aluminum.
- WEIGHT – 5 lbs. per foot
- END CAPS – Aluminum, welded, seam-filled and finished at ends of individual units and rows.
- REFLECTIVE SURFACES – 92% minimum average reflective white polyester powder coat on interior steel components.
- SHIELDING – Frosted acrylic, .125" thick.
- FINISH – Textured matte white polyester TGIC powder coat bonded to phosphate-free, multi-stage pretreated metal. All parts painted after fabrication to facilitate installation, increase efficiency, and inhibit corrosion.
- ELECTRICAL – High quality mid-power LED boards. L70 >60,000 hours per IES TM-21. Low-voltage DC fixture, to be fed by Class 2 power supply. Tunable White products use LEDs of multiple CCTs and may produce a perceptibly different shade of white from single-CCT products at the same CCT. All CCTs are within 3 MacAdam ellipses.
- MOUNTING – Wall mount, individual units or continuous rows.
- LISTINGS –
  - cCSAus certified as luminaire suitable for dry or damp locations
- WARRANTY – 5-year limited warranty, see [hew.com/warranty](http://hew.com/warranty).

**END CAP STYLE**

- F Flat ends
- M Mitered ends <sup>[8]</sup>

**OPTIONS <sup>[6]</sup>**

- AMW Anti-microbial white finish

**CONTROL <sup>[7]</sup>**

- POE PR Power over Ethernet, Platformatics-ready

**SYSTEM REQUIREMENTS**

- PoE-ready luminaires are connected to building power systems through network integration and require other components for complete PoE lighting system
- For additional PoE info, see [hew.com/poe](http://hew.com/poe)
- Consult factory for design support



**NOTES**

- <sup>1</sup> Lumen output based on 4000K for single CCT and TW. Actual lumens may vary +/-5%, see page 2 for FIXTURE PERFORMANCE DATA.
- <sup>2</sup> Left end cap installed.
- <sup>3</sup> No end caps.
- <sup>4</sup> Right end cap installed.

- <sup>5</sup> Two end caps installed.
- <sup>6</sup> See page 3 for FINISH OPTIONS.
- <sup>7</sup> See page 3 for NODE CONNECTION DETAILS. For additional PoE info, see [hew.com/poe](http://hew.com/poe).
- <sup>8</sup> Increases overall length. See page 3 for FIXTURE DETAILS.



## FIXTURE PERFORMANCE DATA

### STANDARD

	LED PACKAGE	DELIVERED LUMENS	WATTAGE	EFFICACY (lm/W)
4'	P30	3030	23.8	127.3
	P50	5020	36.9	136.0
8'	P60	6009	44.4	135.3

### TUNABLE WHITE

	LED PACKAGE	DELIVERED LUMENS	WATTAGE	EFFICACY (lm/W)
4'	P30	3030	25.1	120.8
	P50	5028	41.7	120.7
8'	P60	6009	47.0	127.8

### MULTIPLIER TABLE

COLOR TEMPERATURE		
CCT	LUMENS	
	STANDARD	TUNABLE WHITE
2700K	0.94	-
3000K	0.96	0.95
3500K	0.97	0.98
4000K	1.00	1.00
5000K	1.03	0.96

- Photometrics tested in accordance with IESNA LM-79. Results shown are based on 25°C ambient temperature.
- Standard and tunable white results based on 4000K standard, 80 CRI, actual lumens may vary +/-5%
- Use multiplier table to calculate additional options.

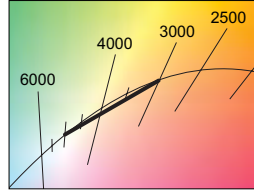

## PHOTOMETRY

SMCCL-4-P50/840-POE Total Luminaire Output: 5020 lumens; 36.9 Watts | Efficacy: 136 lm/W | 80 CRI; 4000K CCT

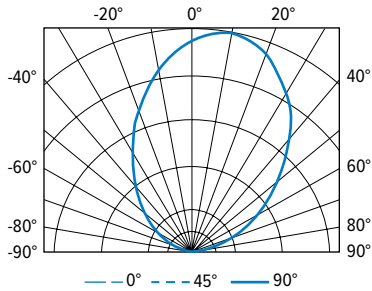

	VERTICAL ANGLE	HORIZONTAL ANGLE					ZONAL LUMENS
		0°	45°	90°	135°	180°	
CANDLEPOWER DISTRIBUTION	90	4	6	18	6	7	
	95	97	112	124	89	77	112
	105	336	339	304	229	198	305
	115	625	619	542	403	346	512
	125	978	962	840	628	545	716
	135	1384	1350	1164	892	794	868
	145	1775	1716	1502	1209	1086	914
	155	2066	2012	1796	1526	1413	815
	165	2269	2201	2024	1853	1778	569
	175	2271	2229	2174	2077	2083	205
	180	2192	2192	2192	2192	2192	

LUMEN SUMMARY	ZONE	LUMENS	% FIXTURE
	90-120	929	19
	90-130	1646	33
	90-150	3428	68
	90-180	5017	100
	0-180	5020	100

## CROSS SECTIONS

### CLASSICLINE (CL)

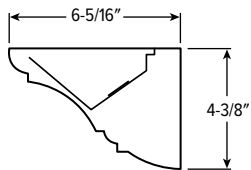

### CURVILINE (CV)

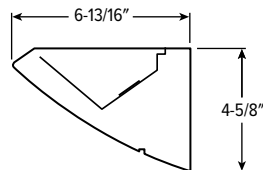

## FIXTURE DETAILS

### BACKVIEW

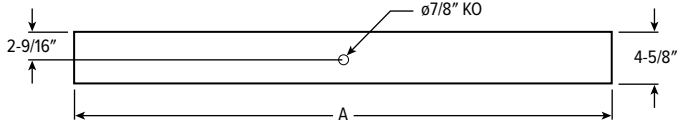

NOMINAL LENGTH	ACTUAL LENGTH (A)
4'	44-7/8"
8'	89-1/8"

Note: Mitered ends add to overall length, see details at right.

### MITERED END DETAILS

#### ClassicLine (CL)

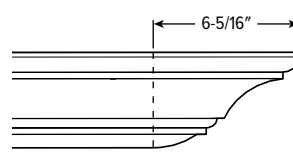

#### CurviLine (CV)

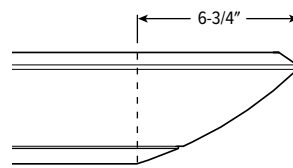

### WALL MOUNT BRACKET

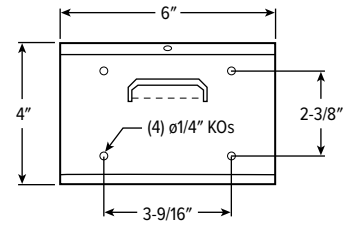

## FIXTURE TYPE DETAILS

	F	J	E	S
MITERED				
FLAT				

## FINISH OPTIONS

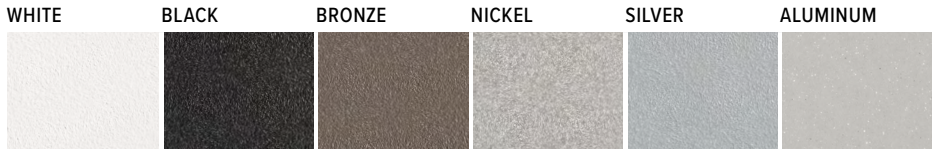

For custom color, please specify RAL code or a manufacturer code with description. All custom colors other than RAL require two sample swatches, minimum 1" square.

## NODE CONNECTION DETAILS

Includes 24" cable with 4-position mating connector for Platformatics POE-LN2 node. See node spec sheet for details: [platformatics.com/product/poe-ln2](http://platformatics.com/product/poe-ln2)

