

CATALOG #: _____

Type: _____

PROJECT: _____

FEATURES

- Quickly upgrade existing fluorescent strips to energy-saving LED
- Simple, toolless installation
- Fits any 3" - 5-1/4" wide existing strip housing
- Four distinct styles enhance any space
- Diffuse acrylic lens on SRKR and SRKS enhances uniformity and minimizes glare
- SRKA features innovative aisle optic for even illumination from floor to ceiling
- Heavy duty C.R.S. construction
- Made Right Here® in the USA

SPECIFICATIONS

- HOUSING – Provided by others, must be 3" - 5-1/4" wide.
- WIREWAY COVER – 22-gauge die-formed C.R.S.
- FINISH – 92% minimum average reflective white polyester powder coat bonded to phosphate-free, multi-stage pretreated metal. All parts painted after fabrication to facilitate installation, increase efficiency, and inhibit corrosion.
- ELECTRICAL – High quality mid-power LED boards. L70 >50,000 hours.
- MOUNTING – Toolless mounting brackets attach to existing strip channels from 3" to 5-1/4" wide.
- LISTINGS –
 - cCSAus classified as luminaire suitable for dry or damp locations.
- WARRANTY – 5-year limited warranty, see hew.com/warranty.

Note: H.E. Williams, Inc. recommends installing a trial fixture prior to ordering full project quantities.

ORDERING EXAMPLE: SRK - M 8 - L140/840 - OPTIONS - DRV - UNV

ORDERING INFO

SERIES ^[1]	WIDTH	LENGTH	LUMENS ^[2]	CRI	CCT
SRK Standard	N Narrow, 3" – 3-3/4"	4 4'	4'	8 80	30 3000K
SRKR Round Lens	M Medium, >3-3/4" – 4-1/2"	8 8' ^[3]	L31 3,100lm	9 90 ^[4]	35 3500K
SRKS Square Lens	W Wide, >4-1/2" – 5-1/4"		L52 5,200lm		40 4000K
SRKA Aisle Optics			L70 7,000lm		50 5000K
			8'		
			L63 6,300lm		
			L104 10,400lm		
			L140 14,000lm		

OPTIONS ^[5]

- EM/10WLP** Low-profile 10-watt emergency battery
- (L__)** Additional lower lumen packages available
Example: 9,000 lumens = SRK-8-L104/840-(L90) ^[7]
- (H__)** Additional housing heights available, must specify:
25 >2-1/4" – 2-3/4"
30 >2-3/4" – 3-1/4"
35 >3-1/4" – 3-3/4"

OCCUPANCY SENSORS ^[8]

- OCCSS SFR-7-120/277** Integral, factory-installed line voltage passive infrared low bay 360° sensor.
- OCCSS SFR-30-120/277** Integral, factory-installed line voltage passive infrared universal 360° sensor.

CONTROL ^[6]

- DIM** Dimming driver 120 120V
- DRV** Non-dimming driver 277 277V
- UNV** 120-277V 347 347V ^[9]

VOLTAGE

RETROFIT GUIDE

All assuming standard F032 T8 lamplng and 0.88 ballast factor, instant start T8 ballast.

FLUORESCENT	WATTAGE	LED	WATTAGE	SAVINGS
1 - 32W T8	30	SRK-4-L31	21	30%
2 - 32W T8	59	SRK-4-L52	34	42%
3 - 32W T8	85	SRK-4-L70	47	45%
2 - 32W T8	59	SRK-8-L63	43	28%
3 - 32W T8	112	SRK-8-L104	70	38%
4 - 32W T8	171	SRK-8-L140	94	45%

NOTES

- ¹ Fixture relies on existing housing and end plates, by others.
- ² Lumen output based on 4000 CCT. Actual lumens may vary +/-5%. See page 2 for FIXTURE PERFORMANCE DATA. Additional LED lumen packages available, see options.
- ³ Two 4' wireway covers. SRKR and SRKS ships with (2) 4' lenses.
- ⁴ Extended lead times may apply. Consult factory for availability.
- ⁵ See page 5 for OCCUPANCY SENSOR DETAILS.
- ⁶ See page 3 for ADDITIONAL CONTROL OPTIONS.
- ⁷ Specify in increments of 100 nominal lumens. Option must be specified with next higher lumen package.
- ⁸ 120V or 277V only; SRK and SRKA only. See page 5 for OCCUPANCY SENSOR DETAILS.
- ⁹ Not available with EM batteries.



FIXTURE PERFORMANCE DATA

SRK				
	LED PACKAGE	DELIVERED LUMENS	WATTAGE	EFFICACY (lm/W)
4'	L31	3116	21.4	145.8
	L52	5179	33.7	153.6
	L70	7015	47.2	148.8
8'	L63	6358	42.5	149.6
	L104	10358	67.4	153.6
	L140	14031	94.3	148.8
SRKR/SRKS ¹				
4'	L31	2954	20.2	146.5
	L52	4816	33.7	142.9
	L70	6536	47.1	138.7
8'	L63	6231	40.1	155.4
	L104	9632	67.4	142.9
	L140	13072	94.2	138.7
SRKA				
4'	L31	2922	20.2	144.9
	L52	4764	33.7	141.3
	L70	6441	47.2	135.8
8'	L63	5849	42.5	137.6
	L104	9529	67.4	141.3
	L140	12822	94.4	135.8

MULTIPLIER TABLE

COLOR TEMPERATURE		
	CCT	CONVERSION FACTOR
80 CRI	2700K	0.94
	3000K	0.96
	3500K	0.97
	4000K	1.00
	5000K	1.03
90 CRI	2700K	0.77
	3000K	0.79
	3500K	0.80
	4000K	0.83
	5000K	0.86

¹ SRKS shown

- Photometrics tested in accordance with IESNA LM-79. Results shown are based on 25°C ambient temperature.
- Wattage shown is average for 120V through 277V input.
- Results based on 4000K, 80 CRI, actual lumens may vary +/-5%
- Use multiplier table to calculate additional options.

PHOTOMETRY

SRK-M8-L140/840-DRV-UNV Report #: 19999.0; 08/08/17 | Total Luminaire Output: 14031 lumens; 94.3 Watts | Efficacy: 148.8 lm/W | 83 CRI; 4056K CCT

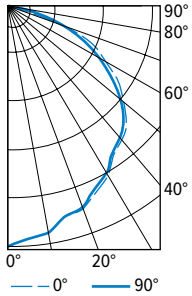

VERTICAL ANGLE	HORIZONTAL ANGLE			ZONAL LUMENS
	0°	45°	90°	
0	4947	4947	4947	
5	4814	4814	4812	459
15	4506	4495	4484	1275
25	4211	4193	4174	1941
35	3774	3735	3705	2348
45	3398	3342	3318	2595
55	2745	2695	2645	2417
65	1939	1876	1798	1859
75	951	890	860	951
85	176	174	167	187
90	13	22	24	

LUMEN SUMMARY	ZONE	LUMENS	% FIXTURE
	0 - 30	3674	26
	0 - 40	6022	43
	0 - 60	11035	79
	0 - 90	14031	100
	0 - 180	14031	100

SRKR-M8-L140/840-DRV-UNV Report #: 20000.0; 08/08/17 | Total Luminaire Output: 13143 lumens; 94.3 Watts | Efficacy: 139.4 lm/W | 83.4 CRI; 4069K CCT

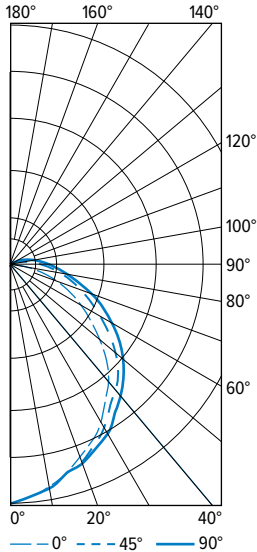

VERTICAL ANGLE	HORIZONTAL ANGLE			ZONAL LUMENS
	0°	45°	90°	
0	4521	4521	4521	
5	4395	4395	4400	420
15	4052	4077	4094	1156
25	3637	3720	3799	1722
35	3058	3228	3373	2021
45	2454	2797	3008	2141
55	1763	2216	2454	1944
65	1104	1616	1873	1537
75	512	1049	1229	1020
85	134	679	822	644
90	0	490	618	
95	0	380	506	346
105	0	158	266	144
115	0	18	114	42
125	0	0	22	7
135	0	0	0	0
145	0	0	0	0
155	0	0	0	0
165	0	0	0	0
175	0	0	0	0
180	0	0	0	

LUMEN SUMMARY	ZONE	LUMENS	% FIXTURE
	0 - 30	3297	25
	0 - 40	5318	41
	0 - 60	9403	72
	0 - 90	12603	96
	90 - 120	531	4
	90 - 150	539	4
	90 - 180	539	4
	0 - 180	13143	100



SRKS-M8-L140/840-DRV-UNV Report #: 20001.0; 08/08/17 | Total Luminaire Output: 13072 lumens; 94.2 Watts | Efficacy: 138.7 lm/W | 83.3 CRI; 4069K CCT

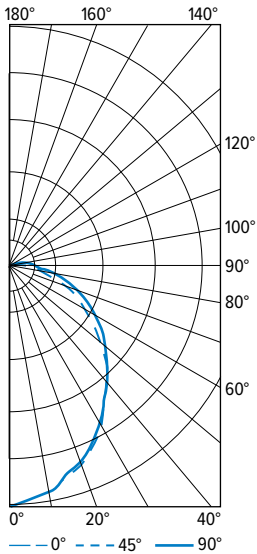

VERTICAL ANGLE	HORIZONTAL ANGLE			ZONAL LUMENS
	0°	45°	90°	
0	4796	4796	4796	
5	4677	4684	4677	446
15	4325	4310	4295	1223
25	3890	3873	3840	1792
35	3262	3240	3198	2032
45	2622	2655	2688	2058
55	1864	2024	2194	1822
65	1156	1466	1747	1453
75	538	943	1207	970
85	147	589	807	589
90	0	402	576	
95	0	349	495	329
105	0	226	352	208
115	0	108	237	108
125	0	22	119	39
135	0	0	24	2
145	0	0	0	0
155	0	0	0	0
165	0	0	0	0
175	0	0	0	0
180	0	0	0	

LUMEN SUMMARY	ZONE	LUMENS	% FIXTURE
	0 - 30	3461	27
	0 - 40	5493	42
	0 - 60	9374	72
	0 - 90	12385	95
	90 - 120	645	5
	90 - 150	687	5
	90 - 180	687	5
	0 - 180	13072	100

SRKA-M8-L140/840-DRV-UNV Report #: 20002.0; 08/08/17 | Total Luminaire Output: 12822 lumens; 94.4 Watts | Efficacy: 135.8 lm/W | 83.2 CRI; 4011K CCT

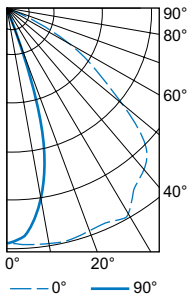

VERTICAL ANGLE	HORIZONTAL ANGLE			ZONAL LUMENS
	0°	45°	90°	
0	14175	14175	14175	
5	13784	13384	13035	1279
15	12766	9309	7037	2718
25	12762	4630	2308	2771
35	11349	1508	872	2106
45	9545	795	572	1614
55	5679	427	345	1081
65	2685	245	245	586
75	859	227	277	351
85	114	218	277	252
90	23	150	200	

LUMEN SUMMARY	ZONE	LUMENS	% FIXTURE
	0 - 30	6767	53
	0 - 40	8873	69
	0 - 60	11568	90
	0 - 90	12756	99
	0 - 180	12822	100

ADDITIONAL CONTROL OPTIONS

Note: Lumen restrictions apply, consult product builder at hew.com/product-builder.

CATALOG NUMBER	DESCRIPTION
DRV	Driver prewired for non-dimming applications
DIM	Dimming driver prewired for 0-10V low voltage applications
DIM1	1% dimming driver prewired for 0-10V low voltage applications
DIM LINE	Line voltage dimming driver (TRIAC and ELV compatible, 120V only)
DIM TRC	Line voltage dimming driver (TRIAC compatible, 120V only)
SD40	40% step-dimming driver
SD50	50% step-dimming driver
DALI	DALI dimming driver
LTE LINE	Lutron Hi-lume 1% 2-wire dimming driver forward phase line voltage controls (120V only)
LDE1	Lutron Hi-lume 1% EcoSystem dimming LED driver
ELDO SOLOB	EldoLED Solodrive, 0.1% dimming driver for 0-10V controls
ELDO SOLOB DALI	EldoLED Solodrive, 0.1% dimming driver for DALI controls
ELDO ECO1	EldoLED Ecodrive, 1% dimming driver for 0-10V controls
ELDO ECO1 DALI	EldoLED Ecodrive, 1% dimming driver for DALI controls



CROSS SECTIONS

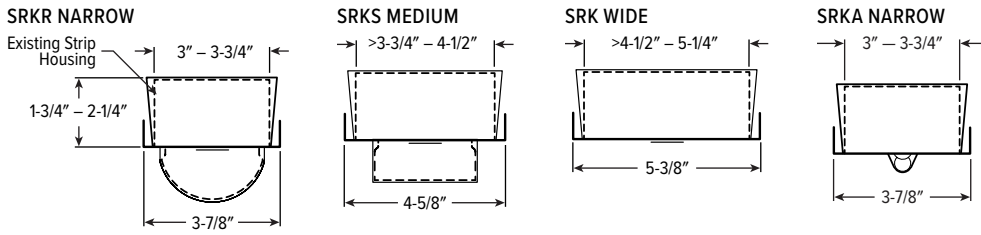

FIXTURE STYLES

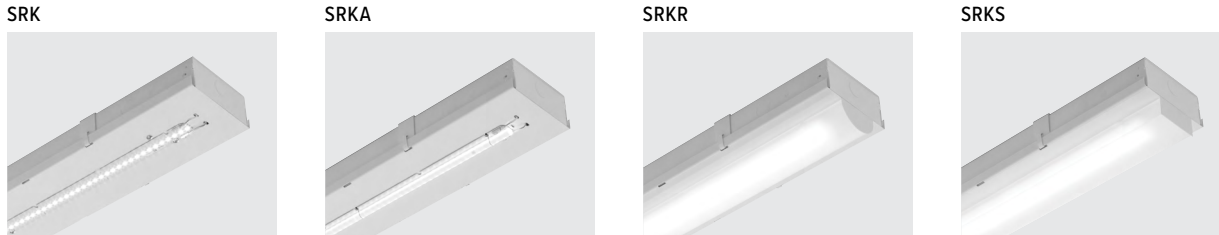

FIXTURE DETAILS

MOUNTING BRACKET LOCATIONS

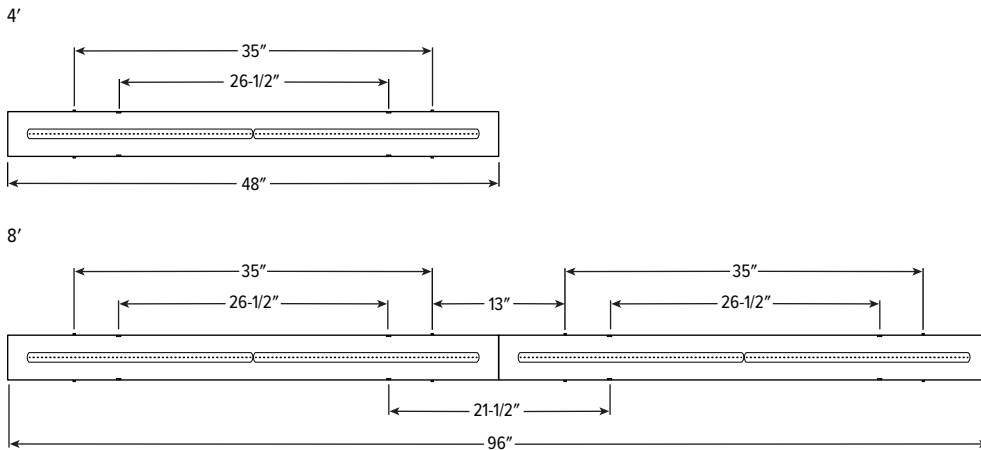

BRACKET INSTALLATION

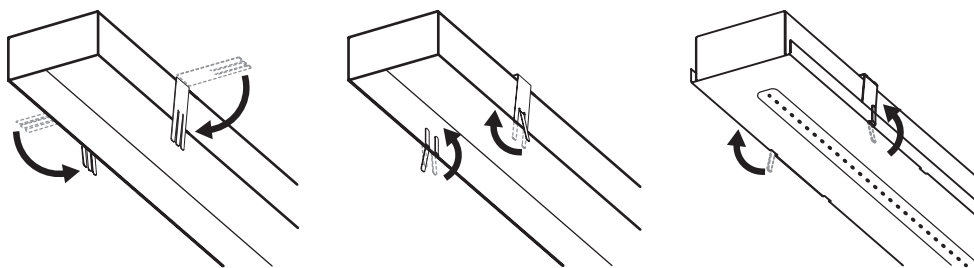

OCCUPANCY SENSOR DETAILS

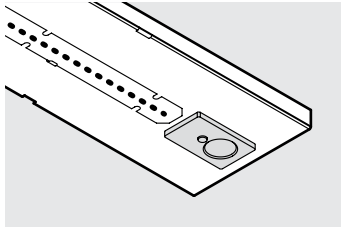

OCCSS SFR-7-120/277 OCCSS SFR-30-120/277

FEATURES

- Line voltage passive infrared (PIR).
- Self-contained relay, no power pack needed.
- No minimum load requirements.
- Interchangeable hot & load wires.
- Push-button programmable.
- Adjustable time delays.
- No field calibration or sensitivity adjustments required.
- Convenient test mode.
- 100 hr lamp burn-in timer.
- Adjustable time delay (30 seconds to 30 minutes).
- Factory set to 10 minutes.

COVERAGE PATTERNS

OCCSS SFR-7-120/277 Low bay 360° sensor

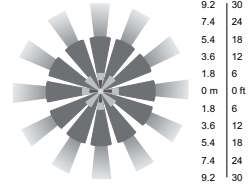

OCCSS SFR-30-120/277 Universal 360° sensor

