

# V4DR dim to WARM

## 4.5" Vandal-Resistant Downlight – Round

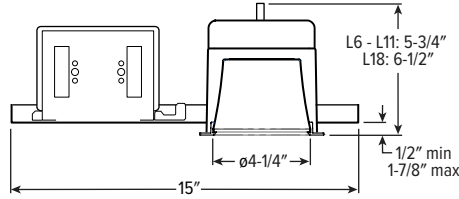

CATALOG #: \_\_\_\_\_

TYPE: \_\_\_\_\_

PROJECT: \_\_\_\_\_

ORDERING EXAMPLE: **V4DR - L11/9DW - OPTIONS - DIM1 - UNV - LW - OF - WH - TRIM OPTIONS - N - F1**

### HOUSING

SERIES	LUMENS <sup>[1]</sup>	COLOR	OPTIONS	CONTROL	VOLTAGE
V4DR	L6 600lm L11 1,100lm L18 1,800lm	9DW Dim to warm (95 CRI, 1800K – 3000K)	ATH Airtight construction F Fuse EM/7W 7-watt emergency battery <sup>[2]</sup> EM/10W 10-watt emergency battery <sup>[3]</sup> CP Chicago plenum (CCEA) <sup>[4]</sup> SDT Stepdown transformer <sup>[5]</sup> TC Thick ceiling construction <sup>[6]</sup>	DIM1 1% dimming driver (0-10V signal to control dimming and CCT) LUT Lutron Ecosystem enabled <sup>[7]</sup>	UNV 120-277V 347 347V <sup>[8]</sup>

### TRIM

TRIM TYPE	DISTRIBUTION <sup>[9]</sup>	FLANGE TYPE	REFLECTOR FINISH	TRIM OPTIONS
L Flush lens R Regressed lens	W Wide 50° Flush 50° Regressed M Medium 35° Flush 30° Regressed N Narrow 25° Flush 25° Regressed	OF 1/2" standard flange	CS Clear semi-specular powder coat WH White texture powder coat BL Black texture powder coat MB Black texture splay with white flange <sup>[10]</sup>	MWT Textured white trim flange <sup>[11]</sup> IP IP65 rated trim PD Diffuse 1/8" polycarbonate lens <sup>[12]</sup> WET/CC Wet location, covered ceiling listed AM Anti-microbial <sup>[13]</sup>

### MOUNTING

MOUNTING TYPE <sup>[14]</sup>	MOUNTING HARDWARE <sup>[15]</sup>
N Open pan for new construction I IC-rated enclosure for new construction <sup>[16]</sup>	F1 Integral 2-position fixed pan bracket, universal bar hanger included <sup>[17]</sup> BA1 Adjustable butterfly pan bracket, bar hanger not included <sup>[18]</sup> CA1 Adjustable caterpillar pan bracket, universal bar hanger included <sup>[19]</sup>

### ACCESSORIES

TPTX-10 TOOL T10 torx bit 1/4" drive tamper-resistant tool. <sup>[20]</sup>

### NOTES

- Lumen output based on full light output, L trim type, W distribution and WH finish, 3500K/95CRI. Actual lumens may vary +/-5%, see page 2 for FIXTURE PERFORMANCE DATA.
- N and R Mounting Types only.
- N and R Mounting Types only.
- I Mounting Type required.
- May be required for 347V, see product builder at [hew.com/product-builder](http://hew.com/product-builder)
- Required for ceiling thicknesses greater than 1-1/4"
- Not available with I Mounting Type.
- Not available with EM batteries.
- Beam angle based on WH reflector finish.
- R Trim Type only. Not available with MWT.
- Not available with WH Reflector Finish or L Trim Type.
- W distribution only.
- WH and BL Reflector Finishes only.
- Mounting hardware required ordered separately, see MOUNTING HARDWARE ordering info. See page 3 for MOUNTING TYPE DETAILS.
- Additional mounting hardware options available. See page 4 for MOUNTING HARDWARE DETAILS.
- L6 and L11 lumen packages max.
- I Mounting requires external brackets.
- N Mounting Type only.
- N Mounting Type only.
- Tamper-resistant tool must be ordered separately. Please specify quantity required per project.

# V4DR dim to WARM 4.5" Vandal-Resistant Downlight – Round

## FEATURES

- Dim to warm from 1800K to 3000K CCT, minimum 95 CRI
- Ideal for schools, behavioral health facilities, correctional institutions, and other vandal-prone areas
- Anti-ligature design with tamper-resistant fasteners
- Accepted by the New York State Office of Mental Health for use in inpatient facilities
- IP65-rated die-cast trim includes easy-to-clean flush lens
- Beam angles ranging from 25° narrow to 50° wide for tailored performance
- 4 inch aperture is unobtrusive in small scale spaces
- Die-cast trim choices include flush or regressed lens
- Contemporary design provides glare-free illumination for a soft ceiling appearance
- Easily adjust mounting arms below ceiling to adapt to a range of ceiling thicknesses

## SPECIFICATIONS

- HOUSING – Die-cast aluminum trim housing with forged aluminum heat sink. Galvanized steel splice compartment with driver mounting plate/enclosure. Swing-out mounting arms field adjust for ceiling thickness from 1/2" – 1-7/8" max. TC option required for ceiling thicknesses greater than 1-1/4".
- LENSED TRIM – Die-cast aluminum frame with 1/8" micro-prismatic, polycarbonate lens with 1/8" clear polycarbonate underlay. Trim is secured with four stainless steel, tamper-resistant screws.
- ELECTRICAL – High-performance Class 2 C.O.B. LED array. Modular quick-connect plug for easy field-connection of LED light assembly to driver. Reported L70>55,000 hours. Reported L90>55,000 hours. Estimated L70 = 200,000 hours.
- MOUNTING – Recessed. 20 ga. galvanized steel mounting pan for new construction or IC-rated enclosure.

- LISTINGS –
  - cCSAus conforms to UL STD 1598; Certified to CAN/CSA STD C22.2 No. 250.0 for dry and damp locations. LED light assembly conforms to UL 2108 for remote installation.
  - Suitable for wet location under covered ceiling when specified with WET/CC option.
  - IC-rated for direct contact with insulation when specified with I Mounting Type.
  - ISO 5, Class 100 rated.
  - City of Chicago Environmental Air approved when specified with CP option.
  - Complies with ASTM-E283 when specified with ATH option.
  - RoHS compliant.
- WARRANTY – 5-year limited warranty, see [hew.com/warranty](http://hew.com/warranty).

## FIXTURE PERFORMANCE DATA

### FLUSH LENS TRIM TYPE

	DIST.	DELIVERED LUMENS	CCT AT 100% (FULL OUTPUT)	CCT AT 1% (FULL DIM)	WATTAGE	EFFICACY (lm/W)
L6	W	610	3000K	1800K	14.0	43.6
	M	692			14.0	49.4
	N	696			14.0	49.7
L11	W	1069	3000K	1800K	23.4	45.7
	M	1213			23.4	51.8
	N	1130			23.4	48.3
L18	W	1752	3000K	1800K	37.7	46.5
	M	1815			37.7	48.1
	N	1999			37.7	53.0

### REGRESSED LENS TRIM TYPE

	DIST.	DELIVERED LUMENS	CCT AT 100% (FULL OUTPUT)	CCT AT 1% (FULL DIM)	WATTAGE	EFFICACY (lm/W)
L6	W	617	3000K	1800K	14.0	44.1
	M	694			14.0	49.6
	N	700			14.0	50.0
L11	W	1081	3000K	1800K	23.4	46.2
	M	1217			23.4	52.0
	N	1227			23.4	52.4
L18	W	1770	3000K	1800K	37.7	46.9
	M	1817			37.7	48.2
	N	2009			37.7	53.3

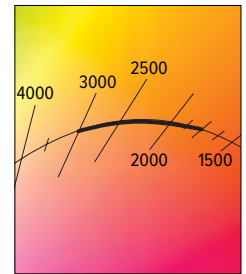

- Photometrics tested in accordance with IESNA LM-79. Results shown are based on 25°C ambient temperature.
- Wattage shown is based on 120V input.
- Results based on 3000K, 95 CRI, full output, actual lumens may vary +/-5%
- Use multiplier table to calculate additional options.

### MULTIPLIER TABLE

TRIM	
CATALOG NUMBER	CONVERSION FACTOR
PD	0.85

R TRIM	REFLECTOR FINISH	
	CATALOG NUMBER	CONVERSION FACTOR
	WH	1.00
BL	0.79	
CS	0.98	

## PHOTOMETRY

V4DR-L11/9DW-DIM1-UNV-LW-OF-WH Total Luminaire Output: 1069 lumens; 23.4 Watts | Efficacy: 45.7 lm/W | 95 CRI; 3000K CCT

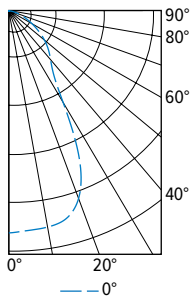

CANDLEPOWER DISTRIBUTION	VERTICAL ANGLE	HORIZONTAL ANGLE	ZONAL LUMENS
		0°	
	0	751	
	5	746	71
	15	731	205
	25	571	253
	35	266	172
	45	191	147
	55	127	114
	65	69	69
	75	29	31
	85	5	7
	90	0	

LUMEN SUMMARY	ZONE	LUMENS	% FIXTURE
	0 - 40	702	66
	0 - 60	962	90
	0 - 90	1069	100
	0-180	1069	100



# V4DR dim to WARM 4.5" Vandal-Resistant Downlight – Round

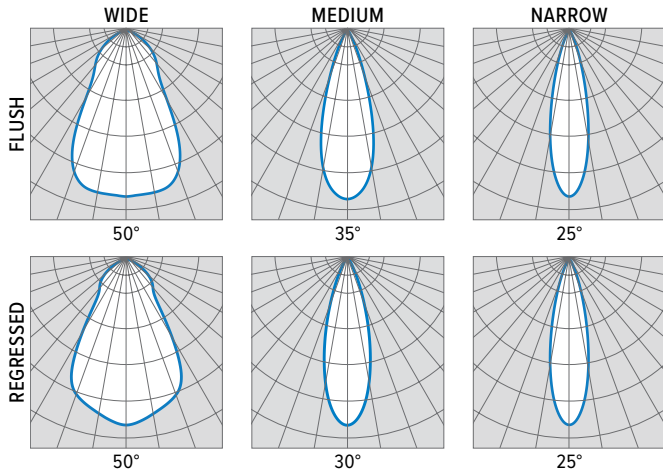

## TRIM TYPE DETAILS

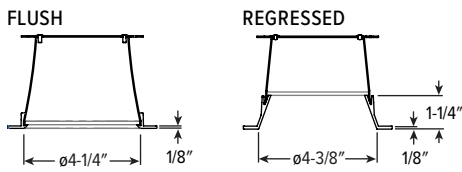

## FLANGE TYPE DETAILS

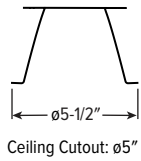

## REFLECTOR FINISH DETAILS



## MOUNTING TYPE DETAILS

### NEW CONSTRUCTION

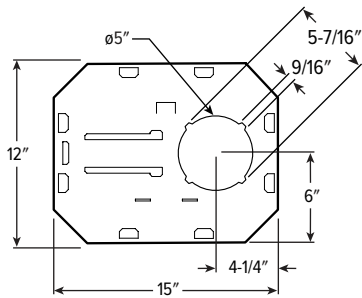

### IC-RATED

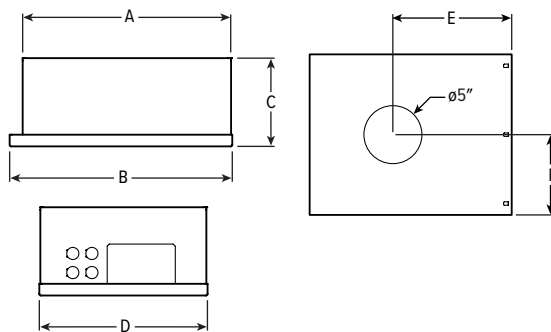

LUMENS	LENGTH					
	A	B	C	D	E	F
L6	15-3/16"	16"	6-3/8"	12-1/8"	9-1/2"	6-1/16"
L11	16-5/8"	17-1/2"	7-7/8"	14"	10-1/4"	7"



# V4DR dim to WARM 4.5" Vandal-Resistant Downlight – Round

## MOUNTING HARDWARE DETAILS

**F1** Integral 2-position fixed pan bracket, universal bar hanger included

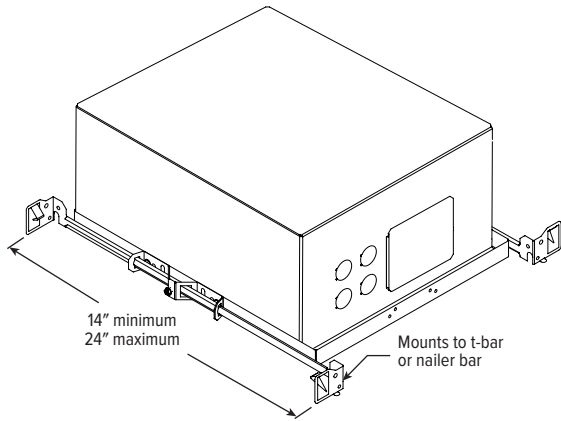
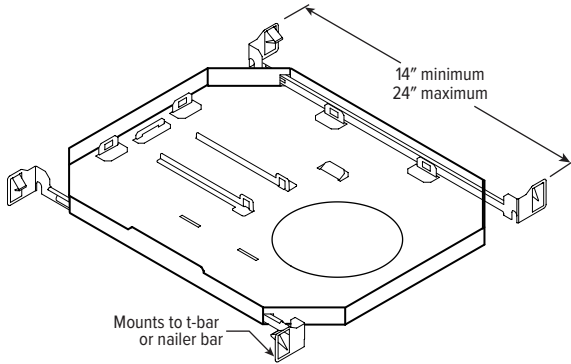

F1 with I Mounting Type

**BA1** Adjustable butterfly pan bracket, bar hanger not included (N Mounting Type only)

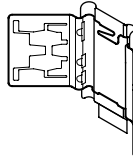

**BA2** Adjustable butterfly pan bracket, heavy-duty universal bar hanger included (N Mounting Type only)

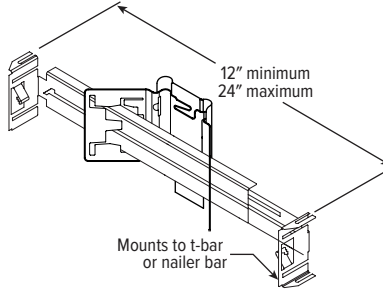

**CA1** Adjustable caterpillar pan bracket, universal bar hanger included (N Mounting Type only)

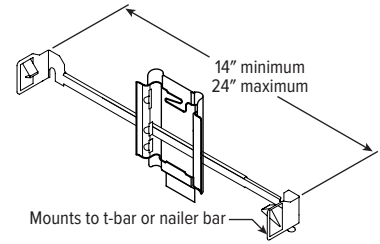

**CA2** Adjustable caterpillar pan bracket, t-bar hanger included (N Mounting Type only)

