

V4DR PoE | tunable **WHITE** 4.5" Vandal-Resistant Downlight – Round

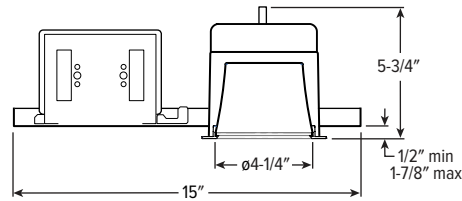
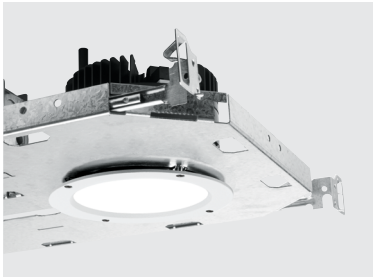

CATALOG #: _____

TYPE: _____

PROJECT: _____



FEATURES

- Deliver scalable, data-driven smart buildings with PoE-enabled fixtures and controls
- Accepted by the New York State Office of Mental Health for use in inpatient facilities
- Anti-ligature design with tamper-resistant fasteners

SPECIFICATIONS

- HOUSING** – Die-cast aluminum trim housing with forged aluminum heat sink. Galvanized steel splice compartment with driver mounting plate/enclosure. Swing-out mounting arms field adjust for ceiling thickness from 1/2" – 1-7/8" max. TC option required for ceiling thicknesses greater than 1-1/4".
- LENSED TRIM** – Die-cast aluminum frame with 1/8" micro-prismatic, polycarbonate lens with 1/8" clear polycarbonate underlay. Trim is secured with four stainless steel, tamper-resistant screws
- ELECTRICAL** – High-performance Class 2 LED array. Modular quick-connect plug for easy field-connection of LED light assembly to driver. Reported L70>50,000 hours. Low-voltage DC fixture, to be fed by Class 2 power supply. Tunable White products use LEDs of multiple CCTs and may produce a perceptibly different shade of white from single-CCT products at the same CCT. All CCTs are within 3 MacAdam ellipses.
- MOUNTING** – Recessed. 20 ga. galvanized steel mounting pan for new construction or IC-rated enclosure.
- LISTINGS** –
 - cCSAus conforms to UL STD 1598; Certified to CAN/CSA STD C22.2 No. 250.0 for dry and damp locations. LED light assembly conforms to UL 2108 for remote installation.
 - Suitable for wet location under covered ceiling when specified with WET/CC option.
 - IC-rated for direct contact with insulation when specified with I Mounting Type.
 - ISO 5, Class 100 rated.
 - City of Chicago Environmental Air approved when specified with CP option.
 - Complies with ASTM-E283 when specified with ATH option.
 - RoHS compliant.
 - Complies with the Buy American Act and other federal regulations. Request certification at hew.com/baa.
- WARRANTY** – 5-year limited warranty, see hew.com/warranty.

SYSTEM REQUIREMENTS

- PoE-ready luminaires are connected to building power systems through network integration and require other components for complete PoE lighting system.
- For additional PoE info, see hew.com/poe

ORDERING EXAMPLE: V4DR - P23/835 - OPTIONS - POE PR - LW - OF - WH - TRIM OPTIONS - N - F1

HOUSING

SERIES	LUMENS ^[1]	CRI	CCT	OPTIONS	CONTROL ^[2]
V4DR	P8 800lm	8 80	27 2700K	ATH Airtight construction	POE PR Power over Ethernet-ready
	P12 1,200lm	9 90 ^[3]	30 3000K	CP Chicago plenum (CCEA) ^[4]	
	P17 1,700lm		35 3500K	TC Thick ceiling construction ^[5]	
	P23 2,300lm		40 4000K		
	P32 3,200lm		50 5000K		
			TW Tunable white (80 CRI, 2700K–5000K)		

TRIM

TRIM TYPE	DISTRIBUTION ^[6]	FLANGE TYPE	REFLECTOR FINISH	TRIM OPTIONS
L Flush lens	W Wide	OF 1/2" standard flange	CS Clear semi-specular powder coat	MWT Textured white trim flange ^[10]
R Regressed lens	50° Flush		WH White texture powder coat	IP IP65 rated trim
	50° Regressed		BL Black texture powder coat	PD Diffuse 1/8" polycarbonate lens ^[11]
	M Medium ^[7]		MB Black texture splay with white flange ^[9]	WET/CC Wet location, covered ceiling listed
	35° Flush			AM Anti-microbial ^[12]
	30° Regressed			
	N Narrow ^[8]			
	25° Flush			
	25° Regressed			

MOUNTING

MOUNTING TYPE ^[13]	MOUNTING HARDWARE ^[14]
N Open pan for new construction	F1 Integral 2-position fixed pan bracket, universal bar hanger included ^[16]
I IC-rated enclosure for new construction ^[15]	BA1 Adjustable butterfly pan bracket, bar hanger not included ^[17]
	CA1 Adjustable caterpillar pan bracket, universal bar hanger included ^[18]

ACCESSORIES

TPTX-10 TOOL T10 torx bit 1/4" drive tamper-resistant tool. ^[19]

NOTES

- Static white lumen output based on L trim type, W distribution, WH finish, 80 CRI/3500K CCT. Actual performance may vary +/-5%, see page 2 for FIXTURE PERFORMANCE DATA.
- For additional PoE connection details, consult factory.
- Extended lead times may apply. Consult factory for availability. Not available with Tunable White.
- I Mounting Type required.
- Required for ceiling thicknesses greater than 1-1/4"
- Beam angle based on WH reflector finish.
- Not available with P32 lumen package.
- Not available with P32 lumen package.
- R Trim Type only. Not available with MWT.
- Not available with WH Reflector Finish or L Trim Type.

- W distribution only.
- WH and BL Reflector Finishes only.
- Mounting hardware required, ordered separately, see MOUNTING HARDWARE ordering info. See page 3 for MOUNTING TYPE DETAILS.
- Additional mounting hardware options available. See page 4 for MOUNTING HARDWARE DETAILS.
- P8 and P12 lumen packages only. P17 available, W distribution only.
- I Mounting requires external brackets.
- N Mounting Type only.
- N Mounting Type only.
- Tamper-resistant tool must be ordered separately. Please specify quantity required per project.



V4DR PoE | tunable **WHITE** 4.5" Vandal-Resistant Downlight – Round

FIXTURE PERFORMANCE DATA

STATIC WHITE

FLUSH LENS TRIM TYPE

	DIST.	DELIVERED LUMENS	WATTAGE	EFFICACY (lm/W)
P8	W	823	11.5	71.6
	M	1092	11.5	95.0
	N	1115	11.5	97.0
P12	W	1164	17.5	66.5
	M	1544	17.5	88.2
	N	1578	17.5	90.2
P17	W	1654	23.2	71.3
	M	2195	23.2	94.6
	N	2243	23.2	96.7
P23	W	2277	34.0	67.0
	M	3022	34.0	88.9
	N	3088	34.0	90.8
P32	W	3171	46.6	68.0
	M	–	–	–
	N	–	–	–

TUNABLE WHITE

FLUSH LENS TRIM TYPE

	DIST.	DELIVERED LUMENS	WATTAGE	EFFICACY (lm/W)
P8	W	750	11.6	64.7
	M	995	11.6	85.8
	N	1016	11.6	87.6
P12	W	1195	17.5	68.3
	M	1586	17.5	90.6
	N	1620	17.5	92.6
P17	W	1597	22.6	70.7
	M	2119	22.6	93.8
	N	2165	22.6	95.8
P23	W	2331	34.6	67.4
	M	3093	34.6	89.4
	N	3160	34.6	91.3
P32	W	2781	42.5	65.4
	M	–	–	–
	N	–	–	–

MULTIPLIER TABLES

COLOR TEMPERATURE		
CCT	LUMENS	
	STANDARD	TUNABLE WHITE
80 CRI	2700K	0.92
	3000K	0.98
	3500K	1.00
	4000K	1.01
	5000K	1.02

90 CRI	2700K	0.76	–
	3000K	0.79	–
	3500K	0.82	–
	4000K	0.84	–
	5000K	0.88	–

TRIM	
CATALOG NUMBER	CONVERSION FACTOR
PD	0.85

REFLECTOR FINISH		
CATALOG NUMBER	CONVERSION FACTOR	
R TRIM	WH	1.00
	BL	0.79
	CS	0.98

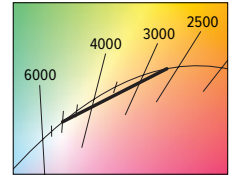

- Photometrics tested in accordance with IESNA LM-79. Results based on L trim type, W distribution, WH finish, and 25°C ambient temperature. Static white based on 80 CRI/3500K CCT. Tunable white based on 80 CRI/4000K CCT. Actual performance may vary +/-5%.
- Use multiplier tables to calculate additional options.

REGRESSED LENS TRIM TYPE

	DIST.	DELIVERED LUMENS	WATTAGE	EFFICACY (lm/W)
P8	W	806	11.5	70.1
	M	1093	11.5	95.0
	N	1077	11.5	93.7
P12	W	1140	17.5	65.1
	M	1546	17.5	88.3
	N	1524	17.5	87.1
P17	W	1620	23.2	69.8
	M	2198	23.2	94.7
	N	2166	23.2	93.4
P23	W	2230	34.0	65.6
	M	3026	34.0	89.0
	N	2982	34.0	87.7
P32	W	3106	46.6	66.7
	M	–	–	–
	N	–	–	–

REGRESSED LENS TRIM TYPE

	DIST.	DELIVERED LUMENS	WATTAGE	EFFICACY (lm/W)
P8	W	734	11.6	63.3
	M	996	11.6	85.9
	N	981	11.6	84.6
P12	W	1170	17.5	66.9
	M	1588	17.5	90.7
	N	1565	17.5	89.4
P17	W	1564	22.6	69.2
	M	2121	22.6	93.8
	N	2091	22.6	92.5
P23	W	2283	34.6	66.0
	M	3097	34.6	89.5
	N	3052	34.6	88.2
P32	W	2723	42.5	64.1
	M	–	–	–
	N	–	–	–

PHOTOMETRY

V4DR-P23/835-POE PR-LW-OF-WH Total Luminaire Output: 2277 lumens; 34 Watts | Efficacy: 67.0 lm/W | 80CRI; 3500K CCT

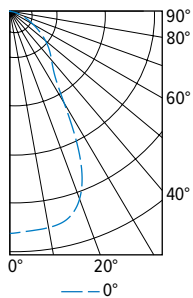

CANDLEPOWER DISTRIBUTION	VERTICAL ANGLE	HORIZONTAL ANGLE	ZONAL LUMENS
		0°	
	0	1600	
	5	1589	152
	15	1558	436
	25	1216	539
	35	566	367
	45	407	313
	55	271	242
	65	146	146
	75	62	67
	85	11	14
	90	0	

LUMEN SUMMARY	ZONE	LUMENS	% FIXTURE
	0 - 40	1495	66
	0 - 60	2050	90
	0 - 90	2277	100
	0-180	2277	100



V4DR

PoE | tunable WHITE

4.5" Vandal-Resistant Downlight – Round

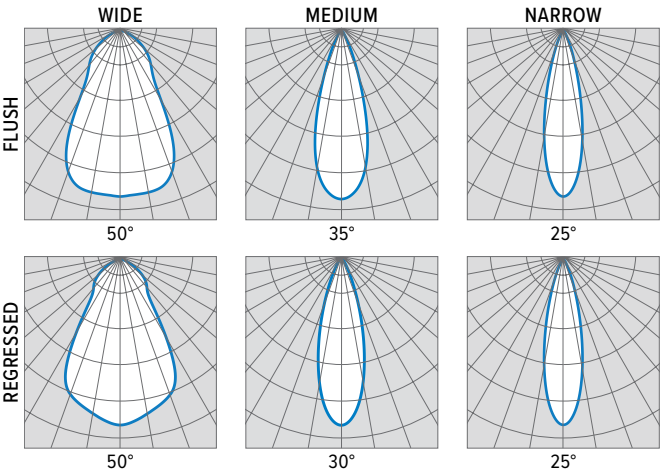

TRIM TYPE DETAILS

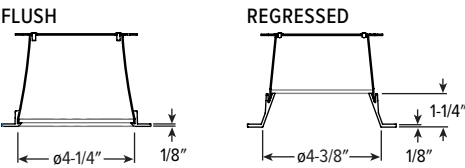

FLANGE TYPE DETAILS

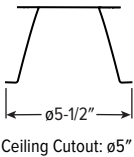

REFLECTOR FINISH DETAILS



MOUNTING TYPE DETAILS

NEW CONSTRUCTION

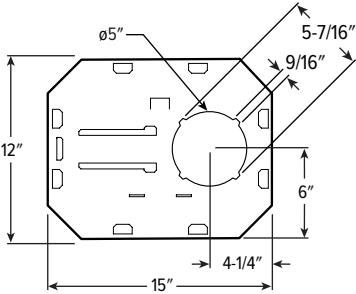

IC-RATED

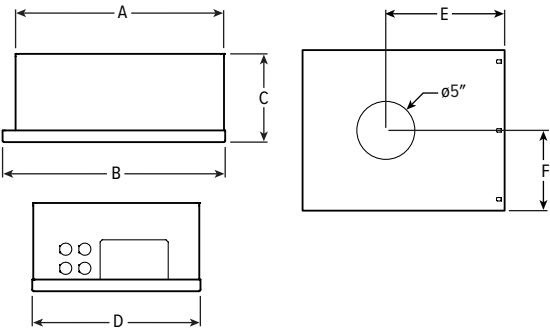

LUMENS	LENGTH					
	A	B	C	D	E	F
P8	15-3/16"	16"	6-3/8"	12-1/8"	9-1/2"	6-1/16"
P17	16-5/8"	17-1/2"	7-7/8"	14"	10-1/4"	7"

V4DR PoE | tunable **WHITE** 4.5" Vandal-Resistant Downlight – Round

MOUNTING HARDWARE DETAILS

F1 Integral 2-position fixed pan bracket, universal bar hanger included

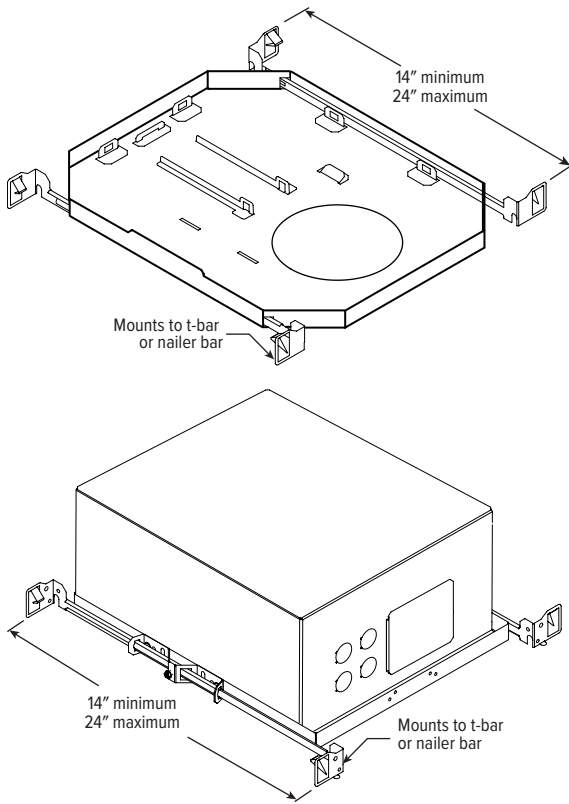

F1 with I Mounting Type

BA1 Adjustable butterfly pan bracket, bar hanger not included (N Mounting Type only)

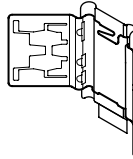

BA2 Adjustable butterfly pan bracket, heavy-duty universal bar hanger included (N Mounting Type only)

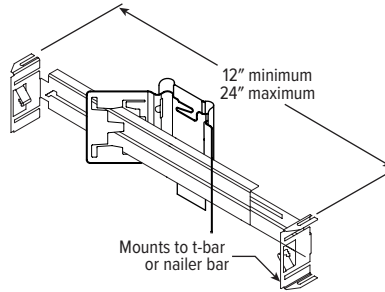

CA1 Adjustable caterpillar pan bracket, universal bar hanger included (N Mounting Type only)

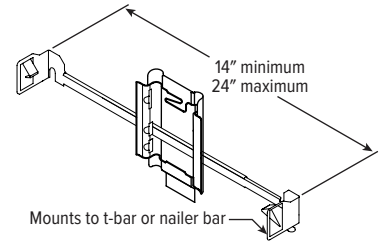

CA2 Adjustable caterpillar pan bracket, t-bar hanger included (N Mounting Type only)

