

V6DR LED 6" Vandal-Resistant Downlight – Round

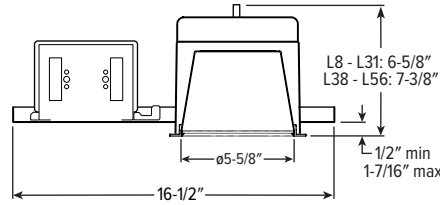

CATALOG #: _____

TYPE: _____

PROJECT: _____

FEATURES

- Ideal for schools, hallways, dormitories, locker rooms, or other vandal prone areas
- Beam angles ranging from 25° narrow to 55° wide for tailored performance
- Die cast trim choices include flush or regressed lens
- Contemporary design provides glare-free illumination for a soft ceiling appearance
- Easily adjust mounting arms below ceiling to adapt to a range of ceiling thicknesses

SPECIFICATIONS

- **HOUSING** – Die-cast aluminum trim housing with forged aluminum heat sink. Galvanized steel splice compartment with driver mounting plate/enclosure. Swing-out mounting arms field adjust for ceiling thickness from 1/2" – 2-1/4".
- **LENSED TRIM** – Die-cast aluminum frame with micro-prismatic, polycarbonate lens with clear polycarbonate underlay. Trim is secured with four stainless steel, tamper-resistant screws.
- **ELECTRICAL** – High-performance Class 2 C.O.B. LED array. Modular quick-connect plug for easy field-connection of LED light assembly to driver. Reported L70>55,000 hours. Reported L90>55,000 hours. Estimated L70 = 200,000 hours.
- **MOUNTING** – Recessed. 20 ga. galvanized steel mounting pan for new construction or IC-rated enclosure. Minimum 24" O.C. marked spacing required for L38 and higher lumen packages.
- **LISTINGS** –
 - cCSAus conforms to UL STD 1598; Certified to CAN/CSA STD C22.2 No. 250.0 for damp locations. LED light assembly conforms to UL 2108 for remote installation.
 - Suitable for wet location under covered ceiling when specified with WET/CC option.
 - IC-rated for direct contact with insulation when specified with I Mounting Type.
 - City of Chicago Environmental Air approved when specified with CP option.
 - Complies with ASTM-E283 when specified with ATH option.
 - RoHS compliant.
- **WARRANTY** – 5-year limited warranty, see hew.com/warranty.

ORDERING EXAMPLE: V6DR - L16/835 - OPTIONS - DIM - UNV - LW - OF - WH - TRIM OPTIONS - N - F1

HOUSING

SERIES	LUMENS ⁽¹⁾	CRI	CCT	OPTIONS	CONTROL ⁽²⁾	VOLTAGE
V6DR	L8 800lm ^[3]	8 80	27 2700K	ATH Airtight construction	DIM Dimming driver, 0-10V	UNV 120-277V
	L12 1,200lm	9 90 ^[4]	30 3000K	F Fuse	DIM1 1% Dimming driver, 0-10V	347 347V ^[9]
	L16 1,600lm		35 3500K	EM/7W 7-watt emergency battery ^[5]		
	L23 2,300lm		40 4000K	EM/10W 10-watt emergency battery ^[6]		
	L31 3,100lm		50 5000K	CP Chicago plenum (CCEA) ^[7]		
	L38 3,800lm			SDT Stepdown transformer ^[8]		
	L46 4,600lm					
L53 5,300lm						
L56 5,600lm						

TRIM

TRIM TYPE	DISTRIBUTION ⁽¹⁰⁾	FLANGE TYPE	REFLECTOR FINISH	TRIM OPTIONS
L Flush lens	W Wide	OF 1/2" standard flange	CS Clear semi-specular powder coat	MWT Textured white trim flange ^[14]
R Regressed lens	55° Flush		WH White texture powder coat	IP IP65 rated trim
	55° Regressed		BL Black texture powder coat	PD Diffuse 1/8" polycarbonate lens ^[15]
	M Medium ^[11]		MB Black texture splay with white flange ^[13]	WET/CC Wet location, covered ceiling listed
	35° Flush			AM Anti-microbial ^[16]
	35° Regressed			
	N Narrow ^[12]			
	25° Flush			
	25° Regressed			

MOUNTING

MOUNTING TYPE ⁽¹⁷⁾	MOUNTING HARDWARE ⁽¹⁸⁾
N Open pan for new construction	F1 Integral 2-position fixed pan bracket, universal bar hanger included ^[20]
I IC-rated enclosure for new construction ^[19]	BA1 Adjustable butterfly pan bracket, bar hanger not included ^[21]
	CA1 Adjustable caterpillar pan bracket, universal bar hanger included ^[22]

ACCESSORIES

TPTX-10 TOOL T10 torx bit 1/4" drive tamper-resistant tool. ^[23]

NOTES

- Lumen output based on L trim type, W distribution and WH finish, 3500K/80CRI. Actual lumens may vary +/-5%. See page 2 for FIXTURE PERFORMANCE DATA.
- See page 3 for ADDITIONAL CONTROL OPTIONS.
- Not available with EM/10W emergency batteries.
- Extended lead times may apply. Consult factory for availability.
- N Mounting Type only.
- N Mounting Type only.
- I Mounting Type required.
- May be required for 347V, see product builder at hew.com/product-builder.
- Not available with EM batteries or DMX controls.
- Beam angle based on WH reflector finish.
- Not available with lumen packages L38 and higher.
- Not available with lumen packages L38 and higher.
- R Trim Type only. Not available with MWT.
- Not available with WH Reflector Finish or L Trim Type.
- W distribution only.
- WH and BL Reflector Finishes only.
- Mounting hardware required, ordered separately, see MOUNTING HARDWARE ordering info. See page 3 for MOUNTING TYPE DETAILS.
- Additional mounting hardware options available. See page 4 for MOUNTING HARDWARE DETAILS.
- L23 lumen package max.
- I Mounting requires external brackets.
- N Mounting Type only.
- N Mounting Type only.
- Tamper-resistant tool must be ordered separately. Please specify quantity required per project.



V6DR^{LED} 6" Vandal-Resistant Downlight – Round

FIXTURE PERFORMANCE DATA

FLUSH LENS TRIM TYPE

	DISTRIBUTION	DELIVERED LUMENS	WATTAGE	EFFICACY (lm/W)
L8	W	774	9.8	79.0
	M	910	9.8	92.9
	N	909	9.8	92.8
L12	W	1178	14.9	79.1
	M	1385	14.9	93.0
	N	1384	14.9	92.9
L16	W	1561	20.4	76.5
	M	1837	20.4	90.0
	N	1836	20.4	90.0
L23	W	2335	29.5	79.2
	M	2782	29.5	94.3
	N	2718	29.5	92.1
L31	W	3122	41.0	76.1
	M	3720	41.0	90.7
	N	3635	41.0	88.7
L38	W	3824	49.3	77.6
	M	-	-	-
	N	-	-	-
L46	W	4609	62.2	74.1
	M	-	-	-
	N	-	-	-
L53	W	5345	74.4	71.8
	M	-	-	-
	N	-	-	-
L56	W	5626	79.8	70.5
	M	-	-	-
	N	-	-	-

REGRESSED LENS TRIM TYPE

	DISTRIBUTION	DELIVERED LUMENS	WATTAGE	EFFICACY (lm/W)
L8	W	716	9.8	73.1
	M	883	9.8	90.1
	N	897	9.8	91.5
L12	W	1090	14.9	73.2
	M	1344	14.9	90.2
	N	1366	14.9	91.7
L16	W	1445	20.4	70.8
	M	1782	20.4	87.4
	N	1812	20.4	88.8
L23	W	2160	29.5	73.2
	M	2699	29.5	91.5
	N	2683	29.5	90.9
L31	W	2889	41.0	70.5
	M	3609	41.0	88.0
	N	3587	41.0	87.5
L38	W	3537	49.3	71.7
	M	-	-	-
	N	-	-	-
L46	W	4264	62.2	68.6
	M	-	-	-
	N	-	-	-
L53	W	4945	74.4	66.5
	M	-	-	-
	N	-	-	-
L56	W	5205	79.8	65.2
	M	-	-	-
	N	-	-	-

MULTIPLIER TABLES

	COLOR TEMPERATURE	
	CCT	CONVERSION FACTOR
80 CRI	2700K	0.92
	3000K	0.98
	3500K	1.00
	4000K	1.01
	5000K	1.02
90 CRI	2700K	0.76
	3000K	0.79
	3500K	0.82
	4000K	0.84
	5000K	0.88

TRIM	
CATALOG NUMBER	CONVERSION FACTOR
PD	0.85

- Photometrics tested in accordance with IESNA LM-79. Results shown are based on 25°C ambient temperature.
- Wattage shown is based on 120V input.
- Results based on 3500K, 80 CRI, actual lumens may vary +/-5%
- Use multiplier tables to calculate additional options.

PHOTOMETRY

V6DR-L16/835-DIM-UNV-LW-OF-WH Total Luminaire Output: 1561 lumens; 20.4 Watts | Efficacy: 76.5 lm/W | 80 CRI; 3500K CCT

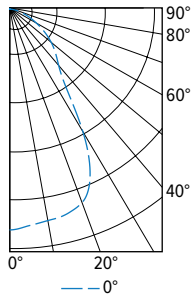

CANDLEPOWER DISTRIBUTION	VERTICAL ANGLE	HORIZONTAL ANGLE	ZONAL LUMENS
		0°	
	0	993	
	5	978	69
	15	954	155
	25	823	185
	35	420	123
	45	281	105
	55	190	77
	65	106	45
	75	47	20
	85	10	2
	90	1	

LUMEN SUMMARY	ZONE	LUMENS	% FIXTURE
	0 - 40	1005	64
	0 - 60	1392	89
	0 - 90	1561	100
	0 - 180	1561	100

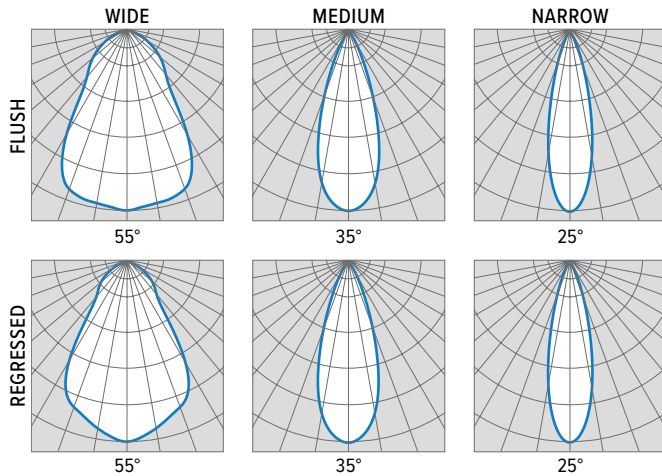

V6DR LED 6" Vandal-Resistant Downlight – Round

ADDITIONAL CONTROL OPTIONS

Lumen restrictions apply: L31 max for DMX driver, L31 max for Lutron drivers, L38 max for ELDO drivers. 347V may require stepdown transformer, see product builder at hew.com/product-builder. I Mounting Type not available with Lutron controls.

CATALOG NUMBER	DESCRIPTION
DIM	Dimming driver prewired for 0-10V low voltage applications
DIM1	1% dimming driver prewired for 0-10V low voltage applications
DIM LINE	Line voltage dimming driver (TRIAC and ELV compatible at 120V only)
DMX	0.1% dimming driver for DMX controls
LTE LINE	Lutron Hi-lume 1% 2-wire dimming driver forward phase line voltage controls (120V only)
LDE1	Lutron Hi-lume 1% EcoSystem dimming LED driver
VRF/DBI/LDE1	Lutron Vive integral fixture control, RF only (DFCSJ-OEM-RF), Lutron Hi-lume 1% EcoSystem dimming LED driver, and digital link interface
FCJS/DIM	Lutron Vive PowPak wireless fixture control with dimming driver
FCJS/DIM1	Lutron Vive PowPak wireless fixture control with 1% dimming driver
ELDO SOLOB	EldoLED Solodrive, 0.1% dimming driver for 0-10V controls
ELDO SOLOB DALI	EldoLED Solodrive, 0.1% dimming driver for DALI controls
ELDO ECO1	EldoLED Ecodrive, 1% dimming driver for 0-10V controls
ELDO ECO1 DALI	EldoLED Ecodrive, 1% dimming driver for DALI controls

TRIM TYPE DETAILS

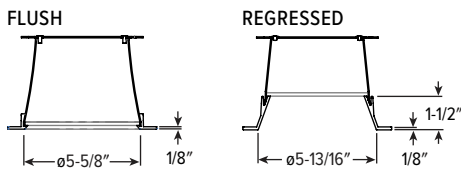

FLANGE TYPE DETAILS

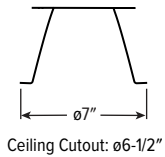

REFLECTOR FINISH DETAILS



MOUNTING TYPE DETAILS

NEW CONSTRUCTION

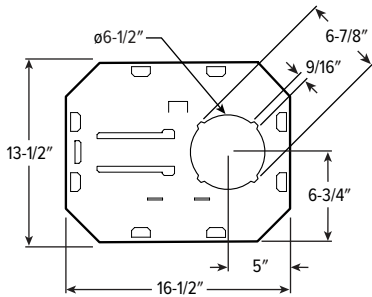

IC-RATED

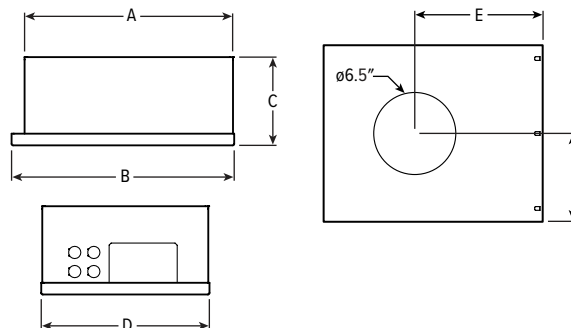

LUMENS	LENGTH					
	A	B	C	D	E	F
L8 - L16	15-3/16"	16"	6-3/8"	12-1/8"	9-1/2"	6-1/16"
L23	16-5/8"	17-1/2"	7-7/8"	14"	10-1/4"	7"

V6DR^{LED} 6" Vandal-Resistant Downlight – Round

MOUNTING HARDWARE DETAILS

F1 Integral 2-position fixed pan bracket, universal bar hanger included

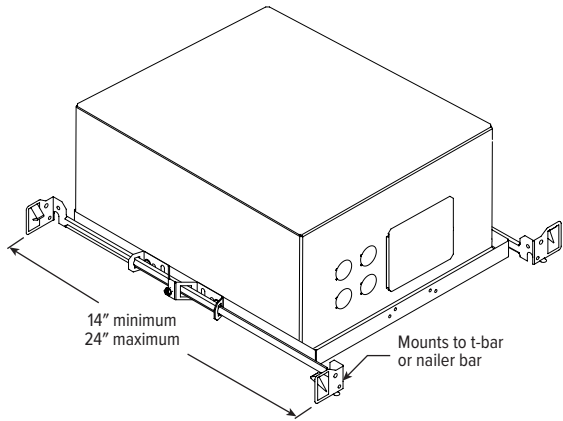
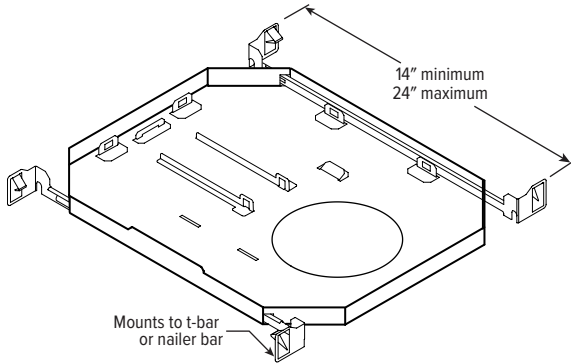

F1 with I Mounting Type

BA1 Adjustable butterfly pan bracket, bar hanger not included (N Mounting Type only)

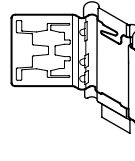

BA2 Adjustable butterfly pan bracket, heavy-duty universal bar hanger included (N Mounting Type only)

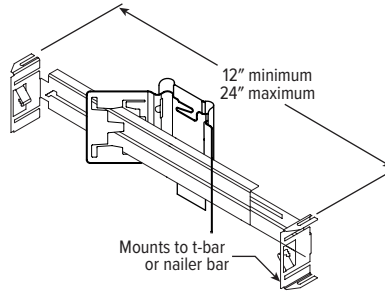

CA1 Adjustable caterpillar pan bracket, universal bar hanger included (N Mounting Type only)

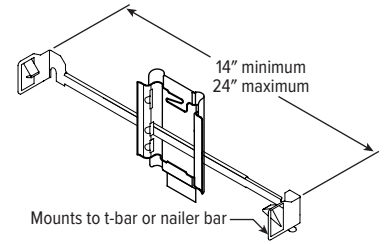

CA2 Adjustable caterpillar pan bracket, t-bar hanger included (N Mounting Type only)

