

VWMH Front view
Weight: 6.5 Lbs.

CATALOG #: _____

TYPE: _____

PROJECT: _____

FEATURES

- Designed to illuminate sidewalks, entryways, perimeters or facades
- Intended for use in both uplight and downlight applications
- Savings of up to 80% energy compared to HID systems
- Blends seamlessly with a variety of architectural styles
- Made Right Here® in the USA

SPECIFICATIONS

- HOUSING** – Die-cast aluminum enclosure.
- THERMAL MANAGEMENT** – Integral die-cast aluminum heatsink and LED source provide passive thermal management. Rated ambient operating temperature -30°C to 50°C (L10, L17), -30°C to 45°C (L20).
- OPTICAL SYSTEM** – General output provides full cutoff.
- LED SOURCE** – ANSI 3000K, 4000K, or 5000K CCT; 70 or 80 CRI LEDs. L20: circuit board design. L10 & L17: Chip on board.
- LED DRIVER** – 0-10V dimming.
- ELECTRICAL** – 120-277 VAC input range; 50-60Hz; power factor >.90; THD <20% at full load. FCC Class A compliant. Quick-disconnect wiring provided. Calculated L70 >50,000 hours per IES TM-21.
- FINISH** – Super durable polyester powder coat bonded to phosphate-free, multi-stage pretreated metal, meets and exceeds AAMA 2604 specifications for outdoor durability.
- MOUNTING** – Surface mounts directly over a 4" maximum outlet box. Must be anchored to adequate structure that can safely support fixture weight (6.5 Lbs).
- LISTINGS** –
 - cCSAus certified as luminaire suitable for wet locations.
 - DesignLights Consortium qualified product. Not all versions of this product may be DLC qualified, see the DLC Qualified Products List at www.designlights.org/QPL.
 - IDA Dark-Sky approved (downlight applications only).
 - RoHS compliant.
 - IP65 rated.
 - Title 24 compliant with PC option.
- WARRANTY** – 5-year limited warranty, see hew.com/warranty.

ORDERING EXAMPLE: VWM H - L20/740 - T3 - DBZ - SDGL - OPTIONS - DIM - UNV

ORDERING INFO

SERIES	TYPE ^[1]	LUMENS ^[2]	CRI/CCT	DISTRIBUTION ^[3]
VWM	H Horizontal	70 CRI	70 CRI	TL Lambertian distribution ^[5]
		L17 1,700lm ^[4]	730 3000K	T3 Type III ^[6]
	V Vertical	L20 2,000lm	740 4000K	
		80 CRI	750 5000K	
	L10 1,000lm	80CRI		
	L17 1,700lm	830 3000K		
			840 4000K	

FINISH OPTIONS ^[7]

- BLK** Black (RAL #9004)
- DBZ** Dark bronze
- DBR** Medium bronze
- GRAY** Standard gray
- SLV** Satin aluminum (RAL #9006)
- WHT** White (RAL #9003)

SHIELDING

- SDGL** Micro-prismatic tempered glass lens
- CGL** Clear tempered glass lens

OPTIONS

- PC** Button-style photocell ^[8]
- SP10** 10kA/10kV surge protection
- TP** Tamper-resistant Torx head screws ^[9]

CONTROL

- DIM** Dimming driver prewired for 0-10V low voltage applications

VOLTAGE

- 120** 120V
- 208** 208V
- 277** 277V
- UNV** 120-277V

ACCESSORIES

- TPTX-25 TOOL** Tamper-resistant tool for Torx head screws. ^[10]

NOTES

- See page 3 for FIXTURE DETAILS.
- Lumen output based on 5000 CCT. Actual lumens may vary +/-5%, see page 2 for FIXTURE PERFORMANCE DATA.
- See page 2 for DISTRIBUTION DETAILS.
- Available with 750 CRI/CCT only.
- L10 & L17 only.
- L20 only.
- See page 3 for FINISH OPTIONS.

⁸ Factory-installed. 120V, 208V, or 277V only; must specify voltage. See page 3 for FIXTURE DETAILS. Left side when viewed from behind fixture.

⁹ Silver finish only. Safety screws providing added support to the lens are not tamper-resistant (lens is sealed to the fixture via adhesion). Requires a tamper-resistant tool, see Accessories.

¹⁰ Tamper-resistant tool must be ordered separately. Please specify quantity required per project.



FIXTURE PERFORMANCE DATA

	LED PACKAGE	DISTRIBUTION	WATTAGE	CCT	CLEAR GLASS (CGL)		SOLITE GLASS (SDGL)		BUG RATINGS
					DELIVERED LUMENS	EFFICACY (lm/W)	DELIVERED LUMENS	EFFICACY (lm/W)	
VWMH	L10	TL	13	3000	1188	91.3	1104	85.0	B1-U0-G0
				4000	1250	96.2	1163	89.4	
				5000	1349	103.8	1255	96.5	
	L17		16	3000	1644	102.8	1529	95.6	
				4000	1731	108.2	1610	100.6	
				5000	1840	115.0	1711	107.0	
	L20	T3	25	3000	2387	95.5	2197	87.9	B1-U0-G1
				4000	2390	95.6	2229	89.2	
				5000	2510	100.4	2341	93.6	
VWMV	L10	TL	13	3000	1006	77.4	936	72.0	B1-U0-G0
				4000	1059	81.5	985	75.8	
				5000	1201	92.4	1117	85.9	
	L17		16	3000	1520	95.0	1414	88.4	
				4000	1600	100.0	1488	93.0	
				5000	1704	106.5	1585	99.0	
	L20	T3	25	3000	2139	85.6	2022	80.9	B1-U0-G1
				4000	2290	91.6	2136	85.4	
				5000	2301	92.0	2146	85.8	

- Wattage shown is average for 120V through 277V input.
- Efficacy/lumen output shown is average based on voltage input of 120V through 277V.
- Photometrics tested in accordance with IESNA LM-79. Results shown are based on 25°C ambient temperature.

LUMEN MAINTENANCE

	AMBIENT TEMP.	REPORTED L70 HOURS (TM-21)
L20	25°C	>60,000
	35°C	>60,000
	45°C	>60,000
L10/L17	25°C	>55,000
	35°C	>55,000
	45°C	>55,000

- Predicted lumen maintenance calculated from LED manufacturer IES LM-80 data and in-situ temperature measurement.
- Reported L70 hours in accordance with IES TM-21

DISTRIBUTION DETAILS

VWMH TL

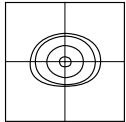

VWMV TL

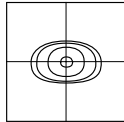

VWMH/V T3

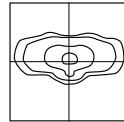

Clear Glass (CGL)

VWMH/V T3

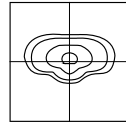

Solite Glass (SDGL)



FIXTURE DETAILS

MOUNTING DETAILS

BOLT PATTERN DETAIL

VWPH

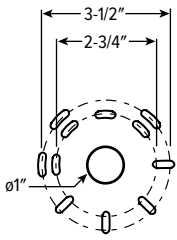

VWPV

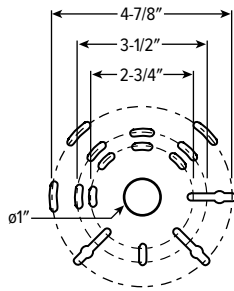

PC OPTION

Factory-installed button-style photocell, left side when viewed from behind fixture.
(120V, 208V, or 277V only; must specify voltage)

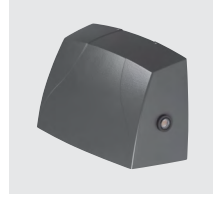

VWMH

Weight: 6.5 lbs



Front View

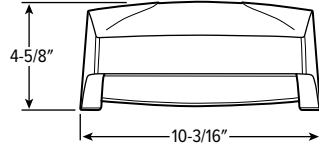

Side View

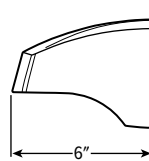

Uplight Application

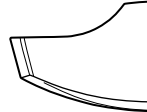

VWMV

Weight: 6.5 Lbs



Front View

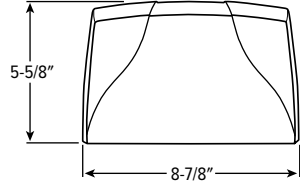

Side View

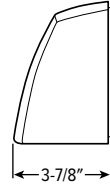

Uplight Application

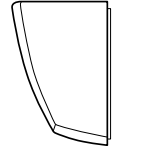

FINISH OPTIONS

WHITE

BLACK

GREEN

MEDIUM BRONZE

DARK BRONZE

SILVER

GRAY

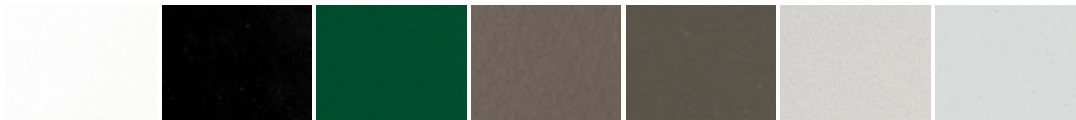

For custom color, please specify RAL code or a manufacturer code with description. All custom colors other than RAL require two sample swatches, minimum 1" square.

