

W4CR^{LED} 4" Wet Location Cylinder – Round

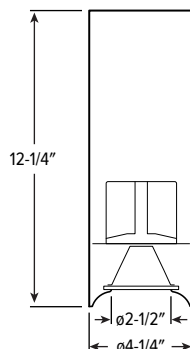

CATALOG #: _____

TYPE: _____

PROJECT: _____



TwistLock™

FEATURES

- Sleek architectural form delivers refined, high-performance outdoor illumination
- Slim profile enables precise light control, highlighting facades and design details
- Versatile pendant, wall, and canopy-mount maximize application flexibility
- Durable aluminum housing and die-cast trim engineered for year-round exposure
- Sealed IP-rated design guards internal components from water, dust, and debris
- Simple lift-and-twist surface and pendant mount secures trim skirt to junction box
- Beam angles ranging from 21° spot to 56° wide for tailored performance
- Pairs with Williams indoor cylinders for seamless exterior-to-interior continuity
- Maximize energy savings with efficacies up to 126 lm/W
- Made Right Here® in the USA

SPECIFICATIONS

- **HOUSING** – Extruded aluminum with die-cast aluminum accent ring.
- **FINISH** – Super durable polyester powder coat bonded to phosphate-free, multi-stage pretreated metal, meets and exceeds AAMA 2604 specifications for outdoor durability. Salt spray tested, 3,000 hours (ASTM B117).
- **TRIM** – Die-cast aluminum frame with micro-prismatic, glass lens.
- **ELECTRICAL** – High-performance Class 2 C.O.B. LED array. Modular quick-connect plug for easy field-connection of LED light assembly to driver. Estimated L70>105,000 hours. 50/60 Hz, THD <10%. Rated -10°C to 40°C ambient operating temperature. 0°C to 40°C with EM battery.
- **MOUNTING** – Surface, pendant, or wall mount.
- **LISTINGS** –
 - cCSAus conforms to UL STD 1598 and UL STD 8750. Certified to CAN/CSA STD C22.2 No. 250.2-20. Suitable for wet locations.
 - ANSI/UL Standard 2108
 - IP66 rated.
 - Complies with the Buy American Act and other federal regulations. Request certification at hew.com/buy-american
- **WARRANTY** – 5-year limited warranty, see hew.com/warranty

ORDERING EXAMPLE: W4CR - 12 - L20/835 - OPTIONS - WHT - DIM - UNV - W - WM

SERIES	HEIGHT	LUMENS ^[1]	CRI	CCT	OPTIONS ^[2]	
W4CR	12 12"	L10 1,000lm	8 80	27 2700K	EM/7W	7-watt emergency battery ^[3]
		L15 1,500lm	9 90	30 3000K	EM/10WRM/IPRTS	Remote mount 10-watt emergency battery with IP65 rated regressed test switch ^[4]
		L20 2,000lm		35 3500K	RDB	Remote mount control/driver box, galvanized steel ^[5]
		L25 2,500lm		40 4000K	PC	Factory-installed button-style photocell ^[6]
				50 5000K	(L___)	Additional lower lumen packages available ^[7] Example: 1,800 lumens = W4CR-12-L20/835-(L18)

HOUSING FINISH ^[8]	DRIVER	VOLTAGE	DISTRIBUTION
BLK Black (RAL #9004)	See page 2 for ADDITIONAL DRIVER OPTIONS .	UNV 120-277V	W 56° Wide
DBZ Dark bronze		347 347V ^[9]	M 40° Medium
DBR Medium bronze	DIM Dimming driver, 0-10V		N 30° Narrow
GRAY Standard gray	DIM1 1% Dimming driver, 0-10V		S 21° Spot
GRN Green (RAL #6005)			
SLV Satin aluminum (RAL #9006)			
WHT White (RAL #9003)			

MOUNTING^[10]

Recessed J-Box

WM	Wall mount to recessed J-box ^[11]
SM	Surface mount to recessed J-box ^[12]
PM__	Pendant mount to recessed J-box ^[13] Specify length in 1" increments, minimum 6". Example: 24" pendant = PM24

Surface J-Box

SMS	Surface mount to surface J-box ^[14]
PMS__	Pendant mount to surface J-box ^[15] Specify length in 1" increments, minimum 6". Example: 24" pendant = PMS24

NOTES

- ¹ Lumen output based on W Distribution and 80 CRI/3500K CCT. Actual performance may vary +/-5%. See page 2 for **FIXTURE PERFORMANCE DATA**.
- ² See page 2 for **EMERGENCY BATTERY DETAILS**. All EM batteries are California Energy Commission (CEC) Compliant.
- ³ Not available with L10 lumen package. Only available with DIM, DIM1 and DIM LINE drivers.
- ⁴ Max remote distance 50', including suspension length. Large remote box provided.
- ⁵ Painted driver box available, specify RDB/BLK or RDB/WHT.
- ⁶ Not available with 347V or EM batteries.

- ⁷ Specify in increments of 100 nominal lumens. Option must be specified with next higher lumen package.
- ⁸ See page 3 for **HOUSING FINISH DETAILS**.
- ⁹ Not available with EM batteries or DMX drivers.
- ¹⁰ See page 3 for **MOUNTING DETAILS**.
- ¹¹ 4" square galvanized J-box, by others.
- ¹² 4" octagonal galvanized J-box, by others.
- ¹³ Canopy and pendant match fixture housing color unless specified otherwise. 4" octagonal galvanized J-box, by others.
- ¹⁴ 4" round cast aluminum weatherproof J-box, by others.
- ¹⁵ Canopy and pendant match fixture housing color unless specified otherwise. 4" round cast aluminum weatherproof J-box, by others.



W4CR^{LED} 4" Wet Location Cylinder – Round

FIXTURE PERFORMANCE DATA

	DISTRIBUTION	DELIVERED LUMENS	WATTAGE	EFFICACY (lm/W)
L10	W	1061	9.8	108
	M	1043	9.8	106
	N	1106	9.8	113
	S	1161	9.8	118
L15	W	1564	13.6	115
	M	1538	13.6	113
	N	1630	13.6	120
	S	1712	13.6	126
L20	W	2087	18.1	115
	M	2051	18.1	113
	N	2173	18.1	120
	S	2283	18.1	126
L25	W	2590	23.1	112
	M	2546	23.1	110
	N	2698	23.1	117
	S	2833	23.1	123

MULTIPLIER TABLE

COLOR TEMPERATURE	
CCT	CONVERSION FACTOR
2700K	0.98
3000K	1.00
3500K	1.00
4000K	1.01
5000K	0.99

80 CRI	2700K	0.94
	3000K	0.96
	3500K	0.97
	4000K	0.97
	5000K	0.95

- Photometrics tested in accordance with IESNA LM-79. Results based on W Distribution and 80 CRI/3500K CCT, average wattage for 120V input, and 25°C ambient temperature. Actual performance may vary +/-5%.
- To calculate lumen output in emergency mode, multiply the battery wattage by the efficacy.
- Use multiplier table to calculate additional options.

DISTRIBUTION CURVES

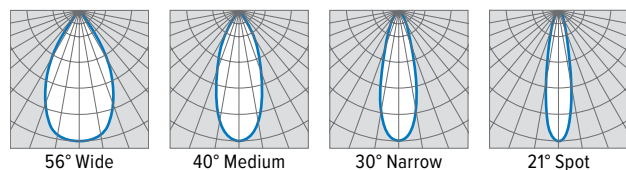

ADDITIONAL DRIVER OPTIONS

DRIVER	DESCRIPTION	RDB DETAILS BY LUMEN STOP					REMOTE MOUNT KEY
		L10	L15	L20	L25	10W EM	
DIM	Dimming driver prewired for 0-10V low voltage applications	OIS	OIS	OIS	OIS	RIL	OIS RDB Optional, Small Box
DIM1	1% dimming driver prewired for 0-10V low voltage applications	OIS	OIS	OIS	OIS	RIL	
DIM LINE	Line voltage dimming driver (TRIAC and ELV compatible at 120V only)	—	OIS	OIS	OIS	RIL	RIM RDB Required, Medium Box
DMX	0.1% dimming driver for DMX controls	RIM	RIM	RIM	RIM	RIL	
DALI	DALI dimming driver	RIM	RIM	RIM	RIM	RIL	RIL RDB Required, Large Box
LDE1	Lutron Hi-lume 1% EcoSystem dimming LED driver	RIM	RIM	RIM	RIM	RIL	

REMOTE MOUNT DETAILS

Max remote distance is 50' including suspension length, connection by others. Must be room-side accessible and mounted in dry/damp location.

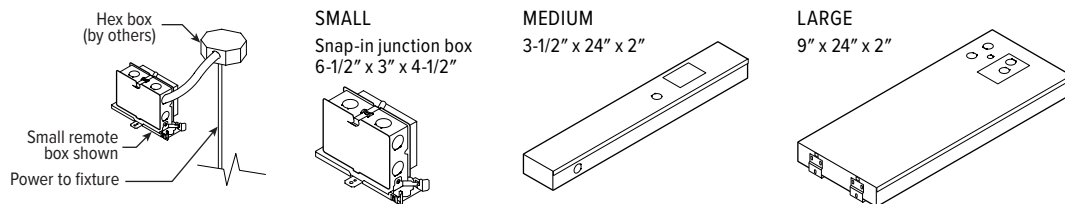

EMERGENCY BATTERY DETAILS

REMOTE MOUNT



Regressed test switch
ø1-3/4"

Max remote distance is 50', connection by others. Must be mounted in dry/damp location.

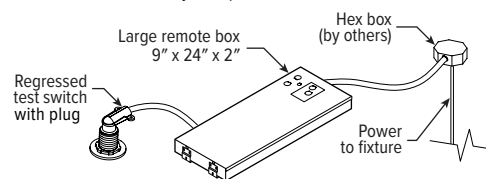



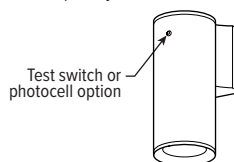

INTEGRAL

Test switch or photocell option located 1-5/8" from top of cylinder. Wall mount shown.

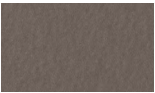

W4CR LED 4" Wet Location Cylinder – Round

HOUSING FINISH DETAILS

WHITE	BLACK	GREEN	MEDIUM BRONZE	DARK BRONZE	SATIN ALUMINUM GRAY
					

For custom color, please specify RAL code or a manufacturer code with description. All custom colors other than RAL require four sample swatches, minimum 1" square.

MOUNTING DETAILS

WALL MOUNT

WM



Adaptor

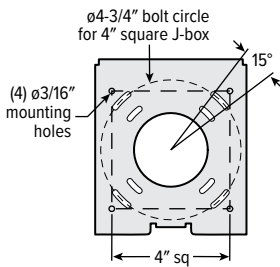

Side View

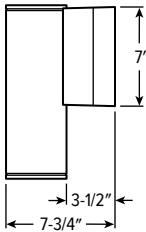

Top View

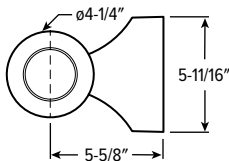

SURFACE MOUNT

SM



Secures to 4" octagonal galvanized recessed j-box, by others

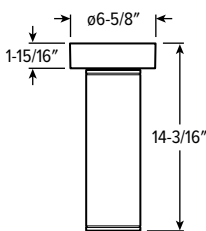

SMS



Secures to 4" octagonal galvanized surface j-box, by others

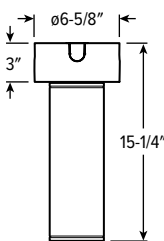

PENDANT MOUNT

Provided with 1/2" IPS Threaded stem. Specify length of stem, 6" minimum, 24" default length.

PM__



Secures to 4" octagonal galvanized recessed j-box, by others

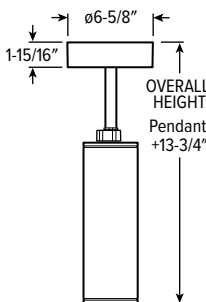

PMS__



Secures to 4" octagonal galvanized surface j-box, by others

