

W6CRDI LED

6.5" Wet Location Direct/Indirect Cylinder – Round

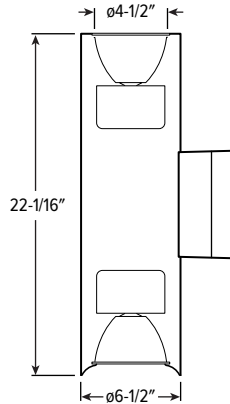

CATALOG #: _____

TYPE: _____

PROJECT: _____



FEATURES

- Direct and indirect light combine to brighten canopies and softly accent vertical surfaces
- Sleek architectural form delivers refined, high-performance outdoor illumination
- Bold profile creates a strong visual statement across large exterior surfaces
- Durable aluminum housing and die-cast trim engineered for year-round exposure
- Sealed IP-rated design guards internal components from water, dust, and debris
- Beam angles ranging from 13° spot to 64° wide for tailored performance
- Pairs with Williams indoor cylinders for seamless exterior-to-interior continuity
- Maximize energy savings with efficacies up to 115 lm/W
- Made Right Here® in the USA

SPECIFICATIONS

- HOUSING** – Extruded aluminum with die-cast aluminum accent ring.
- FINISH** – Super durable polyester powder coat bonded to phosphate-free, multi-stage pretreated metal, meets and exceeds AAMA 2604 specifications for outdoor durability. Salt spray tested, 3,000 hours (ASTM B117).
- TRIM** – Die-cast aluminum frame with micro-prismatic, glass lens.
- ELECTRICAL** – High-performance Class 2 C.O.B. LED array. Modular quick-connect plug for easy field-connection of LED light assembly to driver. Estimated L70>105,000 hours. 50/60 Hz, THD <10%. Rated -10°C to 40°C ambient operating temperature. 0°C to 40°C with EM battery.
- MOUNTING** – Wall mount.
- LISTINGS** –
 - cCSAus conforms to UL STD 1598 and UL STD 8750. Certified to CAN/CSA STD C22.2 No. 250.2-20. Suitable for wet locations.
 - ANSI/UL Standard 2108
 - IP66 rated.
 - Complies with the Buy American Act and other federal regulations. Request certification at www.buy-american.com
- WARRANTY** – 5-year limited warranty, see www.hew.com/warranty

ORDERING EXAMPLE: W6CRDI - 22 - L20/835U/L20/835D - OPTIONS - WHT - DIM - UNV - W - WM

SERIES HEIGHT LUMEN PACKAGE (Example: L30/835U/L10/835D)

W6CRDI	22 22"	Specify lumen packages: U for Up and D for Down				
		LUMENS ^[1]	CRI	CCT	U OR D	
		L10 1,000lm	8 80	27 2700K	U Uplight	
		L20 2,000lm	9 90	30 3000K	D Downlight	
		L30 3,000lm		35 3500K		
		L40 4,000lm		40 4000K		
		L50 5,000lm		50 5000K		

OPTIONS ^[2]

EM/7W	7-watt emergency battery ^[4]
EM/10WRM/IPRTS	Remote mount 10-watt emergency battery with IP65 rated regressed test switch ^[5]
PC	Factory-installed button-style photocell ^[6]
RDB	Remote mount control/driver box, galvanized steel ^[7]
(L__)	Additional lower lumen packages available ^[8] Example: 1,500 lumens = W6CRDI-22-L20/835-(L15)

HOUSING FINISH ^[3]

BLK	Black (RAL #9004)
DBZ	Dark bronze
DBR	Medium bronze
GRAY	Standard gray
GRN	Green (RAL #6005)
SLV	Satin aluminum (RAL #9006)
WHT	White (RAL #9003)

DRIVER

See page 3 for **ADDITIONAL DRIVER OPTIONS**.

DIM Dimming driver, 0-10V
DIM1 1% Dimming driver, 0-10V

VOLTAGE

UNV 120-277V
347 347V ^[9]

DISTRIBUTION

Uplight
W 64° Wide
M 35° Medium
N 23° Narrow
S 13° Spot

Downlight

W 64° Wide
M 35° Medium
N 23° Narrow
S 13° Spot

MOUNTING

WM Wall mount to recessed J-box ^[10]

NOTES

¹ Lumen output based on W Distribution and 80 CRI/3500K CCT. Actual performance may vary +/-5%. See page 2 for **FIXTURE PERFORMANCE DATA**.

² See page 3 for **EMERGENCY BATTERY DETAILS**. All EM batteries are California Energy Commission (CEC) Compliant.

³ See page 2 for **HOUSING FINISH DETAILS**.

⁴ Only available with L20 and L30 lumen packages and DIM, DIM1 and DIM LINE Drivers.

⁵ Max remote distance 50', including suspension length. Large remote box provided.

⁶ Not available with 347V or EM batteries.

⁷ Painted driver box available, specify RDB/BLK or RDB/WHT.

⁸ Specify in increments of 100 nominal lumens. Option must be specified with next higher lumen package.

⁹ Not available with EM batteries or DMX drivers.

¹⁰ 4" square galvanized J-box, by others. See page 3 for **MOUNTING DETAILS**.



W6CRDI LED

6.5" Wet Location Direct/Indirect Cylinder – Round

FIXTURE PERFORMANCE DATA

Find your lumen stops for both uplight and downlight on the table below and add the wattages together to find the total fixture wattage.

DOWNLIGHT OR UPLIGHT				
	DISTRIBUTION	DELIVERED LUMENS	WATTAGE	EFFICACY (lm/W)
L10	W	1081	10.1	107
	M	986	10.1	98
	N	958	10.1	95
	S	1068	10.1	106
L20	W	2169	20.1	108
	M	1978	20.1	98
	N	1922	20.1	96
	S	2143	20.1	107
L30	W	3077	27.0	114
	M	2806	27.0	104
	N	2753	27.0	102
	S	3049	27.0	113
L40	W	4045	36.7	110
	M	3685	36.7	100
	N	3620	36.7	99
	S	4008	36.7	109
L50	W	5173	45.0	115
	M	4666	45.0	104
	N	4588	45.0	102
	S	5116	45.0	114

MULTIPLIER TABLE

COLOR TEMPERATURE		
	CCT	CONVERSION FACTOR
80 CRI	2700K	0.98
	3000K	1.00
	3500K	1.00
	4000K	1.01
	5000K	0.99
90 CRI	2700K	0.93
	3000K	0.95
	3500K	0.96
	4000K	0.97
	5000K	0.94

- Photometrics tested in accordance with IESNA LM-79. Results based on W Distribution and 80 CRI/3500K CCT, average wattage for 120V input, and 25°C ambient temperature. Actual performance may vary +/-5%.
- To calculate lumen output in emergency mode, multiply the battery wattage by the efficacy.
- Use multiplier table to calculate additional options.

DISTRIBUTION CURVES

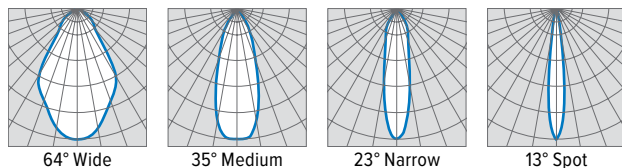

HOUSING FINISH DETAILS

WHITE	BLACK	GREEN	MEDIUM BRONZE	DARK BRONZE	SATIN ALUMINUM GRAY

For custom color, please specify RAL code or a manufacturer code with description. All custom colors other than RAL require four sample swatches, minimum 1" square.

SEE NEXT PAGE FOR DRIVER DETAILS



H.E. Williams, Inc.

Carthage, Missouri

www.hew.com

417-358-4065

Designed and Manufactured in the USA

REV.07/29/25.JL

Cylinders
Page 2 of 3

Information contained herein is subject to change without notice.

W6CRDI LED 6.5" Wet Location Direct/Indirect Cylinder – Round

ADDITIONAL DRIVER OPTIONS

CONTROL/DRIVER	DESCRIPTION	RDB DETAILS BY LUMEN STOP ^[1]					
		L10	L20	L30	L40	L50	10W EM
DIM	Dimming driver prewired for 0-10V low voltage applications; entire fixture switches and dims together	OIS	OIS	OIS	OIL	OIL	RIL
DIMU/DIMD	Dimming driver prewired for 0-10V low voltage applications; up and down portions switch and dim separately	OIS	OIS	OIS	OIL	OIL	RIL
DIM1	1% dimming driver prewired for 0-10V low voltage applications	OIS	OIS	OIS	OIL	OIL	RIL
DIM1U/DIM1D	1% dimming driver prewired for 0-10V low voltage applications; up and down portions switch separately	OIS	OIS	OIS	OIL	OIL	RIL
DIM LINE	Line voltage dimming driver (TRIAC and ELV compatible, 120V only)	—	OIS	OIS	OIL	OIL	RIL
DIM LINEU/DIM LINED	Line voltage switching and line voltage dimming; up and down portions switch separately	—	OIS	OIS	OIL	OIL	RIL
DMX	0.1% dimming driver for DMX controls	RIL	RIL	RIL	RIL	RIL	RIL
DMX/DMX	0.1% dimming driver for DMX controls; up and down portions switch separately	RIL	RIL	RIL	RIL	RIL	RIL
DALI	DALI dimming driver	OIL	OIL	OIL	OIL	RIL	RIL
DALI/DALI	DALI dimming driver; up and down portions switch separately	OIL	OIL	OIL	OIL	RIL	RIL
LDE1	Lutron Hi-lume 1% EcoSystem dimming LED driver	OIL	OIL	OIL	OIL	—	RIL
LDE1/LDE1	Lutron Hi-lume 1% EcoSystem dimming LED driver; up and down portions switch separately	OIL	OIL	OIL	OIL	—	RIL

¹ If using two different stops for U/D, see highest lumen stop for RDB.

REMOTE MOUNT DETAILS

Max remote distance is 50', connection by others. Must be mounted in dry/damp location and room-side accessible for maintenance.

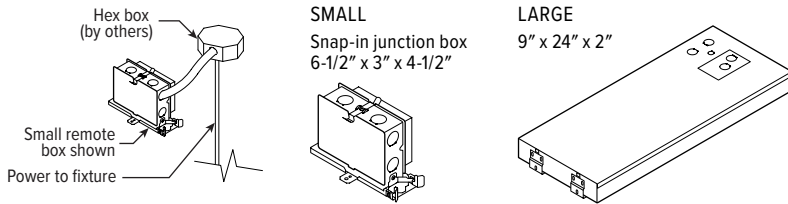

REMOTE MOUNT KEY	
OIS	RDB Optional, Small Box
OIL	RDB Optional, Large Box
RIL	RDB Required, Large box

EMERGENCY BATTERY DETAILS

REMOTE MOUNT



Regressed test switch
ø1-3/4"

Max remote distance is 50', connection by others.
Must be mounted in dry/damp location.

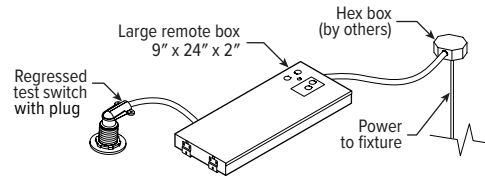

INTEGRAL

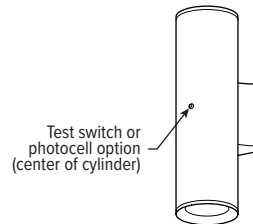

MOUNTING DETAILS

CROSS SECTION

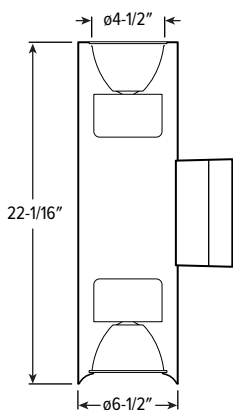

TOP VIEW

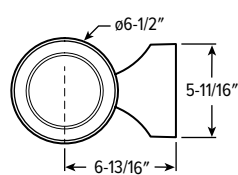

SIDE VIEW

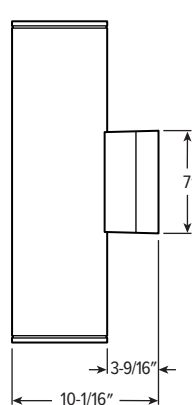

WALL MOUNT ADAPTOR

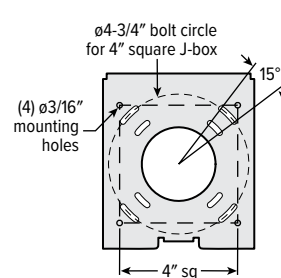

H.E. Williams, Inc.

Carthage, Missouri

www.hew.com

417-358-4065

Designed and Manufactured in the USA

Information contained herein is subject to change without notice.

REV.07/29/25.JL

Cylinders
Page 3 of 3