

CATALOG #: _____

Type: _____

PROJECT: _____

FEATURES

- Ultra-low 2-9/16" fixture depth
- Optimized for single-person installation
- Up to 55°C ambient rating
- Multiple shielding and distribution options
- High-performance up to 155 lm/W
- Micro-prismatic lens reduces glare
- Energy-saving alternative designed to replace traditional HID or fluorescent high bays
- Non-EM fixtures are shipped in 2-packs to reduce job-site waste
- Available with Avi-on wireless fixture controls
- Buy American Act compliant
- Made Right Here® in the USA



ORDERING EXAMPLE: GS - 2 - L240/840 - CA - OPTIONS - CONTROL/DIM - UNV

ORDERING INFO

SERIES	LENGTH	LUMENS ^[1]	CRI	CCT	TEMPERATURE	
GS	2 2'	2'	4'	8 80	30 3000K	- 45°C ambient operating temperature HA High ambient operating temperature, 55°C ^[3]
	4 4'			9 90 ^[2]	35 3500K	
		L120 12,000lm	L240 24,000lm	40 4000K		
		L180 18,000lm	L360 36,000lm	50 5000K		
		L240 24,000lm	L480 48,000lm			

SHIELDING

- CA** Clear acrylic lens
- MD** Medium distribution, micro-prismatic acrylic lens
- ND** Narrow distribution, micro-prismatic acrylic lens
- HE** High efficiency, no lens included

OPTIONS^[4]

- EM/10W** 10-watt emergency battery^[5]
- EM/14W** 14-watt emergency battery^[6]
- EM/20W** 20-watt emergency battery^[7]
- (L_)** Additional lower lumen packages available
Example: 20,000 lumens = GS-2-L240/840-(L200)^[8]
- WG11** 11-gauge wireguard, field-installed^[9]
- WG11 F&I** 11-gauge wireguard, factory installed
- VBV-2** (2) Y-hangers with 2' chains
- VBV/L-5** (2) Y-hangers with 5' loop cable
- VBV/L-10** (2) Y-hangers with 10' loop cable
- GS-HUB MT** Cast iron hub and junction box for single 3/4" pendant mount^[10]
- GS-HUB/HOOK MT** Cast iron hub with mounting hook^[11]
- GS-SMK** Surface mount kit^[12]
- 6CPI/L5-15P/TWLK** 6' cord and NEMA twistlock 15 AMP plug, 120V^[13]
- 6CPI/L7-15P/TWLK** 6' cord and NEMA twistlock 15 AMP plug, 277V^[14]

SPECIFICATIONS

- **HOUSING** – Die-formed aluminum housing.
- **SHIELDING** – Clear or micro-prismatic acrylic lens.
- **FINISH** – 92% minimum average reflective white polyester powder coat bonded to phosphate-free, multi-stage pretreated metal. All parts painted after fabrication to facilitate installation, increase efficiency, and inhibit corrosion.
- **ELECTRICAL** – High-quality mid-power LED boards. L80 at 72,000 hours. 45°C maximum ambient operating temperature standard. 55°C maximum ambient operating temperature when specified with HA option, lumen restrictions apply, consult fixture performance data.
- **MOUNTING** – Suspended. Surface mount kit available. Indoor applications only. Fixture weight is 6.5lbs for 2' and 13lbs for 4' unit, options may increase weight.
- **LISTINGS** – cCSAus certified as luminaire suitable for dry or damp locations.
- **WARRANTY** – 5-year limited warranty, see hew.com/warranty.

CONTROL^[15]

- None
- AVI-LVFA** Avi-on wireless fixture control^[17]
- AVI-LVFA-PIR-ELB** Avi-on wireless fixture control with PIR motion and daylight sensor, end mount^[18]

DRIVER^[16]

- DIM** Driver with external dimming wires
- DRV** Driver without external dimming wires
- DA** Driver with 12V auxiliary power, without external dimming wires^[19]

VOLTAGE

- 120** 120V
- 277** 277V
- UNV** 120-277V
- 347** 347V^[20]
- 480** 480V^[21]



NOTES

- Lumen output based on CA shielding, 80 CRI/4000K CCT. Actual lumens may vary +/-5%, see page 2 for FIXTURE PERFORMANCE DATA.
- Extended lead times may apply. Consult factory for availability.
- Must be suspended minimum 18" from ceiling. Not available with EM batteries. Lumen restrictions apply. See page 2 for FIXTURE PERFORMANCE DATA.
- See page 3 for MOUNTING DETAILS.
- Increases fixture size. See page 4 for FIXTURE DETAILS.
- Increases fixture size. See page 4 for FIXTURE DETAILS.
- Increases fixture size. See page 4 for FIXTURE DETAILS.
- Specify in increments of 1000 nominal lumens. Option must be specified with next higher lumen package.
- Shipped separately.
- Shipped separately.
- Shipped separately.
- Not available with HA Option. Shipped separately.
- DRV only.
- DRV only.
- See page 6 for ADDITIONAL CONTROL OPTIONS. See page 5 for AVI-ON BLUETOOTH WIRELESS CONTROL DETAILS. See page 4 for SENSOR PLACEMENT DETAILS.
- Consult factory for additional driver options.
- DA Driver only.
- DA Driver only.
- Avi-on Controls only.
- Not available with EM batteries or Avi-on Controls.
- Not available with EM batteries or Avi-on Controls.



FIXTURE PERFORMANCE DATA

LED PACKAGE	STANDARD TEMPERATURE				HA TEMPERATURE			
	DELIVERED LUMENS	WATTAGE	EFFICACY (lm/W)	MAX AMBIENT	DELIVERED LUMENS	WATTAGE	EFFICACY (lm/W)	MAX AMBIENT
2'	L120	12210	85	144	12210	85	144	55°C
	L180	18002	116	155	18002	116	155	55°C
	L240	24420	169	144	23246	156	149	50°C
4'	L240	24420	169	144	24420	169	144	55°C
	L360	36003	232	155	36003	232	155	55°C
	L480	48839	338	144	46493	312	149	50°C

- Photometrics tested in accordance with IESNA LM-79. Results shown are based on 25°C ambient temperature.
- Wattage shown is average for 120V through 277V input.
- Results based on CA shielding, 80 CRI/4000K CCT, actual lumens may vary +/-5%
- To calculate lumen output in emergency mode, multiply the battery wattage by the efficacy.
- Use multiplier tables to calculate additional options.

MULTIPLIER TABLES

	COLOR TEMPERATURE		SHIELDING	
	CCT	CONVERSION FACTOR	CATALOG NUMBER	CONVERSION FACTOR
80 CRI	3000K	0.96	CA	1.00
	3500K	0.97	MD	0.95
	4000K	1.00	ND	0.96
	5000K	1.03	HE	1.04
90 CRI	3000K	0.79		
	3500K	0.80		
	4000K	0.83		
	5000K	0.86		

PHOTOMETRY

GS-2-L240/840-CA-DIM-UNV Total Luminaire Output: 24420 lumens; 169 Watts | Efficacy: 144 lm/W | 80 CRI; 4000K CCT

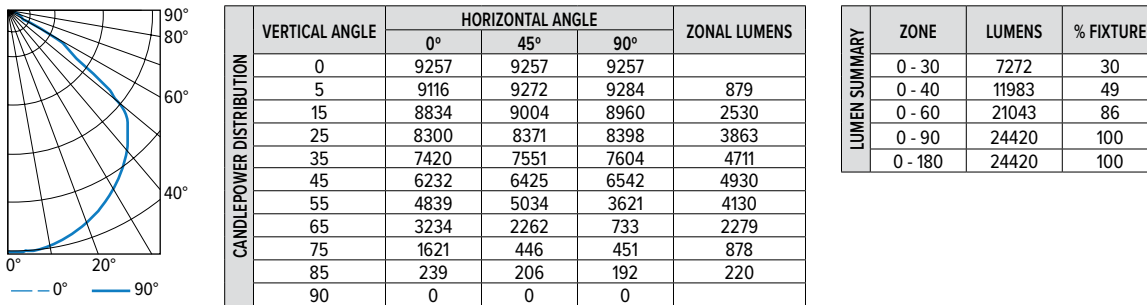

GS-2-L240/840-HE-DIM-UNV Total Luminaire Output: 25397 lumens; 169 Watts | Efficacy: 150 lm/W | 80 CRI; 4000K CCT

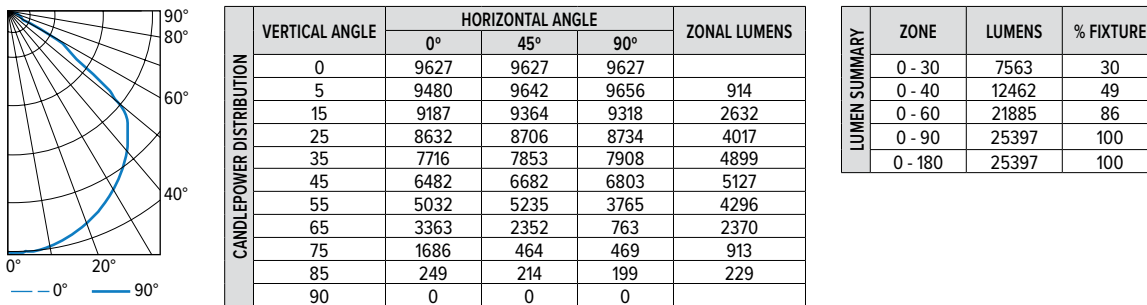

GS-2-L240/840-MD-DIM-UNV Total Luminaire Output: 23199 lumens; 169 Watts | Efficacy: 137 lm/W | 80 CRI; 4000K CCT

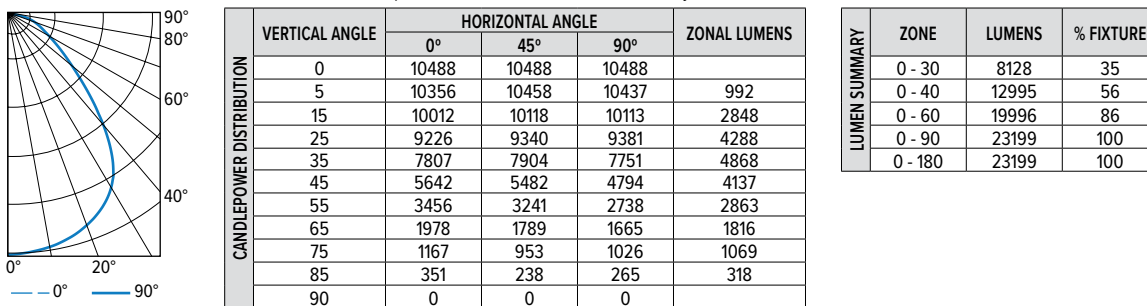

GS-2-L240/840-ND-DIM-UNV Total Luminaire Output: 23444 lumens; 169 Watts | Efficacy: 139 lm/W | 80 CRI; 4000K CCT

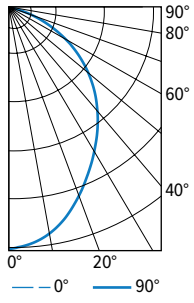

CANDLEPOWER DISTRIBUTION	VERTICAL ANGLE	HORIZONTAL ANGLE			ZONAL LUMENS
		0°	45°	90°	
	0	10316	10316	10316	
	5	10140	10255	10224	967
	15	9380	9469	9458	2652
	25	8071	8112	8082	3727
	35	6758	6678	6711	4199
	45	5410	5326	5362	4127
	55	4043	4000	3926	3560
	65	2660	2635	2418	2555
	75	1362	1297	1056	1328
	85	338	269	219	328
	90	0	0	0	

LUMEN SUMMARY	ZONE	LUMENS	% FIXTURE
	0 - 30	7346	31
	0 - 40	11546	49
	0 - 60	19233	82
	0 - 90	23444	100
	0 - 180	23444	100

MOUNTING DETAILS

VBY-2

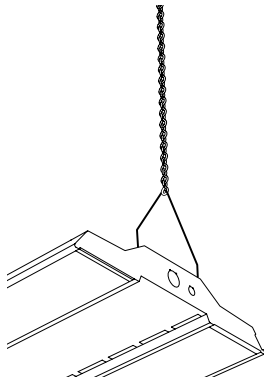

VBY/L-

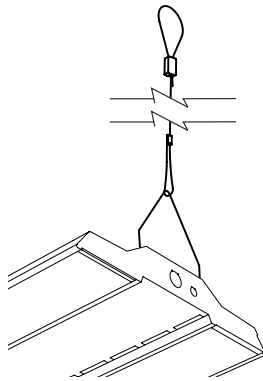

GS-HUB/HOOK MT

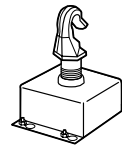

Mounting hook with safety screw allows easy replacement of existing HID fixtures. Hook attaches to the fixture with 3/4" cast iron hub and junction box.

A 10' aircraft cable and Y style hanger factory furnished for leveling fixture from single support.

GS-HUB MT

Cross Section

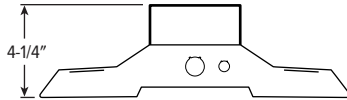

A 10' aircraft cable and Y style hanger factory furnished for leveling fixture from single support.

Backview

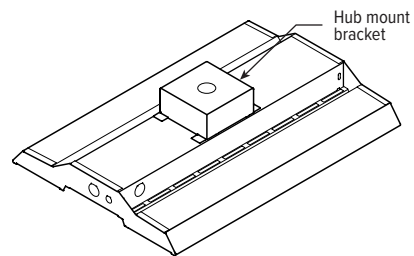
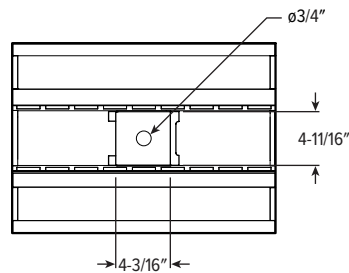

GS-SMK

Cross Section

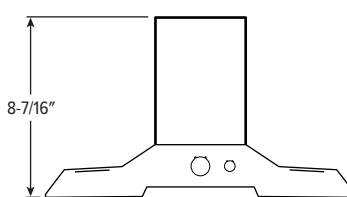

Backview

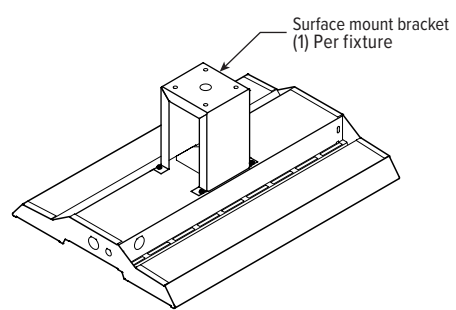
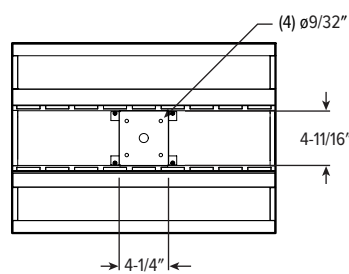

FIXTURE DETAILS

BACKVIEW

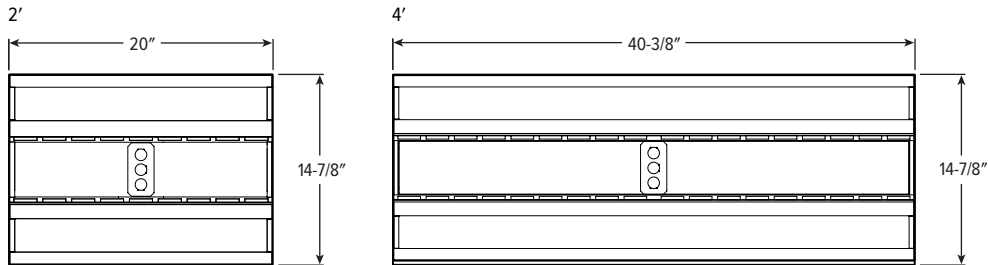

WG11

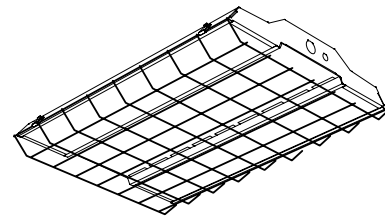

EM/10W

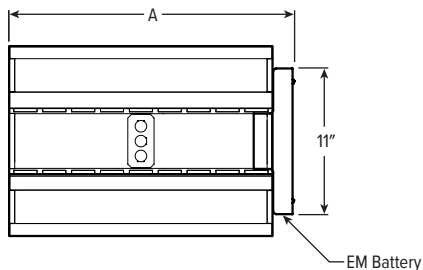

EM/20W

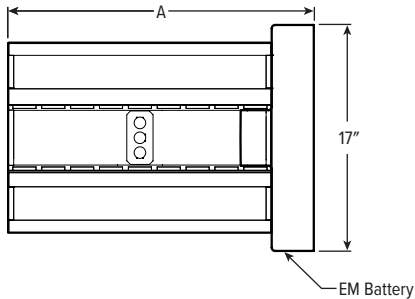

A (FIXTURE LENGTH WITH EM)		
	EM/10W	EM/20W
2'	21-9/16"	23-1/8"
4'	41-13/16"	43-1/2"

POWER ENTRY

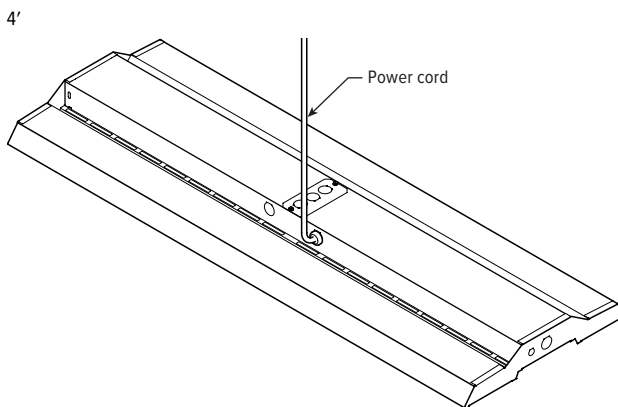
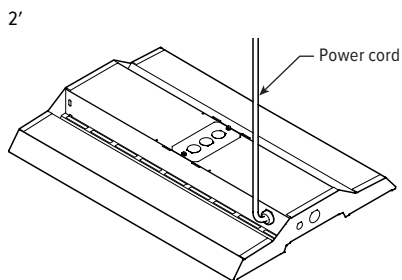

SENSOR PLACEMENT DETAILS

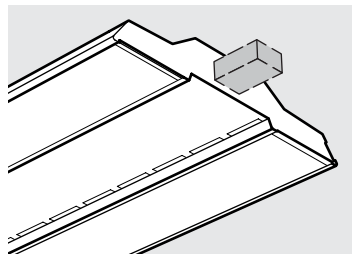

SEE NEXT PAGE FOR CONTROL DETAILS.

AVI-ON BLUETOOTH WIRELESS CONTROL DETAILS

AVI-ON NETWORK FEATURES

Simple

- Gateway-free distributed control
- Factory pre-commissioning
- Contractor friendly installation
- Occupancy/vacancy/daylight sensing

Scalable

- Virtually unlimited network size
- Spans small areas to large warehouses
- Flexible control strategies

Secure

- Optional cloud connectivity
- UL IoT platinum security rating
- DLC 5.0 compliant

DIGITAL INSTALLATION TOOLS

Avi-On mobile apps provide intuitive, quick installation and commissioning. Pro tools are available to qualified installers.



Commissioning Mobile App



Zone Scanner Web App



Commissioning Pro App

SYSTEM COMPONENTS

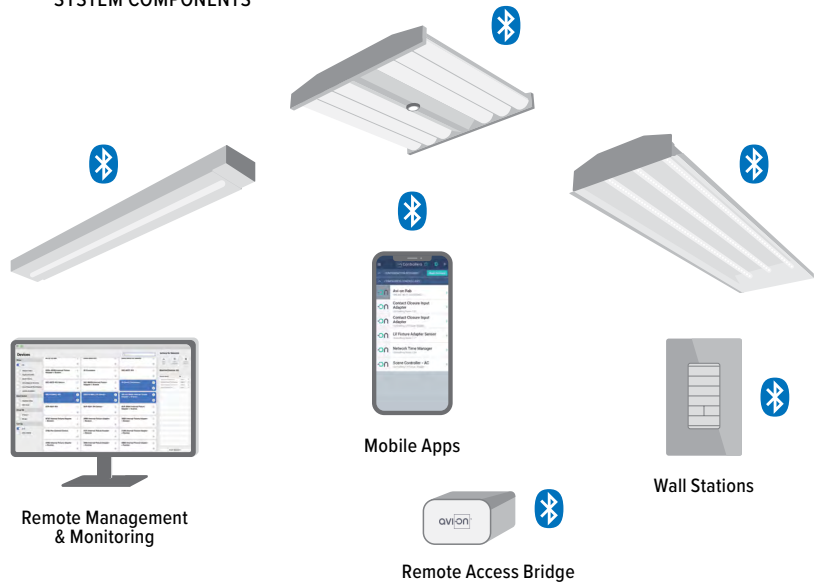

The Bluetooth® word mark and logos are registered trademarks owned by Bluetooth SIG, Inc. and any use of such marks by Avi-On is under license. Other trademarks and trade names are those of their respective owners.

ACCESSORIES

WALL STATIONS	
AVI-2401AC	Scene controller - numbered 1-4, 120-277VAC
AVI-2402BAT	Scene controller - numbered 1-4, battery powered
AVI-2401AC-2	Dimmer with presets - percentages, 120-277VAC
AVI-2402BAT-2	Dimmer with presets - percentages, battery powered
AVI-2401AC-3	On/off/dimming, 120-277VAC
AVI-2402BAT-3	On/off/dimming, battery powered
CONNECTIVITY	
AVI-2001RAB-01-P	Remote access bridge for projects 100 or greater
AVI-2001RAB-01-C	Remote access bridge for projects less than 100
AVI-KIT-NTM	Network time manager with Battery Backup
CEILING MOUNT SENSORS	
AVI-KIT-SEN-DUCM	PIR motion and ultrasonic sensor kit
AVI-KIT-SEN-ICM	PIR motion and photocell sensor kit

For load controllers and additional accessory info, see hew.com/avi-on

AVI-LVFA-PIR-ELB Avi-on wireless fixture control with PIR motion and daylight sensor, end mount. DA Driver only.

SPECIFICATIONS	
TYPE	PIR Motion + Daylight
MOUNTING HEIGHT	8' – 45'
LENS	Single lens detects high and low bay motion.
DETECTION ANGLE	360°
TEMPERATURE RANGE	-30° to 70°C
RELATIVE HUMIDITY	90 to 95% at 30°C
COMMISSIONING	App (iOS or Android)
SYSTEM REQUIREMENTS	Avi-On wireless fixture controls plus desktop and mobile apps
MANUFACTURER	Avi-On



SENSOR COVERAGE PATTERNS

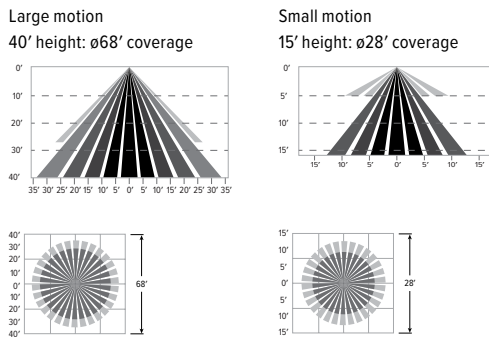

SENSOR DETAIL



ADDITIONAL CONTROL OPTIONS

WS-FSP-321B-L_-120-480 Wattstopper PIR motion and daylight sensor using 0-10V internal control, 120V-480V. Must specify lens: L2, L3 or L7. Factory installed.

SPECIFICATIONS	
TYPE	PIR Motion + Daylight
MOUNTING HEIGHT	8' – 40'
DETECTION ANGLE	360°
TEMPERATURE RANGE	-40° to 75°C
COMMISSIONING	App (iOS or Android)

SENSOR COVERAGE PATTERNS

L2 8' height: ø48' coverage

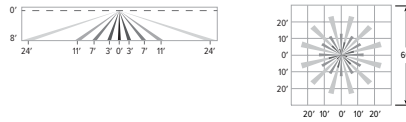

L3 20' height: ø40' coverage

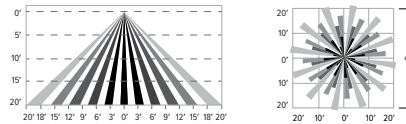

L7 40' height: ø100' coverage

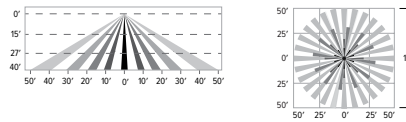

SENSOR DETAIL



WS-HBP-111-L7-120/277/347 Wattstopper PIR motion and daylight hold off sensor, 120/277/347V. Adjustable via remote. Optional FSIR-100 remote controller available.

FSIR-100 Remote controller for HBP-111 sensor. Please specify quantity required per project. Ordered and shipped separately.

SPECIFICATIONS	
TYPE	PIR Motion + Daylight Hold Off
MOUNTING HEIGHT	15' – 40'
DETECTION ANGLE	360°
TEMPERATURE RANGE	0° to 70°C
RELATIVE HUMIDITY	5 to 95%, non-condensing
COMMISSIONING	FSIR-100 Remote

SENSOR COVERAGE PATTERNS

40' height: ø100' coverage

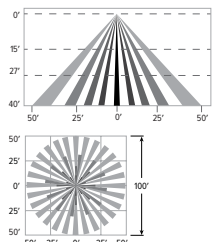

With mask: 40' height: ø50' coverage

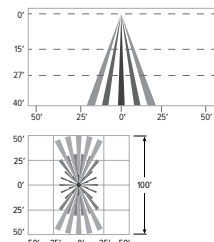

SENSOR DETAIL



LV-OSFHU-ITW-120-347 Leviton PIR motion sensor, 120-347V

LV-OSFHU-I4W-208/240/480V Leviton PIR motion sensor, 208/240/480V

SPECIFICATIONS	
TYPE	PIR Motion
MOUNTING HEIGHT	8' – 40'
LENS	Interchangeable high bay, low bay or aisle mask
DETECTION ANGLE	360°
TEMPERATURE RANGE	-10° to 71°C
RELATIVE HUMIDITY	20% to 90% non-condensing

SENSOR COVERAGE PATTERNS

**High bay
40' height: ø60' coverage**

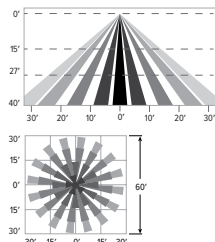

**Low bay
25' height: ø60' coverage**

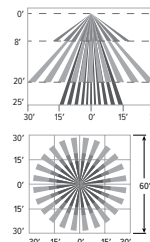

SENSOR DETAIL

