

HM4DR LED 4.5" Cleanroom Medical Downlight – Round

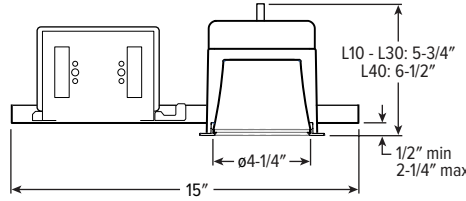
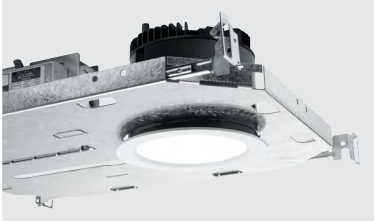

CATALOG #: _____

TYPE: _____

PROJECT: _____

FEATURES

TrimLock®

- Innovative TrimLock reflector retention system ensures trim remains flush with ceiling plane
- Designed to meet the demanding requirements of controlled environments
- Smooth surface trim and lens materials simplify cleaning and maintenance
- NSF-approved gasketing meets all required testing criteria for ISO 5, Class 100 certification
- Anti-microbial white finish is standard

SPECIFICATIONS

- HOUSING** – Die-cast aluminum trim housing with forged aluminum heat sink. Galvanized steel splice compartment with driver mounting plate/enclosure. Swing-out mounting arms field adjust for ceiling thickness from 1/2" – 2-1/4".
- TRIM** – Die-cast aluminum frame with micro-prismatic, acrylic lens.
- DIE-CAST FINISH** – Textured anti-microbial matte white or black polyester TGIC powder coat bonded to phosphate-free, multi-stage pretreated metal.
- ELECTRICAL** – High-performance Class 2 C.O.B. LED array. Modular quick-connect plug for easy field-connection of LED light assembly to driver. Reported L70>55,000 hours. Reported L90>55,000 hours. Estimated L70 = 200,000 hours.
- MOUNTING** – Recessed. 20 ga. galvanized steel mounting pan. Minimum 24" O.C. marked spacing required for L30 and L40 lumen packages.
- LISTINGS** –
 - cCSAus conforms to UL STD 1598; Certified to CAN/CSA STD C22.2 No. 250.0 for wet locations under covered ceiling. LED light assembly conforms to UL 2108 for remote installation.
 - IC-rated for direct contact with insulation when specified with I Mounting Type.
 - IP65 rated
 - ISO 5, Class 100 rated
 - NSF/ANSI 2
 - City of Chicago Environmental Air approved when specified with CP option.^[19]
 - Complies with ASTM-E283 when specified with ATH option.
 - RoHS compliant.
- WARRANTY** – 5-year limited warranty, see hew.com/warranty.

ORDERING EXAMPLE: **HM4DR - TL - L20/835 - OPTIONS - DIM - UNV - LW - OF - WH - TRIM OPTIONS - N - F1**

HOUSING

SERIES	LUMENS ^[1]	CRI	CCT	OPTIONS	CONTROL ^[2]	VOLTAGE
HM4DR - TL	L10 1,000lm	8 80	27 2700K	ATH Airtight construction	DIM Dimming driver, 0-10V	UNV 120-277V
TrimLock	L15 1,500lm	9 90 ^[3]	30 3000K	F Fuse	DIM1 1% Dimming driver, 0-10V	
	L20 2,000lm		35 3500K	EM/7W 7-watt emergency battery ^[4]		
	L30 3,000lm		40 4000K	EM/10W 10-watt emergency battery ^[5]		
	L40 4,000lm		50 5000K	CP Chicago plenum (CCEA) ^[6]		

TRIM

TRIM TYPE	DISTRIBUTION ^[7]	FLANGE TYPE	REFLECTOR FINISH	TRIM OPTIONS
L Flush lens	W Wide	OF 1/2" standard flange	WH White texture powder coat	AD Diffuse acrylic lens ^[11]
R Regressed lens	50° Flush		BL Black texture powder coat	PD Diffuse 1/8" polycarbonate lens ^[12]
	50° Regressed		MB Black texture splay with white flange ^[10]	
	M Medium ^[8]			
	35° Flush			
	30° Regressed			
	N Narrow ^[9]			
	25° Flush			
	25° Regressed			

MOUNTING

MOUNTING TYPE ^[13]

- N Open pan for new construction
- I IC-rated enclosure for new construction ^[15]

MOUNTING HARDWARE ^[14]

- F1 Integral 2-position fixed pan bracket, universal bar hanger included ^[16]
- BA1 Adjustable butterfly pan bracket, bar hanger not included ^[17]
- CA1 Adjustable caterpillar pan bracket, universal bar hanger included ^[18]

NOTES

- Lumen output based on L trim type, W distribution and WH finish, 3500K/80CRI. Actual lumens may vary +/-5%, see page 2 for FIXTURE PERFORMANCE DATA.
- See page 3 for ADDITIONAL CONTROL OPTIONS.
- Extended lead times may apply. Consult factory for availability.
- N Mounting Type only. Not available with ATH. Not IP65 rated.
- N Mounting Type only. Not available with ATH. Not IP65 rated.
- I Mounting Type required. Not NSF approved.
- Beam angle based on WH reflector finish.
- L30 lumen package max when specified with medium or narrow distribution.
- L30 lumen package max when specified with medium or narrow distribution.

- R Trim Type only.
- W distribution only. Includes smooth clear polycarbonate underlay.
- W distribution only. Includes smooth clear polycarbonate underlay.
- Mounting hardware required, ordered separately, see MOUNTING HARDWARE ordering info. See page 4 for MOUNTING TYPE DETAILS.
- Additional mounting hardware options available. See page 4 for MOUNTING HARDWARE DETAILS.
- L15 lumen package max. L20 available, wide distribution only.
- I Mounting requires external brackets.
- N Mounting Type only.
- N Mounting Type only.
- Not NSF approved.



HM4DR^{LED} 4.5" Cleanroom Medical Downlight – Round

FIXTURE PERFORMANCE DATA

	DISTRIBUTION	WATTAGE	FLUSH LENS TRIM TYPE		REGRESSED LENS TRIM TYPE	
			DELIVERED LUMENS	EFFICACY (lm/W)	DELIVERED LUMENS	EFFICACY (lm/W)
L10	W	14.5	992	68.4	972	67.0
	M	14.5	1317	90.8	1319	91.0
	N	14.5	1345	92.8	1299	89.6
L15	W	22.1	1472	66.6	1441	65.2
	M	22.1	1953	88.4	1955	88.5
	N	22.1	1995	90.3	1927	87.2
L20	W	26.9	1967	73.1	1927	71.6
	M	26.9	2610	97.0	2614	97.2
	N	26.9	2667	99.1	2576	95.8
L30	W	41.4	2813	67.9	2755	66.5
	M	41.4	3732	90.1	3738	90.3
	N	41.4	3813	92.1	3683	89.0
L40	W	55.4	3890	70.2	3810	68.8
	M	—	—	—	—	—
	N	—	—	—	—	—

MULTIPLIER TABLES

	COLOR TEMPERATURE	
	CCT	CONVERSION FACTOR
80 CRI	2700K	0.92
	3000K	0.98
	3500K	1.00
	4000K	1.01
	5000K	1.02
90 CRI	2700K	0.76
	3000K	0.79
	3500K	0.82
	4000K	0.84
	5000K	0.88

TRIM	
CATALOG NUMBER	CONVERSION FACTOR
AD	0.77
PD	0.77

REGRESSED TRIM FINISH	
CATALOG NUMBER	CONVERSION FACTOR
WH	1.00
BL	0.79

- Photometrics tested in accordance with IESNA LM-79. Results shown are based on 25°C ambient temperature.
- Wattage shown is based on 120V input.
- Results based on 3500K, 80 CRI, actual lumens may vary +/-5%
- Use multiplier tables to calculate additional options.

PHOTOMETRY

HM4DR-TL-L40/835-DIM-UNV-LW-OF-WH Total Luminaire Output: 3889 lumens; 55.4 Watts | Efficacy: 70 lm/W | 80 CRI; 3500K CCT

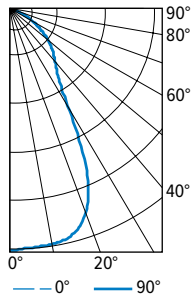

CANDLEPOWER DISTRIBUTION	VERTICAL ANGLE	HORIZONTAL ANGLE	ZONAL LUMENS
		0°	
	0	2732	
	5	2713	259
	15	2661	745
	25	2076	921
	35	967	628
	45	695	535
	55	463	414
	65	250	250
	75	106	114
	85	19	24
	90	1	

LUMEN SUMMARY	ZONE	LUMENS	% FIXTURE
	0 - 30	1925	50
	0 - 40	2552	66
	0 - 60	3501	90
	0 - 90	3889	100
	0 - 180	3889	100

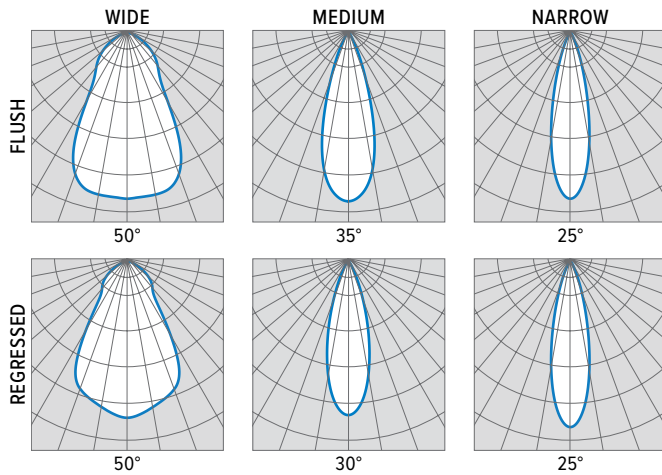

HM4DR^{LED} 4.5" Cleanroom Medical Downlight – Round

ADDITIONAL CONTROL OPTIONS

Lumen restrictions apply: L15 minimum for DIM LINE driver. I Mounting Type not available with Lutron controls.

CATALOG NUMBER	DESCRIPTION
DIM	Dimming driver prewired for 0-10V low voltage applications
DIM1	1% dimming driver prewired for 0-10V low voltage applications
DIM LINE	Line voltage dimming driver (TRIAC and ELV compatible at 120V only)
DMX	0.1% dimming driver for DMX controls
LDE1	Lutron Hi-lume 1% EcoSystem dimming LED driver
VRF/DBI/LDE1	Lutron Vive integral fixture control, RF only (DFCSJ-OEM-RF), Lutron Hi-lume 1% EcoSystem dimming LED driver, and digital link interface
FCJS/DIM	Lutron Vive PowPak wireless fixture control with dimming driver
FCJS/DIM1	Lutron Vive PowPak wireless fixture control with 1% dimming driver

TRIMLOCK DETAILS

TWIST



PULL



RELEASE



TRIM TYPE DETAILS

FLUSH

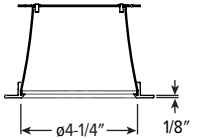

REGRESSED

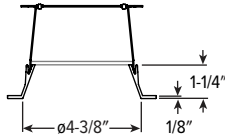

FLANGE TYPE DETAILS

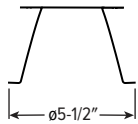

Ceiling Cutout: $\phi 5"$

REFLECTOR FINISH DETAILS

WH

White

BL

Black

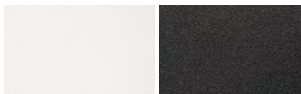

HM4DR^{LED} 4.5" Clearroom Medical Downlight – Round

MOUNTING TYPE DETAILS

NEW CONSTRUCTION

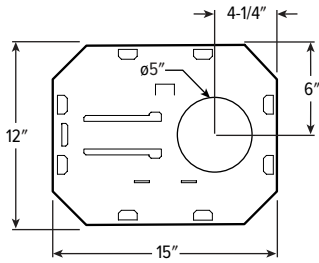

IC-RATED

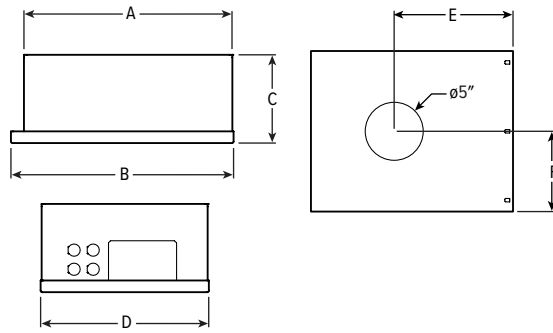

LUMENS	LENGTH					
	A	B	C	D	E	F
L10 - L15	15-3/16"	16"	6-3/8"	12-1/8"	9-1/2"	6-1/16"
L20	16-5/8"	17-1/2"	7-7/8"	14"	10-1/4"	7"

MOUNTING HARDWARE DETAILS

F1 Integral 2-position fixed pan bracket, universal bar hanger included

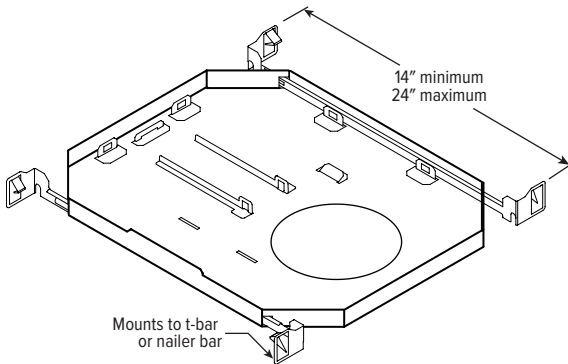

BA1 Adjustable butterfly pan bracket, bar hanger not included (N Mounting Type only)

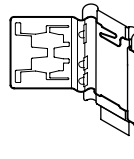

CA1 Adjustable caterpillar pan bracket, universal bar hanger included (N Mounting Type only)

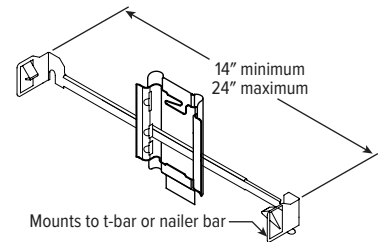

BA2 Adjustable butterfly pan bracket, heavy-duty universal bar hanger included (N Mounting Type only)

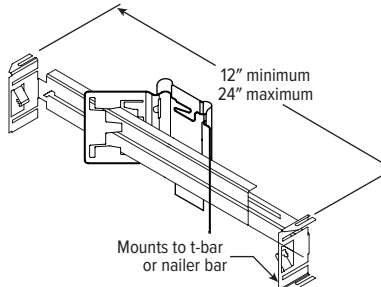

CA2 Adjustable caterpillar pan bracket, t-bar hanger included (N Mounting Type only)

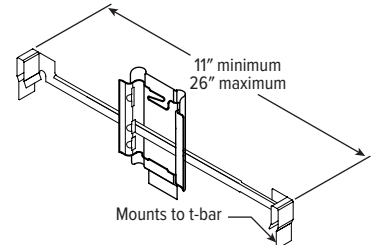

F1 with I Mounting Type

